

# STA CATEGORY

BT / STA SYNCHRONIZED TAPPING HOLDER	Q-2~5
CAT / STA SYNCHRONIZED TAPPING HOLDER	Q-6~8
DAT / STA SYNCHRONIZED TAPPING HOLDER	Q-9~11
SBT / STA SYNCHRONIZED TAPPING HOLDER	Q-12~15
SCAT / STA SYNCHRONIZED TAPPING HOLDER	Q-16~18
SDAT / STA SYNCHRONIZED TAPPING HOLDER	Q-19~21
HSK / STA SYNCHRONIZED TAPPING HOLDER	Q-22~25
PSC / STA SYNCHRONIZED TAPPING HOLDER	Q-26~29
STRAIGHT SHANK STA SYNCHRONIZED TAPPING HOLDER	Q-30~33
STA SYNCHRONIZED TAPPING HOLDER BODY	Q-34~36
TAP ADAPTER FOR STA	Q-37~39

# BT / STA SYNCHRONIZED TAPPING HOLDER



## BT / STA 同步補償攻牙刀桿

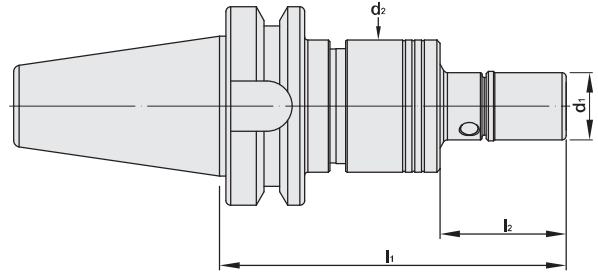

T W PAT NO. M520427  
J P PAT NO. 3203456  
D E PAT NO. Nr.202016100106

MODEL NO.	TYPE	l <sub>1</sub>	l <sub>2</sub>	d <sub>1</sub>	d <sub>2</sub>	COMBINATION		WEIGHT (KGS)
						BODY	TAP ADAPTER	
10.795.08T.090	BT30 x STA8T - 90	90	30	12	42	BT30 x STA1	STA1 - PTER8 - 30	0.68
10.795.08T.130	BT30 x STA8T - 130	130	70	12	42	BT30 x STA1	STA1 - PTER8 - 70	0.74
10.795.08T.160	BT30 x STA8T - 160	160	100	12	42	BT30 x STA1	STA1 - PTER8 - 100	0.79
10.795.11T.090	BT30 x STA11T - 90	90	30	16	42	BT30 x STA1	STA1 - PTER11 - 30	1.13
10.795.11T.130	BT30 x STA11T - 130	130	70	16	42	BT30 x STA1	STA1 - PTER11 - 70	1.19
10.795.11T.160	BT30 x STA11T - 160	160	100	16	42	BT30 x STA1	STA1 - PTER11 - 100	1.23
10.795.16T.090	BT30 x STA16T - 90	90	30	22	42	BT30 x STA1	STA1 - PTER16 - 30	1.14
10.795.16T.130	BT30 x STA16T - 130	130	70	22	42	BT30 x STA1	STA1 - PTER16 - 70	1.20
10.795.16T.160	BT30 x STA16T - 160	160	100	22	42	BT30 x STA1	STA1 - PTER16 - 100	1.24
10.795.20T.090	BT30 x STA20T - 90	90	30	28	42	BT30 x STA1	STA1 - PTER20 - 30	1.11
10.795.20T.130	BT30 x STA20T - 130	130	70	28	42	BT30 x STA1	STA1 - PTER20 - 70	1.38
10.795.20T.160	BT30 x STA20T - 160	160	100	28	42	BT30 x STA1	STA1 - PTER20 - 100	1.54
11.795.08T.100	BT40 x STA8T - 100	100	30	12	42	BT40 x STA1	STA1 - PTER8 - 30	1.30
11.795.08T.140	BT40 x STA8T - 140	140	70	12	42	BT40 x STA1	STA1 - PTER8 - 70	1.36
11.795.08T.170	BT40 x STA8T - 170	170	100	12	42	BT40 x STA1	STA1 - PTER8 - 100	1.41
11.795.11T.100	BT40 x STA11T - 100	100	30	16	42	BT40 x STA1	STA1 - PTER11 - 30	1.75
11.795.11T.140	BT40 x STA11T - 140	140	70	16	42	BT40 x STA1	STA1 - PTER11 - 70	1.81
11.795.11T.170	BT40 x STA11T - 170	170	100	16	42	BT40 x STA1	STA1 - PTER11 - 100	1.85
11.795.16T.100	BT40 x STA16T - 100	100	30	22	42	BT40 x STA1	STA1 - PTER16 - 30	1.76
11.795.16T.140	BT40 x STA16T - 140	140	70	22	42	BT40 x STA1	STA1 - PTER16 - 70	1.82
11.795.16T.170	BT40 x STA16T - 170	170	100	22	42	BT40 x STA1	STA1 - PTER16 - 100	1.86
11.795.20T.100	BT40 x STA20T - 100	100	30	28	42	BT40 x STA1	STA1 - PTER20 - 30	1.73
11.795.20T.140	BT40 x STA20T - 140	140	70	28	42	BT40 x STA1	STA1 - PTER20 - 70	2.00
11.795.20T.170	BT40 x STA20T - 170	170	100	28	42	BT40 x STA1	STA1 - PTER20 - 100	2.16
11.795.25T.115	BT40 x STA25T - 115	115	30	35	58	BT40 x STA2	STA2 - PTER25 - 30	2.03
11.795.25T.155	BT40 x STA25T - 155	155	70	35	58	BT40 x STA2	STA2 - PTER25 - 70	2.30
11.795.25T.185	BT40 x STA25T - 185	185	100	35	58	BT40 x STA2	STA2 - PTER25 - 100	2.46

### Product information:

- ▶ AD+B type is available, please inform us when making an order.
- ▶ MAS/BT30 tool holders are without coolant supply over collars.

### Standard Accessory: • NUT

Collet	Nut	Pull Stud	Spanner
P.W-4	P.W-41	P.W-54~55	P.W-62~67

# BT / STA SYNCHRONIZED TAPPING HOLDER



BT / STA 同步補償攻牙刀桿

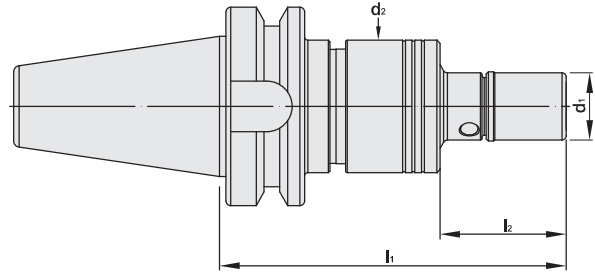

T W PAT NO. M520427  
 J P PAT NO. 3203456  
 D E PAT NO. Nr.202016100106

MODEL NO.	TYPE	l <sub>1</sub>	l <sub>2</sub>	d <sub>1</sub>	d <sub>2</sub>	COMBINATION		WEIGHT (KGS)
						BODY	TAP ADAPTER	
12.795.08T.090	BT50 x STA8T - 90	90	30	12	42	BT50 x STA1	STA1 - PTER8 - 30	3.80
12.795.08T.130	BT50 x STA8T - 130	130	70	12	42	BT50 x STA1	STA1 - PTER8 - 70	3.86
12.795.08T.160	BT50 x STA8T - 160	160	100	12	42	BT50 x STA1	STA1 - PTER8 - 100	3.91
12.795.11T.090	BT50 x STA11T - 90	90	30	16	42	BT50 x STA1	STA1 - PTER11 - 30	4.25
12.795.11T.130	BT50 x STA11T - 130	130	70	16	42	BT50 x STA1	STA1 - PTER11 - 70	4.31
12.795.11T.160	BT50 x STA11T - 160	160	100	16	42	BT50 x STA1	STA1 - PTER11 - 100	4.35
12.795.16T.090	BT50 x STA16T - 90	90	30	22	42	BT50 x STA1	STA1 - PTER16 - 30	4.26
12.795.16T.130	BT50 x STA16T - 130	130	70	22	42	BT50 x STA1	STA1 - PTER16 - 70	4.32
12.795.16T.160	BT50 x STA16T - 160	160	100	22	42	BT50 x STA1	STA1 - PTER16 - 100	4.36
12.795.20T.090	BT50 x STA20T - 90	90	30	28	42	BT50 x STA1	STA1 - PTER20 - 30	4.23
12.795.20T.130	BT50 x STA20T - 130	130	70	28	42	BT50 x STA1	STA1 - PTER20 - 70	4.50
12.795.20T.160	BT50 x STA20T - 160	160	100	28	42	BT50 x STA1	STA1 - PTER20 - 100	4.66
12.795.25T.125	BT50 x STA25T - 125	125	30	35	58	BT50 x STA2	STA2 - PTER25 - 30	4.53
12.795.25T.165	BT50 x STA25T - 165	165	70	35	58	BT50 x STA2	STA2 - PTER25 - 70	4.80
12.795.25T.195	BT50 x STA25T - 195	195	100	35	58	BT50 x STA2	STA2 - PTER25 - 100	4.96

**Product information:**

► AD+B type is available, please inform us when making an order.

**Standard Accessory: • NUT**

Collet	Nut	Pull Stud	Spanner
P.W-4	P.W-41	P.W-54~55	P.W-62~67



# BT / STA SYNCHRONIZED TAPPING HOLDER



## BT / STA 同步補償攻牙刀桿

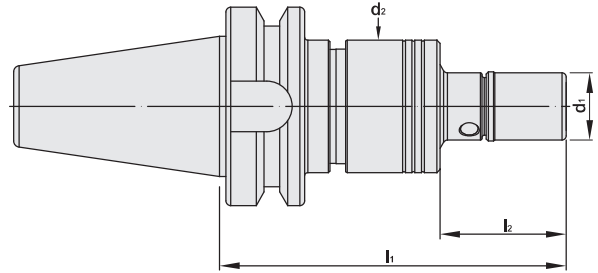

T W PAT NO. M520427  
J P PAT NO. 3203456  
D E PAT NO. Nr.202016100106

MODEL NO.	TYPE	l <sub>1</sub>	l <sub>2</sub>	d <sub>1</sub>	d <sub>2</sub>	COMBINATION		WEIGHT (KGS)
						BODY	TAP ADAPTER	
10.795.16U.090	BT30 x STA16U - 90	90	30	30	42	BT30 x STA1	STA1 - UT16 - 30	0.71
10.795.16U.130	BT30 x STA16U - 130	130	70	30	42	BT30 x STA1	STA1 - UT16 - 70	0.86
10.795.16U.160	BT30 x STA16U - 160	160	100	30	42	BT30 x STA1	STA1 - UT16 - 100	1.06
11.795.16U.100	BT40 x STA16U - 100	100	30	30	42	BT40 x STA1	STA1 - UT16 - 30	1.33
11.795.16U.140	BT40 x STA16U - 140	140	70	30	42	BT40 x STA1	STA1 - UT16 - 70	1.48
11.795.16U.170	BT40 x STA16U - 170	170	100	30	42	BT40 x STA1	STA1 - UT16 - 100	1.68
11.795.20U.115	BT40 x STA20U - 115	115	30	36	58	BT40 x STA2	STA2 - UT20 - 30	1.78
11.795.20U.155	BT40 x STA20U - 155	155	70	36	58	BT40 x STA2	STA2 - UT20 - 70	1.98
11.795.20U.185	BT40 x STA20U - 185	185	100	36	58	BT40 x STA2	STA2 - UT20 - 100	2.11
11.795.25U.120	BT40 x STA25U - 120	120	35	42	58	BT40 x STA2	STA2 - UT25 - 35	1.78
11.795.25U.170	BT40 x STA25U - 170	170	85	42	58	BT40 x STA2	STA2 - UT25 - 85	2.13
11.795.25U.200	BT40 x STA25U - 200	200	115	42	58	BT40 x STA2	STA2 - UT25 - 115	2.38
11.795.32U.135	BT40 x STA32U - 135	135	50	48	58	BT40 x STA2	STA2 - UT32 - 50	1.83
11.795.32U.170	BT40 x STA32U - 170	170	85	48	58	BT40 x STA2	STA2 - UT32 - 85	2.08
11.795.32U.200	BT40 x STA32U - 200	200	115	48	58	BT40 x STA2	STA2 - UT32 - 115	2.28
12.795.16U.090	BT50 x STA16U - 90	90	30	30	42	BT50 x STA1	STA1 - UT16 - 30	3.83
12.795.16U.130	BT50 x STA16U - 130	130	70	30	42	BT50 x STA1	STA1 - UT16 - 70	3.98
12.795.16U.160	BT50 x STA16U - 160	160	100	30	42	BT50 x STA1	STA1 - UT16 - 100	4.18
12.795.20U.125	BT50 x STA20U - 125	125	30	36	58	BT50 x STA2	STA2 - UT20 - 30	4.28
12.795.20U.165	BT50 x STA20U - 165	165	70	36	58	BT50 x STA2	STA2 - UT20 - 70	4.48
12.795.20U.195	BT50 x STA20U - 195	195	100	36	58	BT50 x STA2	STA2 - UT20 - 100	4.61
12.795.25U.130	BT50 x STA25U - 130	130	35	42	58	BT50 x STA2	STA2 - UT25 - 35	4.28
12.795.25U.180	BT50 x STA25U - 180	180	85	42	58	BT50 x STA2	STA2 - UT25 - 85	4.63
12.795.25U.210	BT50 x STA25U - 210	210	115	42	58	BT50 x STA2	STA2 - UT25 - 115	4.88
12.795.32U.145	BT50 x STA32U - 145	145	50	48	58	BT50 x STA2	STA2 - UT32 - 50	4.33
12.795.32U.180	BT50 x STA32U - 180	180	85	48	58	BT50 x STA2	STA2 - UT32 - 85	4.58
12.795.32U.210	BT50 x STA32U - 210	210	115	48	58	BT50 x STA2	STA2 - UT32 - 115	4.78

### Product information:

- ▶ AD+B type is available, please inform us when making an order.
- ▶ MAS/BT30 tool holders are without coolant supply over collars.

### Standard Accessory: • NUT

Collet	Nut	Pull Stud	Spanner
P.W-6~9	P.W-41	P.W-54~55	P.W-62~67

# BT / STA SYNCHRONIZED TAPPING HOLDER



BT / STA 同步補償攻牙刀桿

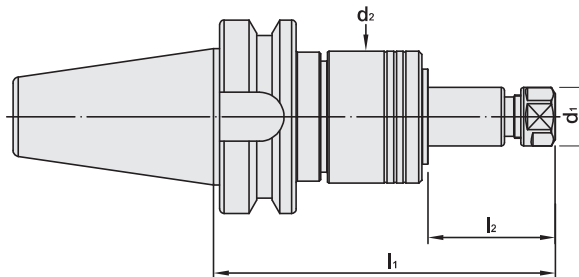

T W PAT NO. M520427  
J P PAT NO. 3203456  
D E PAT NO. Nr.202016100106

MODEL NO.	TYPE	l <sub>1</sub>	l <sub>2</sub>	d <sub>1</sub>	d <sub>2</sub>	COMBINATION		WEIGHT (KGS)
						BODY	TAP ADAPTER	
10.795.11E.130	BT30 x STA11E - 130	130	70	19	42	BT30 x STA1	STA1 - ER11A - 70	0.92
10.795.16E.085	BT30 x STA16E - 85	85	25	28	42	BT30 x STA1	STA1 - ER16A - 25	0.66
10.795.16E.130	BT30 x STA16E - 130	130	70	28	42	BT30 x STA1	STA1 - ER16A - 70	0.86
10.795.16E.210	BT30 x STA16E - 210	210	150	28	42	BT30 x STA1	STA1 - ER16A - 150	1.19
10.795.20E.094	BT30 x STA20E - 94	94	34	34	42	BT30 x STA1	STA1 - ER20A - 34	0.70
10.795.20E.130	BT30 x STA20E - 130	130	70	34	42	BT30 x STA1	STA1 - ER20A - 70	0.86
11.795.11E.140	BT40 x STA11E - 140	140	70	19	42	BT40 x STA1	STA1 - ER11A - 70	1.54
11.795.16E.095	BT40 x STA16E - 95	95	25	28	42	BT40 x STA1	STA1 - ER16A - 25	1.28
11.795.16E.140	BT40 x STA16E - 140	140	70	28	42	BT40 x STA1	STA1 - ER16A - 70	1.48
11.795.16E.220	BT40 x STA16E - 220	220	150	28	42	BT40 x STA1	STA1 - ER16A - 150	1.81
11.795.20E.104	BT40 x STA20E - 104	104	34	34	42	BT40 x STA1	STA1 - ER20A - 34	1.32
11.795.20E.140	BT40 x STA20E - 140	140	70	34	42	BT40 x STA1	STA1 - ER20A - 70	1.48
11.795.32E.125	BT40 x STA32E - 125	125	40	50	58	BT40 x STA2	STA2 - ER32 - 40	1.92
11.795.32E.155	BT40 x STA32E - 155	155	70	50	58	BT40 x STA2	STA2 - ER32 - 70	2.15
12.795.11E.130	BT50 x STA11E - 130	130	70	19	42	BT40 x STA1	STA1 - ER11A - 70	1.54
12.795.16E.085	BT50 x STA16E - 85	85	25	28	42	BT50 x STA1	STA1 - ER16A - 25	3.78
12.795.16E.130	BT50 x STA16E - 130	130	70	28	42	BT50 x STA1	STA1 - ER16A - 70	3.98
12.795.16E.210	BT50 x STA16E - 210	210	150	28	42	BT50 x STA1	STA1 - ER16A - 150	4.31
12.795.20E.094	BT50 x STA20E - 94	94	34	34	42	BT50 x STA1	STA1 - ER20A - 34	3.82
12.795.20E.140	BT50 x STA20E - 140	140	70	34	42	BT50 x STA1	STA1 - ER20A - 70	3.98
12.795.32E.135	BT50 x STA32E - 135	135	40	50	58	BT50 x STA2	STA2 - ER32 - 40	4.42
12.795.32E.165	BT50 x STA32E - 165	165	70	50	58	BT50 x STA2	STA2 - ER32 - 70	4.65

**Product information:**

- ▶ AD+B type is available, please inform us when making an order.
- ▶ MAS/BT30 tool holders are without coolant supply over collars.

**Standard Accessory: • NUT**

Collet	Nut	Pull Stud	Spanner
P.W-6~24	P.W-42	P.W-54~55	P.W-62~65



# CAT / STA SYNCHRONIZED TAPPING HOLDER



## CAT / STA 同步補償攻牙刀桿

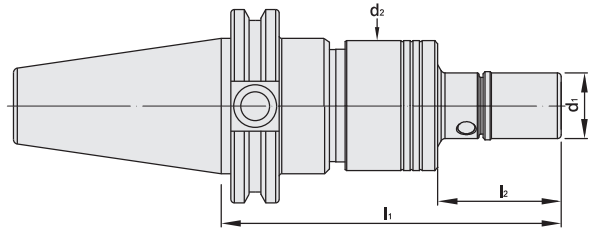

T W PAT NO. M520427  
J P PAT NO. 3203456  
D E PAT NO. Nr.202016100106

MODEL NO.	TYPE	l <sub>1</sub>	l <sub>2</sub>	d <sub>1</sub>	d <sub>2</sub>	COMBINATION		WEIGHT (KGS)
						BODY	TAP ADAPTER	
31.795.08T.100	CAT40 x STA8T - 100	100	30	12	42	CAT40 x STA1	STA1 - PTER8 - 30	1.24
31.795.08T.140	CAT40 x STA8T - 140	140	70	12	42	CAT40 x STA1	STA1 - PTER8 - 70	1.30
31.795.08T.170	CAT40 x STA8T - 170	170	100	12	42	CAT40 x STA1	STA1 - PTER8 - 100	1.35
31.795.11T.100	CAT40 x STA11T - 100	100	30	16	42	CAT40 x STA1	STA1 - PTER11 - 30	1.69
31.795.11T.140	CAT40 x STA11T - 140	140	70	16	42	CAT40 x STA1	STA1 - PTER11 - 70	1.75
31.795.11T.170	CAT40 x STA11T - 170	170	100	16	42	CAT40 x STA1	STA1 - PTER11 - 100	1.79
31.795.16T.100	CAT40 x STA16T - 100	100	30	22	42	CAT40 x STA1	STA1 - PTER16 - 30	1.70
31.795.16T.140	CAT40 x STA16T - 140	140	70	22	42	CAT40 x STA1	STA1 - PTER16 - 70	1.76
31.795.16T.170	CAT40 x STA16T - 170	170	100	22	42	CAT40 x STA1	STA1 - PTER16 - 100	1.80
31.795.20T.100	CAT40 x STA20T - 100	100	30	28	42	CAT40 x STA1	STA1 - PTER20 - 30	1.67
31.795.20T.140	CAT40 x STA20T - 140	140	70	28	42	CAT40 x STA1	STA1 - PTER20 - 70	1.94
31.795.20T.170	CAT40 x STA20T - 170	170	100	28	42	CAT40 x STA1	STA1 - PTER20 - 100	2.10
31.795.25T.120	CAT40 x STA25T - 120	120	30	35	58	CAT40 x STA2	STA2 - PTER25 - 30	2.00
31.795.25T.160	CAT40 x STA25T - 160	160	70	35	58	CAT40 x STA2	STA2 - PTER25 - 70	2.27
31.795.25T.190	CAT40 x STA25T - 190	190	100	35	58	CAT40 x STA2	STA2 - PTER25 - 100	2.43
32.795.08T.100	CAT50 x STA8T - 100	100	30	12	42	CAT50 x STA1	STA1 - PTER8 - 30	3.24
32.795.08T.140	CAT50 x STA8T - 140	140	70	12	42	CAT50 x STA1	STA1 - PTER8 - 70	3.30
32.795.08T.170	CAT50 x STA8T - 170	170	100	12	42	CAT50 x STA1	STA1 - PTER8 - 100	3.35
32.795.11T.100	CAT50 x STA11T - 100	100	30	16	42	CAT50 x STA1	STA1 - PTER11 - 30	3.69
32.795.11T.140	CAT50 x STA11T - 140	140	70	16	42	CAT50 x STA1	STA1 - PTER11 - 70	3.75
32.795.11T.170	CAT50 x STA11T - 170	170	100	16	42	CAT50 x STA1	STA1 - PTER11 - 100	3.79
32.795.16T.100	CAT50 x STA16T - 100	100	30	22	42	CAT50 x STA1	STA1 - PTER16 - 30	3.70
32.795.16T.140	CAT50 x STA16T - 140	140	70	22	42	CAT50 x STA1	STA1 - PTER16 - 70	3.76
32.795.16T.170	CAT50 x STA16T - 170	170	100	22	42	CAT50 x STA1	STA1 - PTER16 - 100	3.80
32.795.20T.100	CAT50 x STA20T - 100	100	30	28	42	CAT50 x STA1	STA1 - PTER20 - 30	3.67
32.795.20T.140	CAT50 x STA20T - 140	140	70	28	42	CAT50 x STA1	STA1 - PTER20 - 70	3.94
32.795.20T.170	CAT50 x STA20T - 170	170	100	28	42	CAT50 x STA1	STA1 - PTER20 - 100	4.10
32.795.25T.125	CAT50 x STA25T - 125	125	30	35	58	CAT50 x STA2	STA2 - PTER25 - 30	4.08
32.795.25T.165	CAT50 x STA25T - 165	165	70	35	58	CAT50 x STA2	STA2 - PTER25 - 70	4.35
32.795.25T.195	CAT50 x STA25T - 195	195	100	35	58	CAT50 x STA2	STA2 - PTER25 - 100	4.51

### Product information:

► AD+B type is available, please inform us when making an order.

### Standard Accessory: • NUT

Collet	Nut	Pull Stud	Spanner
P.W-4	P.W-41	P.W-56	P.W-62~67

# CAT / STA SYNCHRONIZED TAPPING HOLDER



## CAT / STA 同步補償攻牙刀桿

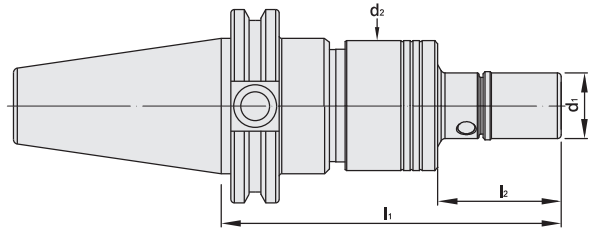

T W PAT NO. M520427  
 J P PAT NO. 3203456  
 D E PAT NO. Nr.202016100106

MODEL NO.	TYPE	l <sub>1</sub>	l <sub>2</sub>	d <sub>1</sub>	d <sub>2</sub>	COMBINATION		WEIGHT (KGS)
						BODY	TAP ADAPTER	
31.795.16U.100	CAT40 x STA16U - 100	100	30	30	42	CAT40 x STA1	STA1 - UT16 - 30	1.27
31.795.16U.140	CAT40 x STA16U - 140	140	70	30	42	CAT40 x STA1	STA1 - UT16 - 70	1.42
31.795.16U.170	CAT40 x STA16U - 170	170	100	30	42	CAT40 x STA1	STA1 - UT16 - 100	1.62
31.795.20U.120	CAT40 x STA20U - 120	120	30	36	58	CAT40 x STA2	STA2 - UT20 - 30	1.75
31.795.20U.160	CAT40 x STA20U - 160	160	70	36	58	CAT40 x STA2	STA2 - UT20 - 70	1.95
31.795.20U.190	CAT40 x STA20U - 190	190	100	36	58	CAT40 x STA2	STA2 - UT20 - 100	2.08
31.795.25U.125	CAT40 x STA25U - 125	125	35	42	58	CAT40 x STA2	STA2 - UT25 - 35	1.75
31.795.25U.175	CAT40 x STA25U - 175	175	85	42	58	CAT40 x STA2	STA2 - UT25 - 85	2.10
31.795.25U.205	CAT40 x STA25U - 205	205	115	42	58	CAT40 x STA2	STA2 - UT25 - 115	2.35
31.795.32U.140	CAT40 x STA32U - 140	140	50	48	58	CAT40 x STA2	STA2 - UT32 - 50	1.80
31.795.32U.175	CAT40 x STA32U - 175	175	85	48	58	CAT40 x STA2	STA2 - UT32 - 85	2.05
31.795.32U.205	CAT40 x STA32U - 205	205	115	48	58	CAT40 x STA2	STA2 - UT32 - 115	2.25
32.795.16U.100	CAT50 x STA16U - 100	100	30	30	42	CAT50 x STA1	STA1 - UT16 - 30	3.27
32.795.16U.140	CAT50 x STA16U - 140	140	70	30	42	CAT50 x STA1	STA1 - UT16 - 70	3.42
32.795.16U.170	CAT50 x STA16U - 170	170	100	30	42	CAT50 x STA1	STA1 - UT16 - 100	3.62
32.795.20U.125	CAT50 x STA20U - 125	125	30	36	58	CAT50 x STA2	STA2 - UT20 - 30	3.83
32.795.20U.165	CAT50 x STA20U - 165	165	70	36	58	CAT50 x STA2	STA2 - UT20 - 70	4.03
32.795.20U.195	CAT50 x STA20U - 195	195	100	36	58	CAT50 x STA2	STA2 - UT20 - 100	4.16
32.795.25U.130	CAT50 x STA25U - 130	130	35	42	58	CAT50 x STA2	STA2 - UT25 - 35	3.83
32.795.25U.180	CAT50 x STA25U - 180	180	85	42	58	CAT50 x STA2	STA2 - UT25 - 85	4.18
32.795.25U.210	CAT50 x STA25U - 210	210	115	42	58	CAT50 x STA2	STA2 - UT25 - 115	4.43
32.795.32U.145	CAT50 x STA32U - 145	145	50	48	58	CAT50 x STA2	STA2 - UT32 - 50	3.88
32.795.32U.180	CAT50 x STA32U - 180	180	85	48	58	CAT50 x STA2	STA2 - UT32 - 85	4.13
32.795.32U.210	CAT50 x STA32U - 210	210	115	48	58	CAT50 x STA2	STA2 - UT32 - 115	4.33

**Product information:**

▶ AD+B type is available, please inform us when making an order.

**Standard Accessory: • NUT**

Collet	Nut	Pull Stud	Spanner
P.W-6~9	P.W-41	P.W-56	P.W-62~67



# CAT / STA SYNCHRONIZED TAPPING HOLDER



CAT / STA 同步補償攻牙刀桿

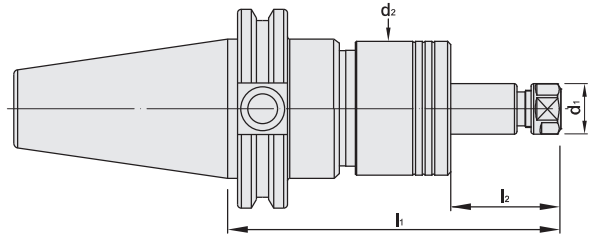

T W PAT NO. M520427  
J P PAT NO. 3203456  
D E PAT NO. Nr.202016100106

MODEL NO.	TYPE	l <sub>1</sub>	l <sub>2</sub>	d <sub>1</sub>	d <sub>2</sub>	COMBINATION		WEIGHT (KGS)
						BODY	TAP ADAPTER	
31.795.11E.140	CAT40 x STA11E - 140	140	70	19	42	CAT40 x STA1	STA1 - ER11A - 70	1.48
31.795.16E.095	CAT40 x STA16E - 95	95	25	28	42	CAT40 x STA1	STA1 - ER16A - 25	1.22
31.795.16E.140	CAT40 x STA16E - 140	140	70	28	42	CAT40 x STA1	STA1 - ER16A - 70	1.42
31.795.16E.220	CAT40 x STA16E - 220	220	150	28	42	CAT40 x STA1	STA1 - ER16A - 150	1.75
31.795.20E.104	CAT40 x STA20E - 104	104	34	34	42	CAT40 x STA1	STA1 - ER20A - 34	1.26
31.795.20E.140	CAT40 x STA20E - 140	140	70	34	42	CAT40 x STA1	STA1 - ER20A - 70	1.42
31.795.32E.130	CAT40 x STA32E - 130	130	40	50	58	CAT40 x STA2	STA2 - ER32 - 40	1.89
31.795.32E.160	CAT40 x STA32E - 160	160	70	50	58	CAT40 x STA2	STA2 - ER32 - 70	2.12
32.795.11E.140	CAT50 x STA11E - 140	140	70	19	42	CAT50 x STA1	STA1 - ER11A - 70	3.48
32.795.16E.095	CAT50 x STA16E - 95	95	25	28	42	CAT50 x STA1	STA1 - ER16A - 25	3.22
32.795.16E.140	CAT50 x STA16E - 140	140	70	28	42	CAT50 x STA1	STA1 - ER16A - 70	3.42
32.795.16E.220	CAT50 x STA16E - 220	220	150	28	42	CAT50 x STA1	STA1 - ER16A - 150	3.75
32.795.20E.104	CAT50 x STA20E - 104	104	34	34	42	CAT50 x STA1	STA1 - ER20A - 34	3.26
32.795.20E.140	CAT50 x STA20E - 140	140	70	34	42	CAT50 x STA1	STA1 - ER20A - 70	3.42
32.795.32E.135	CAT50 x STA32E - 135	135	40	50	58	CAT50 x STA2	STA2 - ER32 - 40	3.97
32.795.32E.165	CAT50 x STA32E - 165	165	70	50	58	CAT50 x STA2	STA2 - ER32 - 70	4.20

## Product information:

► AD+B type is available, please inform us when making an order.

## Standard Accessory: • NUT

Collet	Nut	Pull Stud	Spanner
P.W-6~24	P.W-42	P.W-56	P.W-62~65



# DAT / STA SYNCHRONIZED TAPPING HOLDER



## DAT / STA 同步補償攻牙刀桿

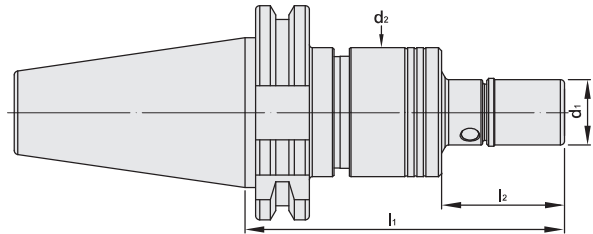

T W PAT NO. M520427  
 J P PAT NO. 3203456  
 D E PAT NO. Nr.202016100106

MODEL NO.	TYPE	l <sub>1</sub>	l <sub>2</sub>	d <sub>1</sub>	d <sub>2</sub>	COMBINATION		WEIGHT (KGS)
						BODY	TAP ADAPTER	
51.795.08T.090	DAT40 x STA8T - 90	90	30	12	42	DAT40 x STA1	STA1 - PTER8 - 30	1.13
51.795.08T.130	DAT40 x STA8T - 130	130	70	12	42	DAT40 x STA1	STA1 - PTER8 - 70	1.19
51.795.08T.160	DAT40 x STA8T - 160	160	100	12	42	DAT40 x STA1	STA1 - PTER8 - 100	1.24
51.795.11T.090	DAT40 x STA11T - 90	90	30	16	42	DAT40 x STA1	STA1 - PTER11 - 30	1.58
51.795.11T.130	DAT40 x STA11T - 130	130	70	16	42	DAT40 x STA1	STA1 - PTER11 - 70	1.64
51.795.11T.160	DAT40 x STA11T - 160	160	100	16	42	DAT40 x STA1	STA1 - PTER11 - 100	1.68
51.795.16T.090	DAT40 x STA16T - 90	90	30	22	42	DAT40 x STA1	STA1 - PTER16 - 30	1.59
51.795.16T.130	DAT40 x STA16T - 130	130	70	22	42	DAT40 x STA1	STA1 - PTER16 - 70	1.65
51.795.16T.160	DAT40 x STA16T - 160	160	100	22	42	DAT40 x STA1	STA1 - PTER16 - 100	1.69
51.795.20T.090	DAT40 x STA20T - 90	90	30	28	42	DAT40 x STA1	STA1 - PTER20 - 30	1.56
51.795.20T.130	DAT40 x STA20T - 130	130	70	28	42	DAT40 x STA1	STA1 - PTER20 - 70	1.83
51.795.20T.160	DAT40 x STA20T - 160	160	100	28	42	DAT40 x STA1	STA1 - PTER20 - 100	1.99
51.795.25T.120	DAT40 x STA25T - 120	120	30	35	58	DAT40 x STA2	STA2 - PTER25 - 30	2.05
51.795.25T.160	DAT40 x STA25T - 160	160	70	35	58	DAT40 x STA2	STA2 - PTER25 - 70	2.32
51.795.25T.190	DAT40 x STA25T - 190	190	100	35	58	DAT40 x STA2	STA2 - PTER25 - 100	2.48
52.795.08T.100	DAT50 x STA8T - 100	100	30	12	42	DAT50 x STA1	STA1 - PTER8 - 30	2.85
52.795.08T.140	DAT50 x STA8T - 140	140	70	12	42	DAT50 x STA1	STA1 - PTER8 - 70	2.91
52.795.08T.170	DAT50 x STA8T - 170	170	100	12	42	DAT50 x STA1	STA1 - PTER8 - 100	2.96
52.795.11T.100	DAT50 x STA11T - 100	100	30	16	42	DAT50 x STA1	STA1 - PTER11 - 30	3.30
52.795.11T.140	DAT50 x STA11T - 140	140	70	16	42	DAT50 x STA1	STA1 - PTER11 - 70	3.36
52.795.11T.170	DAT50 x STA11T - 170	170	100	16	42	DAT50 x STA1	STA1 - PTER11 - 100	3.40
52.795.16T.100	DAT50 x STA16T - 100	100	30	22	42	DAT50 x STA1	STA1 - PTER16 - 30	3.31
52.795.16T.140	DAT50 x STA16T - 140	140	70	22	42	DAT50 x STA1	STA1 - PTER16 - 70	3.37
52.795.16T.170	DAT50 x STA16T - 170	170	100	22	42	DAT50 x STA1	STA1 - PTER16 - 100	3.41
52.795.20T.100	DAT50 x STA20T - 100	100	30	28	42	DAT50 x STA1	STA1 - PTER20 - 30	3.28
52.795.20T.140	DAT50 x STA20T - 140	140	70	28	42	DAT50 x STA1	STA1 - PTER20 - 70	3.55
52.795.20T.170	DAT50 x STA20T - 170	170	100	28	42	DAT50 x STA1	STA1 - PTER20 - 100	3.71
52.795.25T.110	DAT50 x STA25T - 110	110	30	35	58	DAT50 x STA2	STA2 - PTER25 - 30	3.66
52.795.25T.150	DAT50 x STA25T - 150	150	70	35	58	DAT50 x STA2	STA2 - PTER25 - 70	3.93
52.795.25T.180	DAT50 x STA25T - 180	180	100	35	58	DAT50 x STA2	STA2 - PTER25 - 100	4.09

**Product information:**

► AD+B type is available, please inform us when making an order.

**Standard Accessory: • NUT**

Collet	Nut	Pull Stud	Spanner
P.W-4	P.W-41	P.W-57	P.W-62~67



# DAT / STA SYNCHRONIZED TAPPING HOLDER



## DAT / STA 同步補償攻牙刀桿

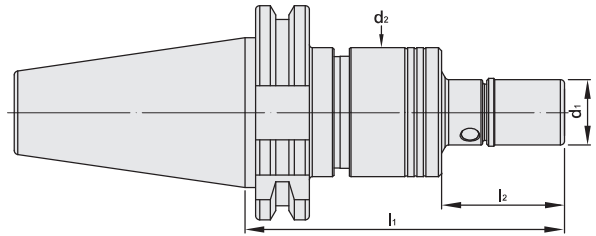

T W PAT NO. M520427  
J P PAT NO. 3203456  
D E PAT NO. Nr.202016100106

MODEL NO.	TYPE	l <sub>1</sub>	l <sub>2</sub>	d <sub>1</sub>	d <sub>2</sub>	COMBINATION		WEIGHT (KGS)
						BODY	TAP ADAPTER	
51.795.16U.100	DAT40 x STA16U - 100	100	30	30	42	DAT40 x STA1	STA1 - UT16 - 30	1.16
51.795.16U.140	DAT40 x STA16U - 140	140	70	30	42	DAT40 x STA1	STA1 - UT16 - 70	1.31
51.795.16U.170	DAT40 x STA16U - 170	170	100	30	42	DAT40 x STA1	STA1 - UT16 - 100	1.51
51.795.20U.120	DAT40 x STA20U - 120	120	30	36	58	DAT40 x STA2	STA2 - UT20 - 30	1.80
51.795.20U.160	DAT40 x STA20U - 160	160	70	36	58	DAT40 x STA2	STA2 - UT20 - 70	2.00
51.795.20U.190	DAT40 x STA20U - 190	190	100	36	58	DAT40 x STA2	STA2 - UT20 - 100	2.13
51.795.25U.125	DAT40 x STA25U - 125	125	35	42	58	DAT40 x STA2	STA2 - UT25 - 35	1.80
51.795.25U.175	DAT40 x STA25U - 175	175	85	42	58	DAT40 x STA2	STA2 - UT25 - 85	2.15
51.795.25U.205	DAT40 x STA25U - 205	205	115	42	58	DAT40 x STA2	STA2 - UT25 - 115	2.40
51.795.32U.140	DAT40 x STA32U - 140	140	50	48	58	DAT40 x STA2	STA2 - UT32 - 50	1.85
51.795.32U.175	DAT40 x STA32U - 175	175	85	48	58	DAT40 x STA2	STA2 - UT32 - 85	2.10
51.795.32U.205	DAT40 x STA32U - 205	205	115	48	58	DAT40 x STA2	STA2 - UT32 - 115	2.30
52.795.16U.090	DAT50 x STA16U - 90	90	30	30	42	DAT50 x STA1	STA1 - UT16 - 30	2.88
52.795.16U.130	DAT50 x STA16U - 130	130	70	30	42	DAT50 x STA1	STA1 - UT16 - 70	3.03
52.795.16U.160	DAT50 x STA16U - 160	160	100	30	42	DAT50 x STA1	STA1 - UT16 - 100	3.23
52.795.20U.110	DAT50 x STA20U - 110	110	30	36	58	DAT50 x STA2	STA2 - UT20 - 30	3.41
52.795.20U.150	DAT50 x STA20U - 150	150	70	36	58	DAT50 x STA2	STA2 - UT20 - 70	3.61
52.795.20U.180	DAT50 x STA20U - 180	180	100	36	58	DAT50 x STA2	STA2 - UT20 - 100	3.74
52.795.25U.115	DAT50 x STA25U - 115	115	35	42	58	DAT50 x STA2	STA2 - UT25 - 35	3.41
52.795.25U.165	DAT50 x STA25U - 165	165	85	42	58	DAT50 x STA2	STA2 - UT25 - 85	3.76
52.795.25U.195	DAT50 x STA25U - 195	195	115	42	58	DAT50 x STA2	STA2 - UT25 - 115	4.01
52.795.32U.130	DAT50 x STA32U - 130	130	50	48	58	DAT50 x STA2	STA2 - UT32 - 50	3.46
52.795.32U.165	DAT50 x STA32U - 165	165	85	48	58	DAT50 x STA2	STA2 - UT32 - 85	3.71
52.795.32U.195	DAT50 x STA32U - 195	195	115	48	58	DAT50 x STA2	STA2 - UT32 - 115	3.91

### Product information:

- ▶ AD+B type is available, please inform us when making an order.

### Standard Accessory: • NUT

Collet	Nut	Pull Stud	Spanner
P.W-6~9	P.W-41	P.W-57	P.W-62~67

# DAT / STA SYNCHRONIZED TAPPING HOLDER



DAT / STA 同步補償攻牙刀桿

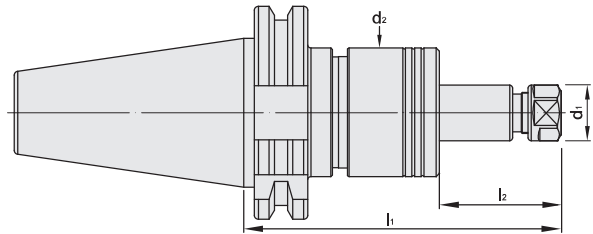

T W PAT NO. M520427  
 J P PAT NO. 3203456  
 D E PAT NO. Nr.202016100106

MODEL NO.	TYPE	l <sub>1</sub>	l <sub>2</sub>	d <sub>1</sub>	d <sub>2</sub>	COMBINATION		WEIGHT (KGS)
						BODY	TAP ADAPTER	
51.795.11E.130	DAT40 x STA11E - 130	130	70	19	42	DAT40 x STA1	STA1 - ER11A - 70	1.37
51.795.16E.085	DAT40 x STA16E - 85	85	25	28	42	DAT40 x STA1	STA1 - ER16A - 25	1.11
51.795.16E.130	DAT40 x STA16E - 130	130	70	28	42	DAT40 x STA1	STA1 - ER16A - 70	1.31
51.795.16E.210	DAT40 x STA16E - 210	210	150	28	58	DAT40 x STA2	STA1 - ER16A - 150	2.13
51.795.20E.094	DAT40 x STA20E - 94	94	34	34	58	DAT40 x STA2	STA1 - ER20A - 34	1.64
51.795.20E.130	DAT40 x STA20E - 130	130	70	34	58	DAT40 x STA2	STA1 - ER20A - 70	1.80
51.795.32E.130	DAT40 x STA32E - 130	130	40	50	58	DAT40 x STA2	STA2 - ER32 - 40	1.94
51.795.32E.160	DAT40 x STA32E - 160	160	70	50	58	DAT40 x STA2	STA2 - ER32 - 70	2.17
52.795.11E.130	DAT50 x STA11E - 130	130	70	19	58	DAT40 x STA2	STA1 - ER11A - 70	1.86
52.795.16E.085	DAT50 x STA16E - 85	85	25	28	58	DAT40 x STA2	STA1 - ER16A - 25	1.60
52.795.16E.130	DAT50 x STA16E - 130	130	70	28	58	DAT40 x STA2	STA1 - ER16A - 70	1.80
52.795.16E.210	DAT50 x STA16E - 210	210	150	28	58	DAT40 x STA2	STA1 - ER16A - 150	2.13
52.795.20E.094	DAT50 x STA20E - 94	94	34	34	42	DAT50 x STA1	STA1 - ER20A - 34	2.87
52.795.20E.130	DAT50 x STA20E - 130	130	70	34	42	DAT50 x STA1	STA1 - ER20A - 70	3.03
52.795.32E.120	DAT50 x STA32E - 120	120	40	50	42	DAT50 x STA1	STA2 - ER32 - 40	3.17
52.795.32E.150	DAT50 x STA32E - 150	150	70	50	58	DAT50 x STA2	STA2 - ER32 - 70	3.78

**Product information:**

► AD+B type is available, please inform us when making an order.

**Standard Accessory: • NUT**

Collet	Nut	Pull Stud	Spanner
P.W-6~24	P.W-42	P.W-57	P.W-62~65



# SBT / STA SYNCHRONIZED TAPPING HOLDER



## SBT / STA 法蘭加厚型同步補償攻牙刀桿

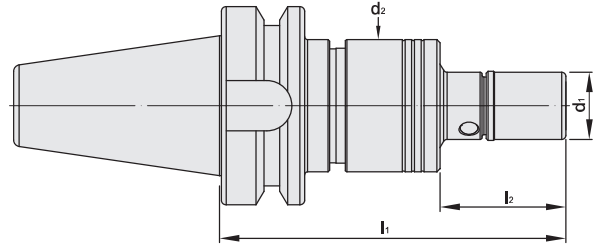

T W PAT NO. M520427  
J P PAT NO. 3203456  
D E PAT NO. Nr.202016100106

MODEL NO.	TYPE	l <sub>1</sub>	l <sub>2</sub>	d <sub>1</sub>	d <sub>2</sub>	COMBINATION		WEIGHT (KGS)
						BODY	TAP ADAPTER	
25.795.08T.090	SBT30 x STA8T - 90	90	30	12	42	SBT30 x STA1	STA1 - PTER8 - 30	0.68
25.795.08T.130	SBT30 x STA8T - 130	130	70	12	42	SBT30 x STA1	STA1 - PTER8 - 70	0.74
25.795.08T.160	SBT30 x STA8T - 160	160	100	12	42	SBT30 x STA1	STA1 - PTER8 - 100	0.79
25.795.11T.090	SBT30 x STA11T - 90	90	30	16	42	SBT30 x STA1	STA1 - PTER11 - 30	1.13
25.795.11T.130	SBT30 x STA11T - 130	130	70	16	42	SBT30 x STA1	STA1 - PTER11 - 70	1.19
25.795.11T.160	SBT30 x STA11T - 160	160	100	16	42	SBT30 x STA1	STA1 - PTER11 - 100	1.23
25.795.16T.090	SBT30 x STA16T - 90	90	30	22	42	SBT30 x STA1	STA1 - PTER16 - 30	1.14
25.795.16T.130	SBT30 x STA16T - 130	130	70	22	42	SBT30 x STA1	STA1 - PTER16 - 70	1.20
25.795.16T.160	SBT30 x STA16T - 160	160	100	22	42	SBT30 x STA1	STA1 - PTER16 - 100	1.24
25.795.20T.090	SBT30 x STA20T - 90	90	30	28	42	SBT30 x STA1	STA1 - PTER20 - 30	1.11
25.795.20T.130	SBT30 x STA20T - 130	130	70	28	42	SBT30 x STA1	STA1 - PTER20 - 70	1.38
25.795.20T.160	SBT30 x STA20T - 160	160	100	28	42	SBT30 x STA1	STA1 - PTER20 - 100	1.54
26.795.08T.100	SBT40 x STA8T - 100	100	30	12	42	SBT40 x STA1	STA1 - PTER8 - 30	1.30
26.795.08T.140	SBT40 x STA8T - 140	140	70	12	42	SBT40 x STA1	STA1 - PTER8 - 70	1.36
26.795.08T.170	SBT40 x STA8T - 170	170	100	12	42	SBT40 x STA1	STA1 - PTER8 - 100	1.41
26.795.11T.100	SBT40 x STA11T - 100	100	30	16	42	SBT40 x STA1	STA1 - PTER11 - 30	1.75
26.795.11T.140	SBT40 x STA11T - 140	140	70	16	42	SBT40 x STA1	STA1 - PTER11 - 70	1.81
26.795.11T.170	SBT40 x STA11T - 170	170	100	16	42	SBT40 x STA1	STA1 - PTER11 - 100	1.85
26.795.16T.100	SBT40 x STA16T - 100	100	30	22	42	SBT40 x STA1	STA1 - PTER16 - 30	1.76
26.795.16T.140	SBT40 x STA16T - 140	140	70	22	42	SBT40 x STA1	STA1 - PTER16 - 70	1.82
26.795.16T.170	SBT40 x STA16T - 170	170	100	22	42	SBT40 x STA1	STA1 - PTER16 - 100	1.86
26.795.20T.100	SBT40 x STA20T - 100	100	30	28	42	SBT40 x STA1	STA1 - PTER20 - 30	1.73
26.795.20T.140	SBT40 x STA20T - 140	140	70	28	42	SBT40 x STA1	STA1 - PTER20 - 70	2.00
26.795.20T.170	SBT40 x STA20T - 170	170	100	28	42	SBT40 x STA1	STA1 - PTER20 - 100	2.16
26.795.25T.115	SBT40 x STA25T - 115	115	30	35	58	SBT40 x STA2	STA2 - PTER25 - 30	2.03
26.795.25T.155	SBT40 x STA25T - 155	155	70	35	58	SBT40 x STA2	STA2 - PTER25 - 70	2.30
26.795.25T.185	SBT40 x STA25T - 185	185	100	35	58	SBT40 x STA2	STA2 - PTER25 - 100	2.46

### Product information:

- ▶ AD+B type is available, please inform us when making an order.
- ▶ SBT30 tool holders are without coolant supply over collars.

### Standard Accessory: • NUT

Collet	Nut	Pull Stud	Spanner
P.W-4	P.W-41	P.W-54~55	P.W-62~67

# SBT / STA SYNCHRONIZED TAPPING HOLDER



## SBT / STA 法蘭加厚型同步補償攻牙刀桿

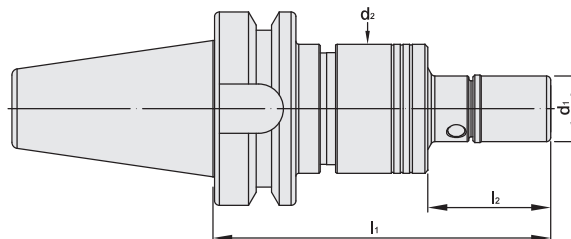

T W PAT NO. M520427  
J P PAT NO. 3203456  
D E PAT NO. Nr.202016100106

MODEL NO.	TYPE	l <sub>1</sub>	l <sub>2</sub>	d <sub>1</sub>	d <sub>2</sub>	COMBINATION		WEIGHT (KGS)
						BODY	TAP ADAPTER	
27.795.08T.090	SBT50 x STA8T - 90	90	30	12	42	SBT50 x STA1	STA1 - PTER8 - 30	3.80
27.795.08T.130	SBT50 x STA8T - 130	130	70	12	42	SBT50 x STA1	STA1 - PTER8 - 70	3.86
27.795.08T.160	SBT50 x STA8T - 160	160	100	12	42	SBT50 x STA1	STA1 - PTER8 - 100	3.91
27.795.11T.090	SBT50 x STA11T - 90	90	30	16	42	SBT50 x STA1	STA1 - PTER11 - 30	4.25
27.795.11T.130	SBT50 x STA11T - 130	130	70	16	42	SBT50 x STA1	STA1 - PTER11 - 70	4.31
27.795.11T.160	SBT50 x STA11T - 160	160	100	16	42	SBT50 x STA1	STA1 - PTER11 - 100	4.35
27.795.16T.090	SBT50 x STA16T - 90	90	30	22	42	SBT50 x STA1	STA1 - PTER16 - 30	4.26
27.795.16T.130	SBT50 x STA16T - 130	130	70	22	42	SBT50 x STA1	STA1 - PTER16 - 70	4.32
27.795.16T.160	SBT50 x STA16T - 160	160	100	22	42	SBT50 x STA1	STA1 - PTER16 - 100	4.36
27.795.20T.090	SBT50 x STA20T - 90	90	30	28	42	SBT50 x STA1	STA1 - PTER20 - 30	4.23
27.795.20T.130	SBT50 x STA20T - 130	130	70	28	42	SBT50 x STA1	STA1 - PTER20 - 70	4.50
27.795.20T.160	SBT50 x STA20T - 160	160	100	28	42	SBT50 x STA1	STA1 - PTER20 - 100	4.66
27.795.25T.125	SBT50 x STA25T - 125	125	30	35	58	SBT50 x STA2	STA2 - PTER25 - 30	4.53
27.795.25T.165	SBT50 x STA25T - 165	165	70	35	58	SBT50 x STA2	STA2 - PTER25 - 70	4.80
27.795.25T.195	SBT50 x STA25T - 195	195	100	35	58	SBT50 x STA2	STA2 - PTER25 - 100	4.96

### Product information:

► AD+B type is available, please inform us when making an order.

### Standard Accessory: • NUT

Collet	Nut	Pull Stud	Spanner
P.W-4	P.W-41	P.W-54~55	P.W-62~67



# SBT / STA SYNCHRONIZED TAPPING HOLDER



## SBT / STA 法蘭加厚型同步補償攻牙刀桿

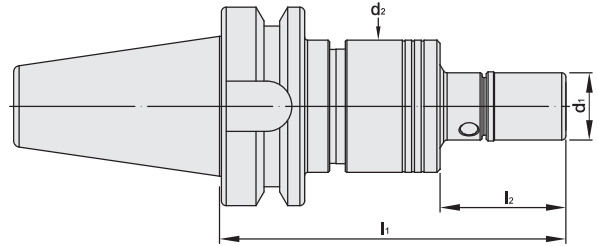

T W PAT NO. M520427  
J P PAT NO. 3203456  
D E PAT NO. Nr.202016100106

MODEL NO.	TYPE	l <sub>1</sub>	l <sub>2</sub>	d <sub>1</sub>	d <sub>2</sub>	COMBINATION		WEIGHT (KGS)
						BODY	TAP ADAPTER	
25.795.16U.090	SBT30 x STA16U - 90	90	30	30	42	SBT30 x STA1	STA1 - UT16 - 30	0.71
25.795.16U.130	SBT30 x STA16U - 130	130	70	30	42	SBT30 x STA1	STA1 - UT16 - 70	0.86
25.795.16U.160	SBT30 x STA16U - 160	160	100	30	42	SBT30 x STA1	STA1 - UT16 - 100	1.06
26.795.16U.100	SBT40 x STA16U - 100	100	30	30	42	SBT40 x STA1	STA1 - UT16 - 30	1.33
26.795.16U.140	SBT40 x STA16U - 140	140	70	30	42	SBT40 x STA1	STA1 - UT16 - 70	1.48
26.795.16U.170	SBT40 x STA16U - 170	170	100	30	42	SBT40 x STA1	STA1 - UT16 - 100	1.68
26.795.20U.115	SBT40 x STA20U - 115	115	30	36	58	SBT40 x STA2	STA2 - UT20 - 30	1.78
26.795.20U.155	SBT40 x STA20U - 155	155	70	36	58	SBT40 x STA2	STA2 - UT20 - 70	1.98
26.795.20U.185	SBT40 x STA20U - 185	185	100	36	58	SBT40 x STA2	STA2 - UT20 - 100	2.11
26.795.25U.120	SBT40 x STA25U - 120	120	35	42	58	SBT40 x STA2	STA2 - UT25 - 35	1.78
26.795.25U.170	SBT40 x STA25U - 170	170	85	42	58	SBT40 x STA2	STA2 - UT25 - 85	2.13
26.795.25U.200	SBT40 x STA25U - 200	200	115	42	58	SBT40 x STA2	STA2 - UT25 - 115	2.38
26.795.32U.135	SBT40 x STA32U - 135	135	50	48	58	SBT40 x STA2	STA2 - UT32 - 50	1.83
26.795.32U.170	SBT40 x STA32U - 170	170	85	48	58	SBT40 x STA2	STA2 - UT32 - 85	2.08
26.795.32U.200	SBT40 x STA32U - 200	200	115	48	58	SBT40 x STA2	STA2 - UT32 - 115	2.28
27.795.16U.090	SBT50 x STA16U - 90	90	30	30	42	SBT50 x STA1	STA1 - UT16 - 30	3.83
27.795.16U.130	SBT50 x STA16U - 130	130	70	30	42	SBT50 x STA1	STA1 - UT16 - 70	3.98
27.795.16U.160	SBT50 x STA16U - 160	160	100	30	42	SBT50 x STA1	STA1 - UT16 - 100	4.18
27.795.20U.125	SBT50 x STA20U - 125	125	30	36	58	SBT50 x STA2	STA2 - UT20 - 30	4.28
27.795.20U.165	SBT50 x STA20U - 165	165	70	36	58	SBT50 x STA2	STA2 - UT20 - 70	4.48
27.795.20U.195	SBT50 x STA20U - 195	195	100	36	58	SBT50 x STA2	STA2 - UT20 - 100	4.61
27.795.25U.130	SBT50 x STA25U - 130	130	35	42	58	SBT50 x STA2	STA2 - UT25 - 35	4.28
27.795.25U.180	SBT50 x STA25U - 180	180	85	42	58	SBT50 x STA2	STA2 - UT25 - 85	4.63
27.795.25U.210	SBT50 x STA25U - 210	210	115	42	58	SBT50 x STA2	STA2 - UT25 - 115	4.88
27.795.32U.145	SBT50 x STA32U - 145	145	50	48	58	SBT50 x STA2	STA2 - UT32 - 50	4.33
27.795.32U.180	SBT50 x STA32U - 180	180	85	48	58	SBT50 x STA2	STA2 - UT32 - 85	4.58
27.795.32U.210	SBT50 x STA32U - 210	210	115	48	58	SBT50 x STA2	STA2 - UT32 - 115	4.78

### Product information:

- ▶ AD+B type is available, please inform us when making an order.
- ▶ SBT30 tool holders are without coolant supply over collars.

### Standard Accessory: • NUT

Collet	Nut	Pull Stud	Spanner
P.W-6~9	P.W-41	P.W-54~55	P.W-62~67

# SBT / STA SYNCHRONIZED TAPPING HOLDER



## SBT / STA 法蘭加厚型同步補償攻牙刀桿



T W PAT NO. M520427  
J P PAT NO. 3203456  
D E PAT NO. Nr.202016100106

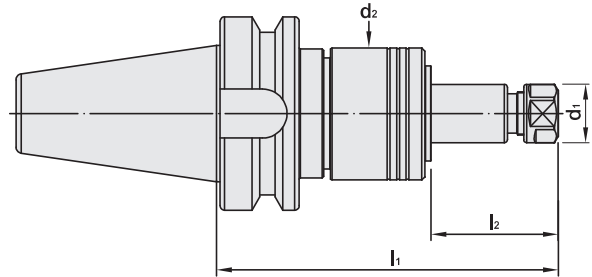





MODEL NO.	TYPE	l <sub>1</sub>	l <sub>2</sub>	d <sub>1</sub>	d <sub>2</sub>	COMBINATION		WEIGHT (KGS)
						BODY	TAP ADAPTER	
25.795.11E.130	SBT30 x STA11E - 130	130	70	19	42	SBT30 x STA1	STA1 - ER11A - 70	0.92
25.795.16E.085	SBT30 x STA16E - 85	85	25	28	42	SBT30 x STA1	STA1 - ER16A - 25	0.66
25.795.16E.130	SBT30 x STA16E - 130	130	70	28	42	SBT30 x STA1	STA1 - ER16A - 70	0.86
25.795.16E.210	SBT30 x STA16E - 210	210	150	28	42	SBT30 x STA1	STA1 - ER16A - 150	1.19
25.795.20E.094	SBT30 x STA20E - 94	94	34	34	42	SBT30 x STA1	STA1 - ER20A - 34	0.70
25.795.20E.130	SBT30 x STA20E - 130	130	70	34	42	SBT30 x STA1	STA1 - ER20A - 70	0.86
26.795.11E.140	SBT40 x STA11E - 140	140	70	19	42	SBT40 x STA1	STA1 - ER11A - 70	1.54
26.795.16E.095	SBT40 x STA16E - 95	95	25	28	42	SBT40 x STA1	STA1 - ER16A - 25	1.28
26.795.16E.140	SBT40 x STA16E - 140	140	70	28	42	SBT40 x STA1	STA1 - ER16A - 70	1.48
26.795.16E.220	SBT40 x STA16E - 220	220	150	28	42	SBT40 x STA1	STA1 - ER16A - 150	1.81
26.795.20E.104	SBT40 x STA20E - 104	104	34	34	42	SBT40 x STA1	STA1 - ER20A - 34	1.32
26.795.20E.140	SBT40 x STA20E - 140	140	70	34	42	SBT40 x STA1	STA1 - ER20A - 70	1.48
26.795.32E.125	SBT40 x STA32E - 125	125	40	50	58	SBT40 x STA2	STA2 - ER32 - 40	1.92
26.795.32E.155	SBT40 x STA32E - 155	155	70	50	58	SBT40 x STA2	STA2 - ER32 - 70	2.15
27.795.11E.130	SBT50 x STA11E - 130	130	70	19	42	SBT40 x STA1	STA1 - ER11A - 70	1.54
27.795.16E.085	SBT50 x STA16E - 85	85	25	28	42	SBT50 x STA1	STA1 - ER16A - 25	3.78
27.795.16E.130	SBT50 x STA16E - 130	130	70	28	42	SBT50 x STA1	STA1 - ER16A - 70	3.98
27.795.16E.210	SBT50 x STA16E - 210	210	150	28	42	SBT50 x STA1	STA1 - ER16A - 150	4.31
27.795.20E.094	SBT50 x STA20E - 94	94	34	34	42	SBT50 x STA1	STA1 - ER20A - 34	3.82
27.795.20E.140	SBT50 x STA20E - 140	140	70	34	42	SBT50 x STA1	STA1 - ER20A - 70	3.98
27.795.32E.135	SBT50 x STA32E - 135	135	40	50	58	SBT50 x STA2	STA2 - ER32 - 40	4.42
27.795.32E.165	SBT50 x STA32E - 165	165	70	50	58	SBT50 x STA2	STA2 - ER32 - 70	4.65

### Product information:

- ▶ AD+B type is available, please inform us when making an order.
- ▶ SBT30 tool holders are without coolant supply over collars.

### Standard Accessory: • NUT

Collet	Nut	Pull Stud	Spanner
			
P.W-6~24	P.W-42	P.W-54~55	P.W-62~65



# SCAT / STA SYNCHRONIZED TAPPING HOLDER



## SCAT / STA 法蘭加厚型同步補償攻牙刀桿

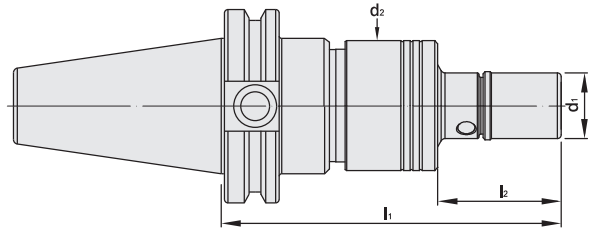

T W PAT NO. M520427  
J P PAT NO. 3203456  
D E PAT NO. Nr.202016100106

MODEL NO.	TYPE	l <sub>1</sub>	l <sub>2</sub>	d <sub>1</sub>	d <sub>2</sub>	COMBINATION		WEIGHT (KGS)
						BODY	TAP ADAPTER	
43.795.08T.100	SCAT40 x STA8T - 100	100	30	12	42	SCAT40 x STA1	STA1 - PTER8 - 30	1.24
43.795.08T.140	SCAT40 x STA8T - 140	140	70	12	42	SCAT40 x STA1	STA1 - PTER8 - 70	1.30
43.795.08T.170	SCAT40 x STA8T - 170	170	100	12	42	SCAT40 x STA1	STA1 - PTER8 - 100	1.35
43.795.11T.100	SCAT40 x STA11T - 100	100	30	16	42	SCAT40 x STA1	STA1 - PTER11 - 30	1.69
43.795.11T.140	SCAT40 x STA11T - 140	140	70	16	42	SCAT40 x STA1	STA1 - PTER11 - 70	1.75
43.795.11T.170	SCAT40 x STA11T - 170	170	100	16	42	SCAT40 x STA1	STA1 - PTER11 - 100	1.79
43.795.16T.100	SCAT40 x STA16T - 100	100	30	22	42	SCAT40 x STA1	STA1 - PTER16 - 30	1.70
43.795.16T.140	SCAT40 x STA16T - 140	140	70	22	42	SCAT40 x STA1	STA1 - PTER16 - 70	1.76
43.795.16T.170	SCAT40 x STA16T - 170	170	100	22	42	SCAT40 x STA1	STA1 - PTER16 - 100	1.80
43.795.20T.100	SCAT40 x STA20T - 100	100	30	28	42	SCAT40 x STA1	STA1 - PTER20 - 30	1.67
43.795.20T.140	SCAT40 x STA20T - 140	140	70	28	42	SCAT40 x STA1	STA1 - PTER20 - 70	1.94
43.795.20T.170	SCAT40 x STA20T - 170	170	100	28	42	SCAT40 x STA1	STA1 - PTER20 - 100	2.10
43.795.25T.120	SCAT40 x STA25T - 120	120	30	35	58	SCAT40 x STA2	STA2 - PTER25 - 30	2.00
43.795.25T.160	SCAT40 x STA25T - 160	160	70	35	58	SCAT40 x STA2	STA2 - PTER25 - 70	2.27
43.795.25T.190	SCAT40 x STA25T - 190	190	100	35	58	SCAT40 x STA2	STA2 - PTER25 - 100	2.43
44.795.08T.100	SCAT50 x STA8T - 100	100	30	12	42	SCAT50 x STA1	STA1 - PTER8 - 30	3.24
44.795.08T.140	SCAT50 x STA8T - 140	140	70	12	42	SCAT50 x STA1	STA1 - PTER8 - 70	3.30
44.795.08T.170	SCAT50 x STA8T - 170	170	100	12	42	SCAT50 x STA1	STA1 - PTER8 - 100	3.35
44.795.11T.100	SCAT50 x STA11T - 100	100	30	16	42	SCAT50 x STA1	STA1 - PTER11 - 30	3.69
44.795.11T.140	SCAT50 x STA11T - 140	140	70	16	42	SCAT50 x STA1	STA1 - PTER11 - 70	3.75
44.795.11T.170	SCAT50 x STA11T - 170	170	100	16	42	SCAT50 x STA1	STA1 - PTER11 - 100	3.79
44.795.16T.100	SCAT50 x STA16T - 100	100	30	22	42	SCAT50 x STA1	STA1 - PTER16 - 30	3.70
44.795.16T.140	SCAT50 x STA16T - 140	140	70	22	42	SCAT50 x STA1	STA1 - PTER16 - 70	3.76
44.795.16T.170	SCAT50 x STA16T - 170	170	100	22	42	SCAT50 x STA1	STA1 - PTER16 - 100	3.80
44.795.20T.100	SCAT50 x STA20T - 100	100	30	28	42	SCAT50 x STA1	STA1 - PTER20 - 30	3.67
44.795.20T.140	SCAT50 x STA20T - 140	140	70	28	42	SCAT50 x STA1	STA1 - PTER20 - 70	3.94
44.795.20T.170	SCAT50 x STA20T - 170	170	100	28	42	SCAT50 x STA1	STA1 - PTER20 - 100	4.10
44.795.25T.125	SCAT50 x STA25T - 125	125	30	35	58	SCAT50 x STA2	STA2 - PTER25 - 30	4.08
44.795.25T.165	SCAT50 x STA25T - 165	165	70	35	58	SCAT50 x STA2	STA2 - PTER25 - 70	4.35
44.795.25T.195	SCAT50 x STA25T - 195	195	100	35	58	SCAT50 x STA2	STA2 - PTER25 - 100	4.51

### Product information:

- ▶ AD+B type is available, please inform us when making an order.

### Standard Accessory: • NUT

Collet	Nut	Pull Stud	Spanner
P.W-4	P.W-41	P.W-56	P.W-62~67



# SCAT / STA SYNCHRONIZED TAPPING HOLDER



## SCAT / STA 法蘭加厚型同步補償攻牙刀桿

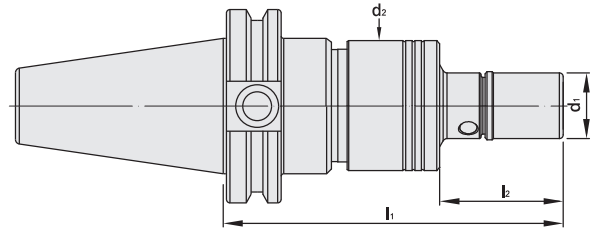

T W PAT NO. M520427  
 J P PAT NO. 3203456  
 D E PAT NO. Nr.202016100106

MODEL NO.	TYPE	l <sub>1</sub>	l <sub>2</sub>	d <sub>1</sub>	d <sub>2</sub>	COMBINATION		WEIGHT (KGS)
						BODY	TAP ADAPTER	
43.795.16U.100	SCAT40 x STA16U - 100	100	30	30	42	SCAT40 x STA1	STA1 - UT16 - 30	1.27
43.795.16U.140	SCAT40 x STA16U - 140	140	70	30	42	SCAT40 x STA1	STA1 - UT16 - 70	1.42
43.795.16U.170	SCAT40 x STA16U - 170	170	100	30	42	SCAT40 x STA1	STA1 - UT16 - 100	1.62
43.795.20U.120	SCAT40 x STA20U - 120	120	30	36	58	SCAT40 x STA2	STA2 - UT20 - 30	1.75
43.795.20U.160	SCAT40 x STA20U - 160	160	70	36	58	SCAT40 x STA2	STA2 - UT20 - 70	1.95
43.795.20U.190	SCAT40 x STA20U - 190	190	100	36	58	SCAT40 x STA2	STA2 - UT20 - 100	2.08
43.795.25U.125	SCAT40 x STA25U - 125	125	35	42	58	SCAT40 x STA2	STA2 - UT25 - 35	1.75
43.795.25U.175	SCAT40 x STA25U - 175	175	85	42	58	SCAT40 x STA2	STA2 - UT25 - 85	2.10
43.795.25U.205	SCAT40 x STA25U - 205	205	115	42	58	SCAT40 x STA2	STA2 - UT25 - 115	2.35
43.795.32U.140	SCAT40 x STA32U - 140	140	50	48	58	SCAT40 x STA2	STA2 - UT32 - 50	1.80
43.795.32U.175	SCAT40 x STA32U - 175	175	85	48	58	SCAT40 x STA2	STA2 - UT32 - 85	2.05
43.795.32U.205	SCAT40 x STA32U - 205	205	115	48	58	SCAT40 x STA2	STA2 - UT32 - 115	2.25
44.795.16U.100	SCAT50 x STA16U - 100	100	30	30	42	SCAT50 x STA1	STA1 - UT16 - 30	3.27
44.795.16U.140	SCAT50 x STA16U - 140	140	70	30	42	SCAT50 x STA1	STA1 - UT16 - 70	3.42
44.795.16U.170	SCAT50 x STA16U - 170	170	100	30	42	SCAT50 x STA1	STA1 - UT16 - 100	3.62
44.795.20U.125	SCAT50 x STA20U - 125	125	30	36	58	SCAT50 x STA2	STA2 - UT20 - 30	3.83
44.795.20U.165	SCAT50 x STA20U - 165	165	70	36	58	SCAT50 x STA2	STA2 - UT20 - 70	4.03
44.795.20U.195	SCAT50 x STA20U - 195	195	100	36	58	SCAT50 x STA2	STA2 - UT20 - 100	4.16
44.795.25U.130	SCAT50 x STA25U - 130	130	35	42	58	SCAT50 x STA2	STA2 - UT25 - 35	3.83
44.795.25U.180	SCAT50 x STA25U - 180	180	85	42	58	SCAT50 x STA2	STA2 - UT25 - 85	4.18
44.795.25U.210	SCAT50 x STA25U - 210	210	115	42	58	SCAT50 x STA2	STA2 - UT25 - 115	4.43
44.795.32U.145	SCAT50 x STA32U - 145	145	50	48	58	SCAT50 x STA2	STA2 - UT32 - 50	3.88
44.795.32U.180	SCAT50 x STA32U - 180	180	85	48	58	SCAT50 x STA2	STA2 - UT32 - 85	4.13
44.795.32U.210	SCAT50 x STA32U - 210	210	115	48	58	SCAT50 x STA2	STA2 - UT32 - 115	4.33

**Product information:**

► AD+B type is available, please inform us when making an order.

**Standard Accessory: • NUT**

Collet	Nut	Pull Stud	Spanner
P.W-6~9	P.W-41	P.W-56	P.W-62~67



# SCAT / STA SYNCHRONIZED TAPPING HOLDER



SCAT / STA 法蘭加厚型同步補償攻牙刀桿

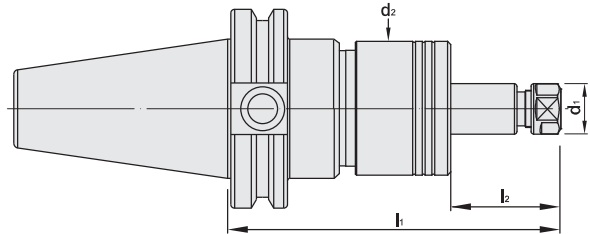

T W PAT NO. M520427  
J P PAT NO. 3203456  
D E PAT NO. Nr.202016100106

MODEL NO.	TYPE	l <sub>1</sub>	l <sub>2</sub>	d <sub>1</sub>	d <sub>2</sub>	COMBINATION		WEIGHT (KGS)
						BODY	TAP ADAPTER	
43.795.11E.140	SCAT40 x STA11E - 140	140	70	19	42	SCAT40 x STA1	STA1 - ER11A - 70	1.48
43.795.16E.095	SCAT40 x STA16E - 95	95	25	28	42	SCAT40 x STA1	STA1 - ER16A - 25	1.22
43.795.16E.140	SCAT40 x STA16E - 140	140	70	28	42	SCAT40 x STA1	STA1 - ER16A - 70	1.42
43.795.16E.220	SCAT40 x STA16E - 220	220	150	28	42	SCAT40 x STA1	STA1 - ER16A - 150	1.75
43.795.20E.104	SCAT40 x STA20E - 104	104	34	34	42	SCAT40 x STA1	STA1 - ER20A - 34	1.26
43.795.20E.140	SCAT40 x STA20E - 140	140	70	34	42	SCAT40 x STA1	STA1 - ER20A - 70	1.42
43.795.32E.130	SCAT40 x STA32E - 130	130	40	50	58	SCAT40 x STA2	STA2 - ER32 - 40	1.89
43.795.32E.160	SCAT40 x STA32E - 160	160	70	50	58	SCAT40 x STA2	STA2 - ER32 - 70	2.12
44.795.11E.140	SCAT50 x STA11E - 140	140	70	19	42	SCAT50 x STA1	STA1 - ER11A - 70	3.48
44.795.16E.095	SCAT50 x STA16E - 95	95	25	28	42	SCAT50 x STA1	STA1 - ER16A - 25	3.22
44.795.16E.140	SCAT50 x STA16E - 140	140	70	28	42	SCAT50 x STA1	STA1 - ER16A - 70	3.42
44.795.16E.220	SCAT50 x STA16E - 220	220	150	28	42	SCAT50 x STA1	STA1 - ER16A - 150	3.75
44.795.20E.104	SCAT50 x STA20E - 104	104	34	34	42	SCAT50 x STA1	STA1 - ER20A - 34	3.26
44.795.20E.140	SCAT50 x STA20E - 140	140	70	34	42	SCAT50 x STA1	STA1 - ER20A - 70	3.42
44.795.32E.135	SCAT50 x STA32E - 135	135	40	50	58	SCAT50 x STA2	STA2 - ER32 - 40	3.97
44.795.32E.165	SCAT50 x STA32E - 165	165	70	50	58	SCAT50 x STA2	STA2 - ER32 - 70	4.20

## Product information:

- ▶ AD+B type is available, please inform us when making an order.

## Standard Accessory: • NUT

Collet	Nut	Pull Stud	Spanner
P.W-6~24	P.W-42	P.W-56	P.W-62~65

# SDAT / STA SYNCHRONIZED TAPPING HOLDER



SDAT / STA 法蘭加厚型同步補償攻牙刀桿

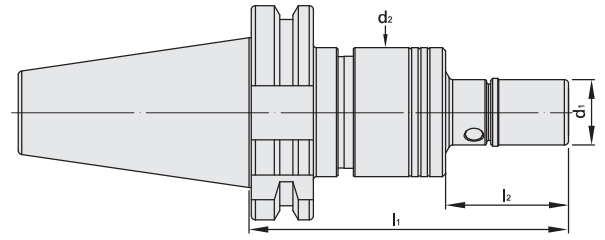

T W PAT NO. M520427  
 J P PAT NO. 3203456  
 D E PAT NO. Nr.202016100106

MODEL NO.	TYPE	l <sub>1</sub>	l <sub>2</sub>	d <sub>1</sub>	d <sub>2</sub>	COMBINATION		WEIGHT (KGS)
						BODY	TAP ADAPTER	
66.795.08T.090	SDAT40 x STA8T - 90	90	30	12	42	SDAT40 x STA1	STA1 - PTER8 - 30	1.13
66.795.08T.130	SDAT40 x STA8T - 130	130	70	12	42	SDAT40 x STA1	STA1 - PTER8 - 70	1.19
66.795.08T.160	SDAT40 x STA8T - 160	160	100	12	42	SDAT40 x STA1	STA1 - PTER8 - 100	1.24
66.795.11T.090	SDAT40 x STA11T - 90	90	30	16	42	SDAT40 x STA1	STA1 - PTER11 - 30	1.58
66.795.11T.130	SDAT40 x STA11T - 130	130	70	16	42	SDAT40 x STA1	STA1 - PTER11 - 70	1.64
66.795.11T.160	SDAT40 x STA11T - 160	160	100	16	42	SDAT40 x STA1	STA1 - PTER11 - 100	1.68
66.795.16T.090	SDAT40 x STA16T - 90	90	30	22	42	SDAT40 x STA1	STA1 - PTER16 - 30	1.59
66.795.16T.130	SDAT40 x STA16T - 130	130	70	22	42	SDAT40 x STA1	STA1 - PTER16 - 70	1.65
66.795.16T.160	SDAT40 x STA16T - 160	160	100	22	42	SDAT40 x STA1	STA1 - PTER16 - 100	1.69
66.795.20T.090	SDAT40 x STA20T - 90	90	30	28	42	SDAT40 x STA1	STA1 - PTER20 - 30	1.56
66.795.20T.130	SDAT40 x STA20T - 130	130	70	28	42	SDAT40 x STA1	STA1 - PTER20 - 70	1.83
66.795.20T.160	SDAT40 x STA20T - 160	160	100	28	42	SDAT40 x STA1	STA1 - PTER20 - 100	1.99
66.795.25T.120	SDAT40 x STA25T - 120	120	30	35	58	SDAT40 x STA2	STA2 - PTER25 - 30	2.05
66.795.25T.160	SDAT40 x STA25T - 160	160	70	35	58	SDAT40 x STA2	STA2 - PTER25 - 70	2.32
66.795.25T.190	SDAT40 x STA25T - 190	190	100	35	58	SDAT40 x STA2	STA2 - PTER25 - 100	2.48
67.795.08T.100	SDAT50 x STA8T - 100	100	30	12	42	SDAT50 x STA1	STA1 - PTER8 - 30	2.85
67.795.08T.140	SDAT50 x STA8T - 140	140	70	12	42	SDAT50 x STA1	STA1 - PTER8 - 70	2.91
67.795.08T.170	SDAT50 x STA8T - 170	170	100	12	42	SDAT50 x STA1	STA1 - PTER8 - 100	2.96
67.795.11T.100	SDAT50 x STA11T - 100	100	30	16	42	SDAT50 x STA1	STA1 - PTER11 - 30	3.30
67.795.11T.140	SDAT50 x STA11T - 140	140	70	16	42	SDAT50 x STA1	STA1 - PTER11 - 70	3.36
67.795.11T.170	SDAT50 x STA11T - 170	170	100	16	42	SDAT50 x STA1	STA1 - PTER11 - 100	3.40
67.795.16T.100	SDAT50 x STA16T - 100	100	30	22	42	SDAT50 x STA1	STA1 - PTER16 - 30	3.31
67.795.16T.140	SDAT50 x STA16T - 140	140	70	22	42	SDAT50 x STA1	STA1 - PTER16 - 70	3.37
67.795.16T.170	SDAT50 x STA16T - 170	170	100	22	42	SDAT50 x STA1	STA1 - PTER16 - 100	3.41
67.795.20T.100	SDAT50 x STA20T - 100	100	30	28	42	SDAT50 x STA1	STA1 - PTER20 - 30	3.28
67.795.20T.140	SDAT50 x STA20T - 140	140	70	28	42	SDAT50 x STA1	STA1 - PTER20 - 70	3.55
67.795.20T.170	SDAT50 x STA20T - 170	170	100	28	42	SDAT50 x STA1	STA1 - PTER20 - 100	3.71
67.795.25T.110	SDAT50 x STA25T - 110	110	30	35	58	SDAT50 x STA2	STA2 - PTER25 - 30	3.66
67.795.25T.150	SDAT50 x STA25T - 150	150	70	35	58	SDAT50 x STA2	STA2 - PTER25 - 70	3.93
67.795.25T.180	SDAT50 x STA25T - 180	180	100	35	58	SDAT50 x STA2	STA2 - PTER25 - 100	4.09

**Product information:**

► AD+B type is available, please inform us when making an order.

**Standard Accessory: • NUT**

Collet	Nut	Pull Stud	Spanner
P.W-4	P.W-41	P.W-57	P.W-62~67



# SDAT / STA SYNCHRONIZED TAPPING HOLDER



## SDAT / STA 法蘭加厚型同步補償攻牙刀桿

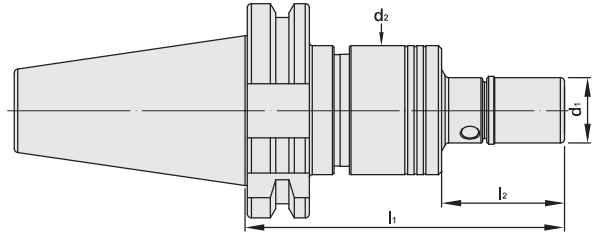

T W PAT NO. M520427  
J P PAT NO. 3203456  
D E PAT NO. Nr.202016100106

MODEL NO.	TYPE	l <sub>1</sub>	l <sub>2</sub>	d <sub>1</sub>	d <sub>2</sub>	COMBINATION		WEIGHT (KGS)
						BODY	TAP ADAPTER	
66.795.16U.100	SDAT40 x STA16U- 100	100	30	30	42	SDAT40 x STA1	STA1 - UT16 - 30	1.16
66.795.16U.140	SDAT40 x STA16U - 140	140	70	30	42	SDAT40 x STA1	STA1 - UT16 - 70	1.31
66.795.16U.170	SDAT40 x STA16U - 170	170	100	30	42	SDAT40 x STA1	STA1 - UT16 - 100	1.51
66.795.20U.120	SDAT40 x STA20U - 120	120	30	36	58	SDAT40 x STA2	STA2 - UT20 - 30	1.80
66.795.20U.160	SDAT40 x STA20U - 160	160	70	36	58	SDAT40 x STA2	STA2 - UT20 - 70	2.00
66.795.20U.190	SDAT40 x STA20U - 190	190	100	36	58	SDAT40 x STA2	STA2 - UT20 - 100	2.13
66.795.25U.125	SDAT40 x STA25U - 125	125	35	42	58	SDAT40 x STA2	STA2 - UT25 - 35	1.80
66.795.25U.175	SDAT40 x STA25U - 175	175	85	42	58	SDAT40 x STA2	STA2 - UT25 - 85	2.15
66.795.25U.205	SDAT40 x STA25U - 205	205	115	42	58	SDAT40 x STA2	STA2 - UT25 - 115	2.40
66.795.32U.140	SDAT40 x STA32U - 140	140	50	48	58	SDAT40 x STA2	STA2 - UT32 - 50	1.85
66.795.32U.175	SDAT40 x STA32U - 175	175	85	48	58	SDAT40 x STA2	STA2 - UT32 - 85	2.10
66.795.32U.205	SDAT40 x STA32U - 205	205	115	48	58	SDAT40 x STA2	STA2 - UT32 - 115	2.30
67.795.16U.090	SDAT50 x STA16U - 90	90	30	30	42	SDAT50 x STA1	STA1 - UT16 - 30	2.88
67.795.16U.130	SDAT50 x STA16U - 130	130	70	30	42	SDAT50 x STA1	STA1 - UT16 - 70	3.03
67.795.16U.160	SDAT50 x STA16U - 160	160	100	30	42	SDAT50 x STA1	STA1 - UT16 - 100	3.23
67.795.20U.110	SDAT50 x STA20U - 110	110	30	36	58	SDAT50 x STA2	STA2 - UT20 - 30	3.41
67.795.20U.150	SDAT50 x STA20U - 150	150	70	36	58	SDAT50 x STA2	STA2 - UT20 - 70	3.61
67.795.20U.180	SDAT50 x STA20U - 180	180	100	36	58	SDAT50 x STA2	STA2 - UT20 - 100	3.74
67.795.25U.115	SDAT50 x STA25U - 115	115	35	42	58	SDAT50 x STA2	STA2 - UT25 - 35	3.41
67.795.25U.165	SDAT50 x STA25U - 165	165	85	42	58	SDAT50 x STA2	STA2 - UT25 - 85	3.76
67.795.25U.195	SDAT50 x STA25U - 195	195	115	42	58	SDAT50 x STA2	STA2 - UT25 - 115	4.01
67.795.32U.130	SDAT50 x STA32U - 130	130	50	48	58	SDAT50 x STA2	STA2 - UT32 - 50	3.46
67.795.32U.165	SDAT50 x STA32U - 165	165	85	48	58	SDAT50 x STA2	STA2 - UT32 - 85	3.71
67.795.32U.195	SDAT50 x STA32U - 195	195	115	48	58	SDAT50 x STA2	STA2 - UT32 - 115	3.91

### Product information:

- ▶ AD+B type is available, please inform us when making an order.

### Standard Accessory: • NUT

Collet	Nut	Pull Stud	Spanner
P.W-6~9	P.W-41	P.W-57	P.W-62~67

# SDAT / STA SYNCHRONIZED TAPPING HOLDER



SDAT / STA 法蘭加厚型同步補償攻牙刀桿

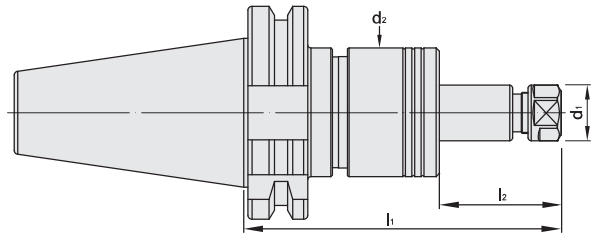

T W PAT NO. M520427  
 J P PAT NO. 3203456  
 D E PAT NO. Nr.202016100106

MODEL NO.	TYPE	l <sub>1</sub>	l <sub>2</sub>	d <sub>1</sub>	d <sub>2</sub>	COMBINATION		WEIGHT (KGS)
						BODY	TAP ADAPTER	
66.795.11E.130	SDAT40 x STA11E - 130	130	70	19	42	SDAT40 x STA1	STA1 - ER11A - 70	1.37
66.795.16E.085	SDAT40 x STA16E - 85	85	25	28	42	SDAT40 x STA1	STA1 - ER16A - 25	1.11
66.795.16E.130	SDAT40 x STA16E - 130	130	70	28	42	SDAT40 x STA1	STA1 - ER16A - 70	1.31
66.795.16E.210	SDAT40 x STA16E - 210	210	150	28	58	SDAT40 x STA2	STA1 - ER16A - 150	2.13
66.795.20E.094	SDAT40 x STA20E - 94	94	34	34	58	SDAT40 x STA2	STA1 - ER20A - 34	1.64
66.795.20E.130	SDAT40 x STA20E - 130	130	70	34	58	SDAT40 x STA2	STA1 - ER20A - 70	1.80
66.795.32E.130	SDAT40 x STA32E - 130	130	40	50	58	SDAT40 x STA2	STA2 - ER32 - 40	1.94
66.795.32E.160	SDAT40 x STA32E - 160	160	70	50	58	SDAT40 x STA2	STA2 - ER32 - 70	2.17
67.795.11E.130	SDAT50 x STA11E - 130	130	70	19	58	SDAT40 x STA2	STA1 - ER11A - 70	1.86
67.795.16E.085	SDAT50 x STA16E - 85	85	25	28	58	SDAT40 x STA2	STA1 - ER16A - 25	1.60
67.795.16E.130	SDAT50 x STA16E - 130	130	70	28	58	SDAT40 x STA2	STA1 - ER16A - 70	1.80
67.795.16E.210	SDAT50 x STA16E - 210	210	150	28	58	SDAT40 x STA2	STA1 - ER16A - 150	2.13
67.795.20E.094	SDAT50 x STA20E - 94	94	34	34	42	SDAT50 x STA1	STA1 - ER20A - 34	2.87
67.795.20E.130	SDAT50 x STA20E - 130	130	70	34	42	SDAT50 x STA1	STA1 - ER20A - 70	3.03
67.795.32E.120	SDAT50 x STA32E - 120	120	40	50	42	SDAT50 x STA1	STA2 - ER32 - 40	3.17
67.795.32E.150	SDAT50 x STA32E - 150	150	70	50	58	SDAT50 x STA2	STA2 - ER32 - 70	3.78

**Product information:**

► AD+B type is available, please inform us when making an order.

**Standard Accessory: • NUT**

Collet	Nut	Pull Stud	Spanner
P.W-6~24	P.W-42	P.W-57	P.W-62~65



# HSK / STA SYNCHRONIZED TAPPING HOLDER



## HSK / STA 同步補償攻牙刀桿

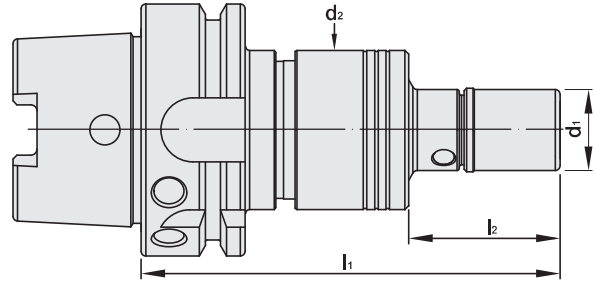

T W PAT NO. M520427  
J P PAT NO. 3203456  
D E PAT NO. Nr.202016100106

MODEL NO.	TYPE	l <sub>1</sub>	l <sub>2</sub>	d <sub>1</sub>	d <sub>2</sub>	COMBINATION		WEIGHT (KGS)
						BODY	TAP ADAPTER	
71.795.08T.100	HSK40A x STA8T - 100	100	30	12	42	HSK40A x STA1	STA1 - PTER8 - 30	1.22
71.795.08T.140	HSK40A x STA8T - 140	140	70	12	42	HSK40A x STA1	STA1 - PTER8 - 70	1.28
71.795.08T.170	HSK40A x STA8T - 170	170	100	12	42	HSK40A x STA1	STA1 - PTER8 - 100	1.33
71.795.11T.100	HSK40A x STA11T - 100	100	30	16	42	HSK40A x STA1	STA1 - PTER11 - 30	1.67
71.795.11T.140	HSK40A x STA11T - 140	140	70	16	42	HSK40A x STA1	STA1 - PTER11 - 70	1.73
71.795.11T.170	HSK40A x STA11T - 170	170	100	16	42	HSK40A x STA1	STA1 - PTER11 - 100	1.77
71.795.16T.100	HSK40A x STA16T - 100	100	30	22	42	HSK40A x STA1	STA1 - PTER16 - 30	1.68
71.795.16T.140	HSK40A x STA16T - 140	140	70	22	42	HSK40A x STA1	STA1 - PTER16 - 70	1.74
71.795.16T.170	HSK40A x STA16T - 170	170	100	22	42	HSK40A x STA1	STA1 - PTER16 - 100	1.78
71.795.20T.100	HSK40A x STA20T - 100	100	30	28	42	HSK40A x STA1	STA1 - PTER20 - 30	1.65
71.795.20T.140	HSK40A x STA20T - 140	140	70	28	42	HSK40A x STA1	STA1 - PTER20 - 70	1.92
71.795.20T.170	HSK40A x STA20T - 170	170	100	28	42	HSK40A x STA1	STA1 - PTER20 - 100	2.08
72.795.08T.100	HSK50A x STA8T - 100	100	30	12	42	HSK50A x STA1	STA1 - PTER8 - 30	1.43
72.795.08T.140	HSK50A x STA8T - 140	140	70	12	42	HSK50A x STA1	STA1 - PTER8 - 70	1.49
72.795.08T.170	HSK50A x STA8T - 170	170	100	12	42	HSK50A x STA1	STA1 - PTER8 - 100	1.54
72.795.11T.100	HSK50A x STA11T - 100	100	30	16	42	HSK50A x STA1	STA1 - PTER11 - 30	1.88
72.795.11T.140	HSK50A x STA11T - 140	140	70	16	42	HSK50A x STA1	STA1 - PTER11 - 70	1.94
72.795.11T.170	HSK50A x STA11T - 170	170	100	16	42	HSK50A x STA1	STA1 - PTER11 - 100	1.98
72.795.16T.100	HSK50A x STA16T - 100	100	30	22	42	HSK50A x STA1	STA1 - PTER16 - 30	1.89
72.795.16T.140	HSK50A x STA16T - 140	140	70	22	42	HSK50A x STA1	STA1 - PTER16 - 70	1.95
72.795.16T.170	HSK50A x STA16T - 170	170	100	22	42	HSK50A x STA1	STA1 - PTER16 - 100	1.99
72.795.20T.100	HSK50A x STA20T - 100	100	30	28	42	HSK50A x STA1	STA1 - PTER20 - 30	1.86
72.795.20T.140	HSK50A x STA20T - 140	140	70	28	42	HSK50A x STA1	STA1 - PTER20 - 70	2.13
72.795.20T.170	HSK50A x STA20T - 170	170	100	28	42	HSK50A x STA1	STA1 - PTER20 - 100	2.29
73.795.08T.110	HSK63A x STA8T - 110	110	30	12	42	HSK63A x STA1	STA1 - PTER8 - 30	1.43
73.795.08T.150	HSK63A x STA8T - 150	150	70	12	42	HSK63A x STA1	STA1 - PTER8 - 70	1.49
73.795.08T.180	HSK63A x STA8T - 180	180	100	12	42	HSK63A x STA1	STA1 - PTER8 - 100	1.54
73.795.11T.110	HSK63A x STA11T - 110	110	30	16	42	HSK63A x STA1	STA1 - PTER11 - 30	1.88
73.795.11T.150	HSK63A x STA11T - 150	150	70	16	42	HSK63A x STA1	STA1 - PTER11 - 70	1.94
73.795.11T.180	HSK63A x STA11T - 180	180	100	16	42	HSK63A x STA1	STA1 - PTER11 - 100	1.98
73.795.16T.110	HSK63A x STA16T - 110	110	30	22	42	HSK63A x STA1	STA1 - PTER16 - 30	1.89
73.795.16T.150	HSK63A x STA16T - 150	150	70	22	42	HSK63A x STA1	STA1 - PTER16 - 70	1.95
73.795.16T.180	HSK63A x STA16T - 180	180	100	22	42	HSK63A x STA1	STA1 - PTER16 - 100	1.99
73.795.20T.110	HSK63A x STA20T - 110	110	30	28	42	HSK63A x STA1	STA1 - PTER20 - 30	1.86
73.795.20T.150	HSK63A x STA20T - 150	150	70	28	42	HSK63A x STA1	STA1 - PTER20 - 70	2.13
73.795.20T.180	HSK63A x STA20T - 180	180	100	28	42	HSK63A x STA1	STA1 - PTER20 - 100	2.29

### Standard Accessory: • NUT

Collet	Nut	Coolant Supply Unit	Key	Spanner
P.W-4	P.W-41	P.W-60	P.W-60	P.W-62~67

# HSK / STA SYNCHRONIZED TAPPING HOLDER



## HSK / STA 同步補償攻牙刀桿

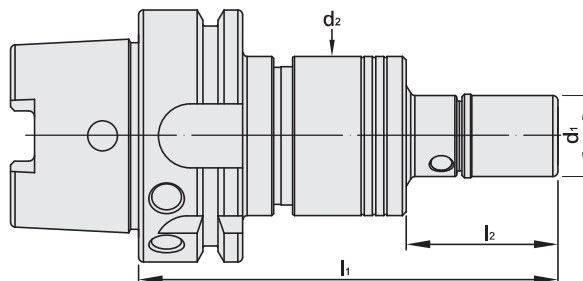

T W PAT NO. M520427  
J P PAT NO. 3203456  
D E PAT NO. Nr.202016100106

MODEL NO.	TYPE	l <sub>1</sub>	l <sub>2</sub>	d <sub>1</sub>	d <sub>2</sub>	COMBINATION		WEIGHT (KGS)
						BODY	TAP ADAPTER	
74.795.08T.110	HSK80A x STA8T - 110	110	30	12	42	HSK80A x STA1	STA1 - PTER8 - 30	2.10
74.795.08T.150	HSK80A x STA8T - 150	150	70	12	42	HSK80A x STA1	STA1 - PTER8 - 70	2.16
74.795.08T.180	HSK80A x STA8T - 180	180	100	12	42	HSK80A x STA1	STA1 - PTER8 - 100	2.21
74.795.11T.110	HSK80A x STA11T - 110	110	30	16	42	HSK80A x STA1	STA1 - PTER11 - 30	2.55
74.795.11T.150	HSK80A x STA11T - 150	150	70	16	42	HSK80A x STA1	STA1 - PTER11 - 70	2.61
74.795.11T.180	HSK80A x STA11T - 180	180	100	16	42	HSK80A x STA1	STA1 - PTER11 - 100	2.65
74.795.16T.110	HSK80A x STA16T - 110	110	30	22	42	HSK80A x STA1	STA1 - PTER16 - 30	2.56
74.795.16T.150	HSK80A x STA16T - 150	150	70	22	42	HSK80A x STA1	STA1 - PTER16 - 70	2.62
74.795.16T.180	HSK80A x STA16T - 180	180	100	22	42	HSK80A x STA1	STA1 - PTER16 - 100	2.66
74.795.20T.110	HSK80A x STA20T - 110	110	30	28	42	HSK80A x STA1	STA1 - PTER20 - 30	2.53
74.795.20T.150	HSK80A x STA20T - 150	150	70	28	42	HSK80A x STA1	STA1 - PTER20 - 70	2.80
74.795.20T.180	HSK80A x STA20T - 180	180	100	28	42	HSK80A x STA1	STA1 - PTER20 - 100	2.96
74.795.25T.125	HSK80A x STA25T - 125	125	30	35	58	HSK80A x STA2	STA2 - PTER25 - 30	3.35
74.795.25T.165	HSK80A x STA25T - 165	165	70	35	58	HSK80A x STA2	STA2 - PTER25 - 70	3.62
74.795.25T.195	HSK80A x STA25T - 195	195	100	35	58	HSK80A x STA2	STA2 - PTER25 - 100	3.78
75.795.08T.110	HSK100A x STA8T - 110	110	30	12	42	HSK100A x STA1	STA1 - PTER8 - 30	2.90
75.795.08T.150	HSK100A x STA8T - 150	150	70	12	42	HSK100A x STA1	STA1 - PTER8 - 70	2.96
75.795.08T.180	HSK100A x STA8T - 180	180	100	12	42	HSK100A x STA1	STA1 - PTER8 - 100	3.01
75.795.11T.110	HSK100A x STA11T - 110	110	30	16	42	HSK100A x STA1	STA1 - PTER11 - 30	3.35
75.795.11T.150	HSK100A x STA11T - 150	150	70	16	42	HSK100A x STA1	STA1 - PTER11 - 70	3.41
75.795.11T.180	HSK100A x STA11T - 180	180	100	16	42	HSK100A x STA1	STA1 - PTER11 - 100	3.45
75.795.16T.110	HSK100A x STA16T - 110	110	30	22	42	HSK100A x STA1	STA1 - PTER16 - 30	3.36
75.795.16T.150	HSK100A x STA16T - 150	150	70	22	42	HSK100A x STA1	STA1 - PTER16 - 70	3.42
75.795.16T.180	HSK100A x STA16T - 180	180	100	22	42	HSK100A x STA1	STA1 - PTER16 - 100	3.46
75.795.20T.110	HSK100A x STA20T - 110	110	30	28	42	HSK100A x STA1	STA1 - PTER20 - 30	3.33
75.795.20T.150	HSK100A x STA20T - 150	150	70	28	42	HSK100A x STA1	STA1 - PTER20 - 70	3.60
75.795.20T.180	HSK100A x STA20T - 180	180	100	28	42	HSK100A x STA1	STA1 - PTER20 - 100	3.76
75.795.25T.125	HSK100A x STA25T - 125	125	30	35	58	HSK100A x STA2	STA2 - PTER25 - 30	4.15
75.795.25T.165	HSK100A x STA25T - 165	165	70	35	58	HSK100A x STA2	STA2 - PTER25 - 70	4.42
75.795.25T.195	HSK100A x STA25T - 195	195	100	35	58	HSK100A x STA2	STA2 - PTER25 - 100	4.58

### Standard Accessory: • NUT

Collet	Nut	Coolant Supply Unit	Key	Spanner
P.W-4	P.W-41	P.W-60	P.W-60	P.W-62~67



# HSK / STA SYNCHRONIZED TAPPING HOLDER



## HSK / STA 同步補償攻牙刀桿

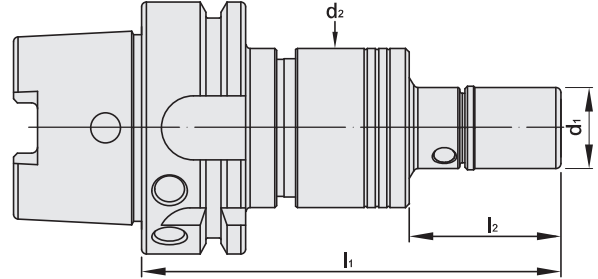

T W PAT NO. M520427  
J P PAT NO. 3203456  
D E PAT NO. Nr.202016100106

MODEL NO.	TYPE	l <sub>1</sub>	l <sub>2</sub>	d <sub>1</sub>	d <sub>2</sub>	COMBINATION		WEIGHT (KGS)
						BODY	TAP ADAPTER	
71.795.16U.100	HSK40A x STA16U - 100	100	30	30	42	HSK40A x STA1	STA1 - UT16 - 30	1.25
71.795.16U.140	HSK40A x STA16U - 140	140	70	30	42	HSK40A x STA1	STA1 - UT16 - 70	1.40
71.795.16U.170	HSK40A x STA16U - 170	170	100	30	42	HSK40A x STA1	STA1 - UT16 - 100	1.60
72.795.16U.100	HSK50A x STA16U - 100	100	30	30	42	HSK50A x STA1	STA1 - UT16 - 30	1.46
72.795.16U.140	HSK50A x STA16U - 140	140	70	30	42	HSK50A x STA1	STA1 - UT16 - 70	1.61
72.795.16U.170	HSK50A x STA16U - 170	170	100	30	42	HSK50A x STA1	STA1 - UT16 - 100	1.81
73.795.16U.120	HSK63A x STA16U - 120	120	30	30	42	HSK63A x STA1	STA1 - UT16 - 30	1.75
73.795.16U.160	HSK63A x STA16U - 160	160	70	30	42	HSK63A x STA1	STA1 - UT16 - 70	1.90
73.795.16U.190	HSK63A x STA16U - 190	190	100	30	42	HSK63A x STA1	STA1 - UT16 - 100	2.10
74.795.16U.110	HSK80A x STA16U - 110	110	30	30	58	HSK80A x STA1	STA1 - UT16 - 30	2.13
74.795.16U.150	HSK80A x STA16U - 150	150	70	30	58	HSK80A x STA1	STA1 - UT16 - 70	2.28
74.795.16U.180	HSK80A x STA16U - 180	180	100	30	58	HSK80A x STA1	STA1 - UT16 - 100	2.48
74.795.20U.125	HSK80A x STA20U - 125	125	30	36	58	HSK80A x STA2	STA2 - UT20 - 30	3.10
74.795.20U.165	HSK80A x STA20U - 165	165	70	36	58	HSK80A x STA2	STA2 - UT20 - 70	3.30
74.795.20U.195	HSK80A x STA20U - 195	195	100	36	58	HSK80A x STA2	STA2 - UT20 - 100	3.43
74.795.25U.130	HSK80A x STA25U - 130	130	35	42	58	HSK80A x STA2	STA2 - UT25 - 35	3.10
74.795.25U.180	HSK80A x STA25U - 180	180	85	42	58	HSK80A x STA2	STA2 - UT25 - 85	3.45
74.795.25U.210	HSK80A x STA25U - 210	210	115	42	58	HSK80A x STA2	STA2 - UT25 - 115	3.70
74.795.32U.145	HSK80A x STA32U - 145	145	50	48	58	HSK80A x STA2	STA2 - UT32 - 50	3.15
74.795.32U.180	HSK80A x STA32U - 180	180	85	48	58	HSK80A x STA2	STA2 - UT32 - 85	3.40
74.795.32U.210	HSK80A x STA32U - 210	210	115	48	58	HSK80A x STA2	STA2 - UT32 - 115	3.60
75.795.16U.110	HSK100A x STA16U - 110	110	30	30	42	HSK100A x STA1	STA1 - UT16 - 30	2.93
75.795.16U.150	HSK100A x STA16U - 150	150	70	30	42	HSK100A x STA1	STA1 - UT16 - 70	3.08
75.795.16U.180	HSK100A x STA16U - 180	180	100	30	42	HSK100A x STA1	STA1 - UT16 - 100	3.28
75.795.20U.125	HSK100A x STA20U - 125	125	30	36	58	HSK100A x STA2	STA2 - UT20 - 30	3.90
75.795.20U.165	HSK100A x STA20U - 165	165	70	36	58	HSK100A x STA2	STA2 - UT20 - 70	4.10
75.795.20U.195	HSK100A x STA20U - 195	195	100	36	58	HSK100A x STA2	STA2 - UT20 - 100	4.23
75.795.25U.130	HSK100A x STA25U - 130	130	35	42	58	HSK100A x STA2	STA2 - UT25 - 35	3.90
75.795.25U.180	HSK100A x STA25U - 180	180	85	42	58	HSK100A x STA2	STA2 - UT25 - 85	4.25
75.795.25U.210	HSK100A x STA25U - 210	210	115	42	58	HSK100A x STA2	STA2 - UT25 - 115	4.50
75.795.32U.145	HSK100A x STA32U - 145	145	50	48	58	HSK100A x STA2	STA2 - UT32 - 50	3.95
75.795.32U.180	HSK100A x STA32U - 180	180	85	48	58	HSK100A x STA2	STA2 - UT32 - 85	4.20
75.795.32U.210	HSK100A x STA32U - 210	210	115	48	58	HSK100A x STA2	STA2 - UT32 - 115	4.40

### Standard Accessory: • NUT

Collet	Nut	Coolant Supply Unit	Key	Spanner
P.W-6~9	P.W-41	P.W-60	P.W-60	P.W-62~67



# HSK / STA SYNCHRONIZED TAPPING HOLDER



## HSK / STA 同步補償攻牙刀桿

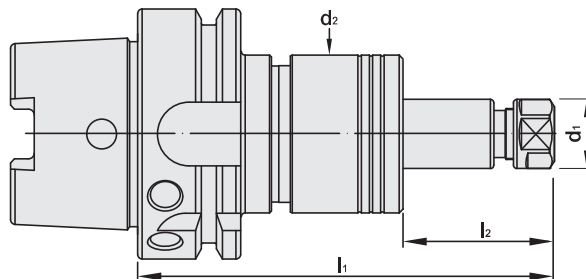

T W PAT NO. M520427  
J P PAT NO. 3203456  
D E PAT NO. Nr.202016100106

MODEL NO.	TYPE	l <sub>1</sub>	l <sub>2</sub>	d <sub>1</sub>	d <sub>2</sub>	COMBINATION		WEIGHT (KGS)
						BODY	TAP ADAPTER	
71.795.11E.140	HSK40A x STA11E - 140	140	70	19	42	HSK40A x STA1	STA1 - ER11A - 70	1.46
71.795.16E.095	HSK40A x STA16E - 95	95	25	28	42	HSK40A x STA1	STA1 - ER16A - 25	1.20
71.795.16E.140	HSK40A x STA16E - 140	140	70	28	42	HSK40A x STA1	STA1 - ER16A - 70	1.40
71.795.16E.220	HSK40A x STA16E - 220	220	150	28	42	HSK40A x STA1	STA1 - ER16A - 150	1.73
71.795.20E.104	HSK40A x STA20E - 104	104	34	34	42	HSK40A x STA1	STA1 - ER20A - 34	1.24
71.795.20E.140	HSK40A x STA20E - 140	140	70	34	42	HSK40A x STA1	STA1 - ER20A - 70	1.40
72.795.11E.140	HSK50A x STA11E - 140	140	70	19	42	HSK50A x STA1	STA1 - ER11A - 70	1.67
72.795.16E.095	HSK50A x STA16E - 95	95	25	28	42	HSK50A x STA1	STA1 - ER16A - 25	1.41
72.795.16E.140	HSK50A x STA16E - 140	140	70	28	42	HSK50A x STA1	STA1 - ER16A - 70	1.61
72.795.16E.220	HSK50A x STA16E - 220	220	150	28	42	HSK50A x STA1	STA1 - ER16A - 150	1.94
72.795.20E.104	HSK50A x STA20E - 104	104	34	34	42	HSK50A x STA1	STA1 - ER20A - 34	1.45
72.795.20E.140	HSK50A x STA20E - 140	140	70	34	42	HSK50A x STA1	STA1 - ER20A - 70	1.61
73.795.11E.150	HSK63A x STA11E - 150	150	70	19	42	HSK63A x STA1	STA1 - ER11A - 70	1.96
73.795.16E.105	HSK63A x STA16E - 105	105	25	28	42	HSK63A x STA1	STA1 - ER16A - 25	1.70
73.795.16E.150	HSK63A x STA16E - 150	150	70	28	42	HSK63A x STA1	STA1 - ER16A - 70	1.90
73.795.16E.230	HSK63A x STA16E - 230	230	150	28	42	HSK63A x STA1	STA1 - ER16A - 150	2.23
73.795.20E.114	HSK63A x STA20E - 114	114	34	34	42	HSK63A x STA1	STA1 - ER20A - 34	1.74
73.795.20E.150	HSK63A x STA20E - 150	150	70	34	42	HSK63A x STA1	STA1 - ER20A - 70	1.90
74.795.11E.150	HSK80A x STA11E - 150	150	70	19	42	HSK80A x STA1	STA1 - ER11A - 70	2.34
74.795.16E.115	HSK80A x STA16E - 115	115	25	28	42	HSK80A x STA1	STA1 - ER16A - 25	2.08
74.795.16E.150	HSK80A x STA16E - 150	150	70	28	42	HSK80A x STA1	STA1 - ER16A - 70	2.28
74.795.16E.230	HSK80A x STA16E - 230	230	150	28	42	HSK80A x STA1	STA1 - ER16A - 150	2.61
74.795.20E.114	HSK80A x STA20E - 114	114	34	34	42	HSK80A x STA1	STA1 - ER20A - 34	2.12
74.795.20E.150	HSK80A x STA20E - 150	150	70	34	42	HSK80A x STA1	STA1 - ER20A - 70	2.28
74.795.32E.135	HSK80A x STA32E - 135	135	40	50	58	HSK80A x STA2	STA2 - ER32 - 40	3.24
74.795.32E.165	HSK80A x STA32E - 165	165	70	50	58	HSK80A x STA2	STA2 - ER32 - 70	3.47
75.795.11E.150	HSK100A x STA11E - 150	150	70	19	42	HSK100A x STA1	STA1 - ER11A - 70	3.14
75.795.16E.115	HSK100A x STA16E - 115	115	25	28	42	HSK100A x STA1	STA1 - ER16A - 25	2.88
75.795.16E.150	HSK100A x STA16E - 150	150	70	28	42	HSK100A x STA1	STA1 - ER16A - 70	3.08
75.795.16E.220	HSK100A x STA16E - 220	220	150	28	42	HSK100A x STA1	STA1 - ER16A - 150	3.41
75.795.20E.114	HSK100A x STA20E - 114	114	34	34	42	HSK100A x STA1	STA1 - ER20A - 34	2.92
75.795.20E.150	HSK100A x STA20E - 150	150	70	34	42	HSK100A x STA1	STA1 - ER20A - 70	3.08
75.795.32E.135	HSK100A x STA32E - 135	135	40	50	58	HSK100A x STA2	STA2 - ER32 - 40	4.04
75.795.32E.165	HSK100A x STA32E - 165	165	70	50	58	HSK100A x STA2	STA2 - ER32 - 70	4.27

**Standard Accessory: • NUT**

Collet	Nut	Coolant Supply Unit	Key	Spanner
P.W-6~24	P.W-42	P.W-60	P.W-60	P.W-62~65



# PSC / STA SYNCHRONIZED TAPPING HOLDER



## PSC / STA 同步補償攻牙刀桿

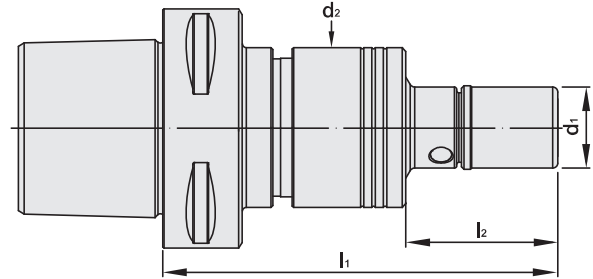

T W PAT NO. M520427  
J P PAT NO. 3203456  
D E PAT NO. Nr.202016100106

MODEL NO.	TYPE	l <sub>1</sub>	l <sub>2</sub>	d <sub>1</sub>	d <sub>2</sub>	COMBINATION		WEIGHT (KGS)
						BODY	TAP ADAPTER	
142.795.08T.110	PSC50 x STA8T - 110	110	30	12	42	PSC50 x STA1	STA1 - PTER8 - 30	1.55
142.795.08T.150	PSC50 x STA8T - 150	150	70	12	42	PSC50 x STA1	STA1 - PTER8 - 70	1.61
142.795.08T.180	PSC50 x STA8T - 180	180	100	12	42	PSC50 x STA1	STA1 - PTER8 - 100	1.66
142.795.11T.110	PSC50 x STA11T - 110	110	30	16	42	PSC50 x STA1	STA1 - PTER11 - 30	2.00
142.795.11T.150	PSC50 x STA11T - 150	150	70	16	42	PSC50 x STA1	STA1 - PTER11 - 70	2.06
142.795.11T.180	PSC50 x STA11T - 180	180	100	16	42	PSC50 x STA1	STA1 - PTER11 - 100	2.10
142.795.16T.110	PSC50 x STA16T - 110	110	30	22	42	PSC50 x STA1	STA1 - PTER16 - 30	2.01
142.795.16T.150	PSC50 x STA16T - 150	150	70	22	42	PSC50 x STA1	STA1 - PTER16 - 70	2.07
142.795.16T.180	PSC50 x STA16T - 180	180	100	22	42	PSC50 x STA1	STA1 - PTER16 - 100	2.11
142.795.20T.180	PSC50 x STA20T - 110	110	30	28	42	PSC50 x STA1	STA1 - PTER20 - 30	1.98
142.795.20T.150	PSC50 x STA20T - 150	150	70	28	42	PSC50 x STA1	STA1 - PTER20 - 70	2.25
142.795.20T.180	PSC50 x STA20T - 180	180	100	28	42	PSC50 x STA1	STA1 - PTER20 - 100	2.41
143.795.08T.090	PSC63 x STA8T - 90	90	30	12	42	PSC63 x STA1	STA1 - PTER8 - 30	1.67
143.795.08T.130	PSC63 x STA8T - 130	130	70	12	42	PSC63 x STA1	STA1 - PTER8 - 70	1.73
143.795.08T.160	PSC63 x STA8T - 160	160	100	12	42	PSC63 x STA1	STA1 - PTER8 - 100	1.78
143.795.11T.090	PSC63 x STA11T - 90	90	30	16	42	PSC63 x STA1	STA1 - PTER11 - 30	2.12
143.795.11T.130	PSC63 x STA11T - 130	130	70	16	42	PSC63 x STA1	STA1 - PTER11 - 70	2.18
143.795.11T.160	PSC63 x STA11T - 160	160	100	16	42	PSC63 x STA1	STA1 - PTER11 - 100	2.22
143.795.16T.090	PSC63 x STA16T - 90	90	30	22	42	PSC63 x STA1	STA1 - PTER16 - 30	2.13
143.795.16T.130	PSC63 x STA16T - 130	130	70	22	42	PSC63 x STA1	STA1 - PTER16 - 70	2.19
143.795.16T.160	PSC63 x STA16T - 160	160	100	22	42	PSC63 x STA1	STA1 - PTER16 - 100	2.23
143.795.20T.090	PSC63 x STA20T - 90	90	30	28	42	PSC63 x STA1	STA1 - PTER20 - 30	2.10
143.795.20T.130	PSC63 x STA20T - 130	130	70	28	42	PSC63 x STA1	STA1 - PTER20 - 70	2.37
143.795.20T.160	PSC63 x STA20T - 160	160	100	28	42	PSC63 x STA1	STA1 - PTER20 - 100	2.53
143.795.25T.110	PSC63 x STA25T - 110	110	30	35	58	PSC63 x STA2	STA2 - PTER25 - 30	2.76
143.795.25T.150	PSC63 x STA25T - 150	150	70	35	58	PSC63 x STA2	STA2 - PTER25 - 70	3.03
143.795.25T.180	PSC63 x STA25T - 180	180	100	35	58	PSC63 x STA2	STA2 - PTER25 - 100	3.19

### Standard Accessory: • NUT

Collet	Nut	Spanner
P.W-4	P.W-41	P.W-62~67

# PSC / STA SYNCHRONIZED TAPPING HOLDER



## PSC / STA 同步補償攻牙刀桿

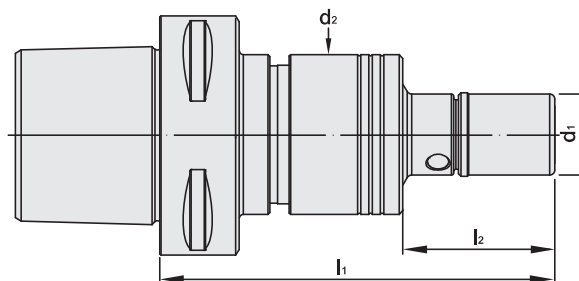

T W PAT NO. M520427  
J P PAT NO. 3203456  
D E PAT NO. Nr.202016100106

MODEL NO.	TYPE	l <sub>1</sub>	l <sub>2</sub>	d <sub>1</sub>	d <sub>2</sub>	COMBINATION		WEIGHT (KGS)
						BODY	TAP ADAPTER	
144.795.08T.095	PSC80 x STA8T - 95	95	30	12	42	PSC80 x STA1	STA1 - PTER8 - 30	3.09
144.795.08T.135	PSC80 x STA8T - 135	135	70	12	42	PSC80 x STA1	STA1 - PTER8 - 70	3.15
144.795.08T.165	PSC80 x STA8T - 165	165	100	12	42	PSC80 x STA1	STA1 - PTER8 - 100	3.20
144.795.11T.095	PSC80 x STA11T - 95	95	30	16	42	PSC80 x STA1	STA1 - PTER11 - 30	3.54
144.795.11T.135	PSC80 x STA11T - 135	135	70	16	42	PSC80 x STA1	STA1 - PTER11 - 70	3.60
144.795.11T.165	PSC80 x STA11T - 165	165	100	16	42	PSC80 x STA1	STA1 - PTER11 - 100	3.64
144.795.16T.095	PSC80 x STA16T - 95	95	30	22	42	PSC80 x STA1	STA1 - PTER16 - 30	3.55
144.795.16T.135	PSC80 x STA16T - 135	135	70	22	42	PSC80 x STA1	STA1 - PTER16 - 70	3.61
144.795.16T.165	PSC80 x STA16T - 165	165	100	22	42	PSC80 x STA1	STA1 - PTER16 - 100	3.65
144.795.20T.095	PSC80 x STA20T - 95	95	30	28	42	PSC80 x STA1	STA1 - PTER20 - 30	3.52
144.795.20T.135	PSC80 x STA20T - 135	135	70	28	42	PSC80 x STA1	STA1 - PTER20 - 70	3.79
144.795.20T.165	PSC80 x STA20T - 165	165	100	28	42	PSC80 x STA1	STA1 - PTER20 - 100	3.95
144.795.25T.115	PSC80 x STA25T - 115	115	30	35	58	PSC80 x STA2	STA2 - PTER25 - 30	3.66
144.795.25T.155	PSC80 x STA25T - 155	155	70	35	58	PSC80 x STA2	STA2 - PTER25 - 70	3.93
144.795.25T.185	PSC80 x STA25T - 185	185	100	35	58	PSC80 x STA2	STA2 - PTER25 - 100	4.09

### Standard Accessory: • NUT

Collet	Nut	Spanner
P.W-4	P.W-41	P.W-62~67



# PSC / STA SYNCHRONIZED TAPPING HOLDER



## PSC / STA 同步補償攻牙刀桿

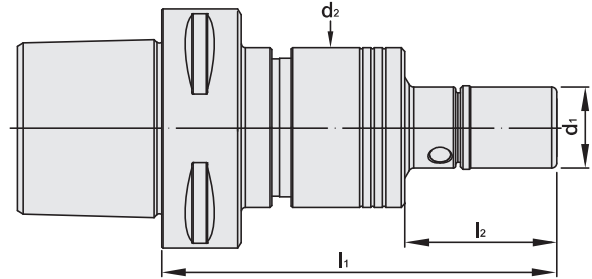

T W PAT NO. M520427  
J P PAT NO. 3203456  
D E PAT NO. Nr.202016100106

MODEL NO.	TYPE	l <sub>1</sub>	l <sub>2</sub>	d <sub>1</sub>	d <sub>2</sub>	COMBINATION		WEIGHT (KGS)
						BODY	TAP ADAPTER	
142.795.16U.110	PSC50 x STA16U - 110	110	30	30	42	PSC50 x STA1	STA1 - UT16 - 30	1.58
142.795.16U.150	PSC50 x STA16U - 150	150	70	30	42	PSC50 x STA1	STA1 - UT16 - 70	1.73
142.795.16U.180	PSC50 x STA16U - 180	180	100	30	42	PSC50 x STA1	STA1 - UT16 - 100	1.93
143.795.16U.090	PSC63 x STA16U - 90	90	30	30	42	PSC63 x STA1	STA1 - UT16 - 30	1.70
143.795.16U.130	PSC63 x STA16U - 130	130	70	30	42	PSC63 x STA1	STA1 - UT16 - 70	1.85
143.795.16U.160	PSC63 x STA16U - 160	160	100	30	42	PSC63 x STA1	STA1 - UT16 - 100	2.05
143.795.20U.110	PSC63 x STA20U - 110	110	30	36	58	PSC63 x STA2	STA2 - UT20 - 30	2.51
143.795.20U.150	PSC63 x STA20U - 150	150	70	36	58	PSC63 x STA2	STA2 - UT20 - 70	2.71
143.795.20U.180	PSC63 x STA20U - 180	180	100	36	58	PSC63 x STA2	STA2 - UT20 - 100	2.84
143.795.25U.115	PSC63 x STA25U - 115	115	35	42	58	PSC63 x STA2	STA2 - UT25 - 35	2.51
143.795.25U.165	PSC63 x STA25U - 165	165	85	42	58	PSC63 x STA2	STA2 - UT25 - 85	2.86
143.795.25U.195	PSC63 x STA25U - 195	195	115	42	58	PSC63 x STA2	STA2 - UT25 - 115	3.11
143.795.32U.130	PSC63 x STA32U - 130	130	50	48	58	PSC63 x STA2	STA2 - UT32 - 50	2.56
143.795.32U.165	PSC63 x STA32U - 165	165	85	48	58	PSC63 x STA2	STA2 - UT32 - 85	2.81
143.795.32U.195	PSC63 x STA32U - 195	195	115	48	58	PSC63 x STA2	STA2 - UT32 - 115	3.01
144.795.16U.095	PSC80 x STA16U - 95	95	30	30	42	PSC80 x STA1	STA1 - UT16 - 30	3.12
144.795.16U.135	PSC80 x STA16U - 135	135	70	30	42	PSC80 x STA1	STA1 - UT16 - 70	3.27
144.795.16U.165	PSC80 x STA16U - 165	165	100	30	42	PSC80 x STA1	STA1 - UT16 - 100	3.47
144.795.20U.115	PSC80 x STA20U - 115	115	30	36	58	PSC80 x STA2	STA2 - UT20 - 30	3.41
144.795.20U.155	PSC80 x STA20U - 155	155	70	36	58	PSC80 x STA2	STA2 - UT20 - 70	3.61
144.795.20U.185	PSC80 x STA20U - 185	185	100	36	58	PSC80 x STA2	STA2 - UT20 - 100	3.74
144.795.25U.120	PSC80 x STA25U - 120	120	35	42	58	PSC80 x STA2	STA2 - UT25 - 35	3.41
144.795.25U.170	PSC80 x STA25U - 170	170	85	42	58	PSC80 x STA2	STA2 - UT25 - 85	3.76
144.795.25U.200	PSC80 x STA25U - 200	200	115	42	58	PSC80 x STA2	STA2 - UT25 - 115	4.01
144.795.32U.135	PSC80 x STA32U - 135	135	50	48	58	PSC80 x STA2	STA2 - UT32 - 50	3.46
144.795.32U.170	PSC80 x STA32U - 170	170	85	48	58	PSC80 x STA2	STA2 - UT32 - 85	3.71
144.795.32U.200	PSC80 x STA32U - 200	200	115	48	58	PSC80 x STA2	STA2 - UT32 - 115	3.91

### Standard Accessory: • NUT

Collet	Nut	Spanner
P.W-6~9	P.W-41	P.W-62~67

# PSC / STA SYNCHRONIZED TAPPING HOLDER



## PSC / STA 同步補償攻牙刀桿

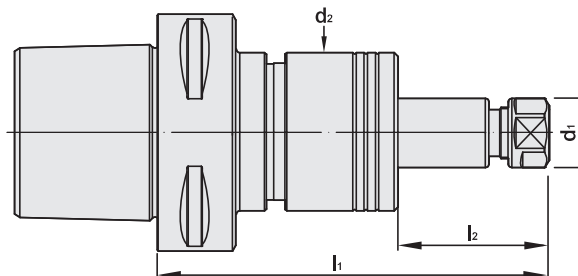

T W PAT NO. M520427  
 J P PAT NO. 3203456  
 D E PAT NO. Nr.202016100106

MODEL NO.	TYPE	l <sub>1</sub>	l <sub>2</sub>	d <sub>1</sub>	d <sub>2</sub>	COMBINATION		WEIGHT (KGS)
						BODY	TAP ADAPTER	
142.795.11E.150	PSC50 x STA11E - 150	150	70	19	42	PSC50 x STA1	STA1 - ER11A - 70	1.79
142.795.16E.105	PSC50 x STA16E - 105	105	25	28	42	PSC50 x STA1	STA1 - ER16A - 25	1.53
142.795.16E.150	PSC50 x STA16E - 150	150	70	28	42	PSC50 x STA1	STA1 - ER16A - 70	1.73
142.795.16E.230	PSC50 x STA16E - 230	230	150	28	42	PSC50 x STA1	STA1 - ER16A - 150	2.06
142.795.20E.114	PSC50 x STA20E - 114	114	34	34	42	PSC50 x STA1	STA1 - ER20A - 34	1.57
142.795.20E.150	PSC50 x STA20E - 150	150	70	34	42	PSC50 x STA1	STA1 - ER20A - 70	1.73
143.795.11E.130	PSC63 x STA11E - 130	130	70	19	42	PSC63 x STA1	STA1 - ER11A - 70	1.91
143.795.16E.085	PSC63 x STA16E - 85	85	25	28	42	PSC63 x STA1	STA1 - ER16A - 25	1.65
143.795.16E.130	PSC63 x STA16E - 130	130	70	28	42	PSC63 x STA1	STA1 - ER16A - 70	1.85
143.795.16E.210	PSC63 x STA16E - 210	210	150	28	42	PSC63 x STA1	STA1 - ER16A - 150	2.18
143.795.20E.094	PSC63 x STA20E - 94	94	34	34	42	PSC63 x STA1	STA1 - ER20A - 34	1.69
143.795.20E.130	PSC63 x STA20E - 130	130	70	34	42	PSC63 x STA1	STA1 - ER20A - 70	1.85
143.795.32E.120	PSC63 x STA32E - 120	120	40	50	58	PSC63 x STA2	STA2 - ER32 - 40	2.65
143.795.32E.150	PSC63 x STA32E - 150	150	70	50	58	PSC63 x STA2	STA1 - ER32 - 70	2.88
144.795.11E.135	PSC80 x STA11E - 135	135	70	19	42	PSC80 x STA1	STA1 - ER11A - 70	3.33
144.795.16E.090	PSC80 x STA16E - 90	90	25	28	42	PSC80 x STA1	STA1 - ER16A - 25	3.07
144.795.16E.135	PSC80 x STA16E - 135	135	70	28	42	PSC80 x STA1	STA1 - ER16A - 70	3.27
144.795.16E.215	PSC80 x STA16E - 215	215	150	28	42	PSC80 x STA1	STA1 - ER16A - 150	3.60
144.795.20E.099	PSC80 x STA20E - 99	99	34	34	42	PSC80 x STA1	STA1 - ER20A - 34	3.11
144.795.20E.135	PSC80 x STA20E - 135	135	70	34	42	PSC80 x STA1	STA1 - ER20A - 70	3.27
144.795.32E.125	PSC80 x STA32E - 125	125	40	50	58	PSC80 x STA2	STA2 - ER32 - 40	3.55
144.795.32E.155	PSC80 x STA32E - 155	155	70	50	58	PSC80 x STA2	STA1 - ER32 - 70	3.78

### Standard Accessory: • NUT

Collet	Nut	Spanner
P.W-6~24	P.W-42	P.W-62~65



# STRAIGHT SHANK STA SYNCHRONIZED TAPPING HOLDER



直柄 STA 同步補償攻牙刀桿

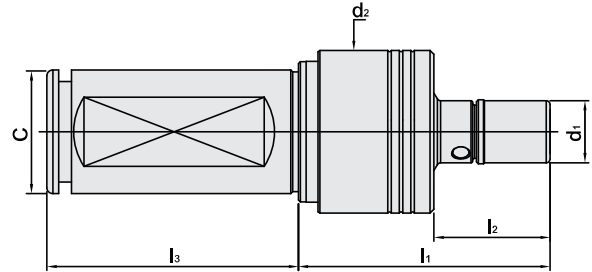

MODEL NO.	TYPE	l <sub>1</sub>	l <sub>2</sub>	l <sub>3</sub>	C	d <sub>1</sub>	d <sub>2</sub>	COMBINATION		WEIGHT (KGS)
								BODY	TAP ADAPTER	
C20.795.08T.075	C20 x STA8T - 75	75	30	55	20	12	42	C20 x STA1	STA1 - PTER8 - 30	0.50
C20.795.08T.115	C20 x STA8T - 115	115	70	55	20	12	42	C20 x STA1	STA1 - PTER8 - 70	0.56
C20.795.08T.145	C20 x STA8T - 145	145	100	55	20	12	42	C20 x STA1	STA1 - PTER8 - 100	0.61
C20.795.11T.075	C20 x STA11T - 75	75	30	55	20	16	42	C20 x STA1	STA1 - PTER11 - 30	0.95
C20.795.11T.115	C20 x STA11T - 115	115	70	55	20	16	42	C20 x STA1	STA1 - PTER11 - 70	1.01
C20.795.11T.145	C20 x STA11T - 145	145	100	55	20	16	42	C20 x STA1	STA1 - PTER11 - 100	1.05
C20.795.16T.075	C20 x STA16T - 75	75	30	55	20	22	42	C20 x STA1	STA1 - PTER16 - 30	0.96
C20.795.16T.115	C20 x STA16T - 115	115	70	55	20	22	42	C20 x STA1	STA1 - PTER16 - 70	1.02
C20.795.16T.145	C20 x STA16T - 145	145	100	55	20	22	42	C20 x STA1	STA1 - PTER16 - 100	1.06
C20.795.20T.075	C20 x STA20T - 75	75	30	55	20	28	42	C20 x STA1	STA1 - PTER20 - 30	0.93
C20.795.20T.115	C20 x STA20T - 115	115	70	55	20	28	42	C20 x STA1	STA1 - PTER20 - 70	1.20
C20.795.20T.145	C20 x STA20T - 145	145	100	55	20	28	42	C20 x STA1	STA1 - PTER20 - 100	1.36
C25.795.08T.070	C25 x STA8T - 70	70	30	60	25	12	42	C25 x STA1	STA1 - PTER8 - 30	0.54
C25.795.08T.110	C25 x STA8T - 110	110	70	60	25	12	42	C25 x STA1	STA1 - PTER8 - 70	0.58
C25.795.08T.140	C25 x STA8T - 140	140	100	60	25	12	42	C25 x STA1	STA1 - PTER8 - 100	0.63
C25.795.11T.070	C25 x STA11T - 070	70	30	60	25	16	42	C25 x STA1	STA1 - PTER11 - 30	0.99
C25.795.11T.110	C25 x STA11T - 110	110	70	60	25	16	42	C25 x STA1	STA1 - PTER11 - 70	1.04
C25.795.11T.140	C25 x STA11T - 140	140	100	60	25	16	42	C25 x STA1	STA1 - PTER11 - 100	1.08
C25.795.16T.070	C25 x STA16T - 70	70	30	60	25	22	42	C25 x STA1	STA1 - PTER16 - 30	1.00
C25.795.16T.110	C25 x STA16T - 110	110	70	60	25	22	42	C25 x STA1	STA1 - PTER16 - 70	1.06
C25.795.16T.140	C25 x STA16T - 140	140	100	60	25	22	42	C25 x STA1	STA1 - PTER16 - 100	1.10
C25.795.20T.070	C25 x STA20T - 70	70	30	60	25	28	42	C25 x STA1	STA1 - PTER20 - 30	0.97
C25.795.20T.110	C25 x STA20T - 110	110	70	60	25	28	42	C25 x STA1	STA1 - PTER20 - 70	1.24
C25.795.20T.140	C25 x STA20T - 140	140	100	60	25	28	42	C25 x STA1	STA1 - PTER20 - 100	1.40

### Standard Accessory: • NUT

Collet	Nut	Spanner
P.W-4	P.W-41	P.W-62~67

# STRAIGHT SHANK STA SYNCHRONIZED TAPPING HOLDER



直柄 STA 同步補償攻牙刀桿

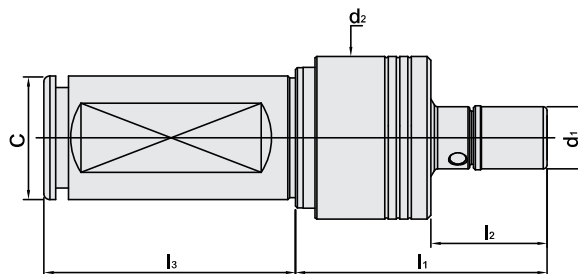

MODEL NO.	TYPE	l <sub>1</sub>	l <sub>2</sub>	l <sub>3</sub>	C	d <sub>1</sub>	d <sub>2</sub>	COMBINATION		WEIGHT (KGS)
								BODY	TAP ADAPTER	
C32.795.08T.065	C32 x STA8T - 65	65	30	65	32	12	42	C32 x STA1	STA1 - PTER8 - 30	0.65
C32.795.08T.105	C32 x STA8T - 105	105	70	65	32	12	42	C32 x STA1	STA1 - PTER8 - 70	0.71
C32.795.08T.135	C32 x STA8T - 135	135	100	65	32	12	42	C32 x STA1	STA1 - PTER8 - 100	0.76
C32.795.11T.065	C32 x STA11T - 65	65	30	65	32	16	42	C32 x STA1	STA1 - PTER11 - 30	1.10
C32.795.11T.105	C32 x STA11T - 105	105	70	65	32	16	42	C32 x STA1	STA1 - PTER11 - 70	1.16
C32.795.11T.135	C32 x STA11T - 135	135	100	65	32	16	42	C32 x STA1	STA1 - PTER11 - 100	1.20
C32.795.16T.065	C32 x STA16T - 65	65	30	65	32	22	42	C32 x STA1	STA1 - PTER16 - 30	1.11
C32.795.16T.105	C32 x STA16T - 105	105	70	65	32	22	42	C32 x STA1	STA1 - PTER16 - 70	1.17
C32.795.16T.135	C32 x STA16T - 135	135	100	65	32	22	42	C32 x STA1	STA1 - PTER16 - 100	1.21
C32.795.20T.065	C32 x STA20T - 65	65	30	65	32	28	42	C32 x STA1	STA1 - PTER20 - 30	1.08
C32.795.20T.105	C32 x STA20T - 105	105	70	65	32	28	42	C32 x STA1	STA1 - PTER20 - 70	1.35
C32.795.20T.135	C32 x STA20T - 135	135	100	65	32	28	42	C32 x STA1	STA1 - PTER20 - 100	1.51
C32.795.25T.090	C32 x STA25T - 90	90	30	65	32	35	58	C32 x STA2	STA2 - PTER25 - 30	1.40
C32.795.25T.130	C32 x STA25T - 130	130	70	65	32	35	58	C32 x STA2	STA2 - PTER25 - 70	1.72
C32.795.25T.160	C32 x STA25T - 160	160	100	65	32	35	58	C32 x STA2	STA2 - PTER25 - 100	1.88
C40.795.08T.065	C40 x STA8T - 65	65	30	75	40	12	42	C40 x STA1	STA1 - PTER8 - 30	0.97
C40.795.08T.105	C40 x STA8T - 105	105	70	75	40	12	42	C40 x STA1	STA1 - PTER8 - 70	1.47
C40.795.08T.135	C40 x STA8T - 135	135	100	75	40	12	42	C40 x STA1	STA1 - PTER8 - 100	1.52
C40.795.11T.065	C40 x STA11T - 65	65	30	75	40	16	42	C40 x STA1	STA1 - PTER11 - 30	1.42
C40.795.11T.105	C40 x STA11T - 105	105	70	75	40	16	42	C40 x STA1	STA1 - PTER11 - 70	1.48
C40.795.11T.135	C40 x STA11T - 135	135	100	75	40	16	42	C40 x STA1	STA1 - PTER11 - 100	1.53
C40.795.16T.065	C40 x STA16T - 65	65	30	75	40	22	42	C40 x STA1	STA1 - PTER16 - 30	1.43
C40.795.16T.105	C40 x STA16T - 105	105	70	75	40	22	42	C40 x STA1	STA1 - PTER16 - 70	1.49
C40.795.16T.135	C40 x STA16T - 135	135	100	75	40	22	42	C40 x STA1	STA1 - PTER16 - 100	1.53
C40.795.20T.065	C40 x STA20T - 65	65	30	75	40	28	42	C40 x STA1	STA1 - PTER20 - 30	1.40
C40.795.20T.105	C40 x STA20T - 105	105	70	75	40	28	42	C40 x STA1	STA1 - PTER20 - 70	1.67
C40.795.20T.135	C40 x STA20T - 135	135	100	75	40	28	42	C40 x STA1	STA1 - PTER20 - 100	1.83
C40.795.25T.085	C40 x STA25T - 85	85	30	75	40	35	58	C40 x STA2	STA2 - PTER25 - 30	1.75
C40.795.25T.125	C40 x STA25T - 125	125	70	75	40	35	58	C40 x STA2	STA2 - PTER25 - 70	2.02
C40.795.25T.155	C40 x STA25T - 155	155	100	75	40	35	58	C40 x STA2	STA2 - PTER25 - 100	2.18

**Standard Accessory: • NUT**

Collet	Nut	Spanner
P.W-4	P.W-41	P.W-62~67



# STRAIGHT SHANK STA SYNCHRONIZED TAPPING HOLDER



直柄 STA 同步補償攻牙刀桿

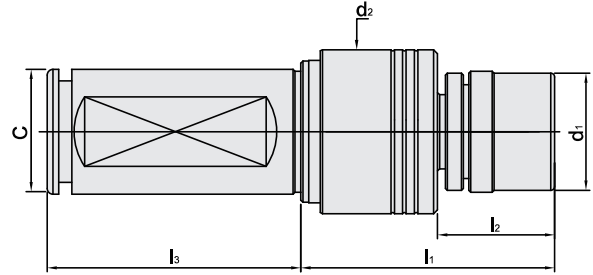

MODEL NO.	TYPE	l <sub>1</sub>	l <sub>2</sub>	l <sub>3</sub>	C	d <sub>1</sub>	d <sub>2</sub>	COMBINATION		WEIGHT (KGS)
								BODY	TAP ADAPTER	
C20.795.16U.075	C20 x STA16U - 75	75	30	55	20	30	42	C20 x STA1	STA1 - UT16 - 30	0.53
C20.795.16U.115	C20 x STA16U - 115	115	70	55	20	30	42	C20 x STA1	STA1 - UT16 - 70	0.68
C20.795.16U.145	C20 x STA16U - 145	145	100	55	20	30	42	C20 x STA1	STA1 - UT16 - 100	0.88
C25.795.16U.070	C25 x STA16U - 70	70	30	60	25	30	42	C25 x STA1	STA1 - UT16 - 30	0.57
C25.795.16U.110	C25 x STA16U - 110	110	70	60	25	30	42	C25 x STA1	STA1 - UT16 - 70	0.72
C25.795.16U.140	C25 x STA16U - 140	140	100	60	25	30	42	C25 x STA1	STA1 - UT16 - 100	0.92
C32.795.16U.065	C32 x STA16U - 65	65	30	65	32	30	42	C32 x STA1	STA1 - UT16 - 30	0.68
C32.795.16U.105	C32 x STA16U - 105	105	70	65	32	30	42	C32 x STA1	STA1 - UT16 - 70	0.83
C32.795.16U.135	C32 x STA16U - 135	135	100	65	32	30	42	C32 x STA1	STA1 - UT16 - 100	1.03
C32.795.20U.090	C32 x STA20U - 90	90	30	65	32	36	58	C32 x STA2	STA2 - UT20 - 30	1.20
C32.795.20U.130	C32 x STA20U - 130	130	70	65	32	36	58	C32 x STA2	STA2 - UT20 - 70	1.40
C32.795.20U.160	C32 x STA20U - 160	160	100	65	32	36	58	C32 x STA2	STA2 - UT20 - 100	1.53
C32.795.25U.095	C32 x STA25U - 95	90	30	65	32	42	58	C32 x STA2	STA2 - UT25 - 35	1.20
C32.795.25U.145	C32 x STA25U - 145	140	70	65	32	42	58	C32 x STA2	STA2 - UT25 - 85	1.55
C32.795.25U.175	C32 x STA25U - 175	170	100	65	32	42	58	C32 x STA2	STA2 - UT25 - 115	1.80
C32.795.32U.110	C32 x STA32U - 110	110	50	65	32	48	58	C32 x STA2	STA2 - UT32 - 50	1.25
C32.795.32U.145	C32 x STA32U - 145	145	85	65	32	48	58	C32 x STA2	STA2 - UT32 - 85	1.50
C32.795.32U.175	C32 x STA32U - 175	175	115	65	32	48	58	C32 x STA2	STA2 - UT32 - 115	1.70
C40.795.16U.065	C40 x STA16U - 65	65	30	75	40	30	42	C40 x STA1	STA1 - UT16 - 30	1.00
C40.795.16U.105	C40 x STA16U - 105	105	70	75	40	30	42	C40 x STA1	STA1 - UT16 - 70	1.15
C40.795.16U.135	C40 x STA16U - 135	135	100	75	40	30	42	C40 x STA1	STA1 - UT16 - 100	1.35
C40.795.20U.085	C40 x STA20U - 85	85	30	75	40	36	58	C40 x STA2	STA2 - UT20 - 30	1.50
C40.795.20U.125	C40 x STA20U - 125	125	70	75	40	36	58	C40 x STA2	STA2 - UT20 - 70	1.70
C40.795.20U.155	C40 x STA20U - 155	155	100	75	40	36	58	C40 x STA2	STA2 - UT20 - 100	1.83
C40.795.25U.090	C40 x STA25U - 90	90	35	75	40	42	58	C40 x STA2	STA2 - UT25 - 35	1.50
C40.795.25U.140	C40 x STA25U - 140	140	85	75	40	42	58	C40 x STA2	STA2 - UT25 - 85	1.85
C40.795.25U.170	C40 x STA25U - 170	170	115	75	40	42	58	C40 x STA2	STA2 - UT25 - 115	2.10
C40.795.32U.105	C40 x STA32U - 105	105	50	75	40	48	58	C40 x STA2	STA2 - UT32 - 50	1.55
C40.795.32U.140	C40 x STA32U - 140	140	85	75	40	48	58	C40 x STA2	STA2 - UT32 - 85	1.80
C40.795.32U.170	C40 x STA32U - 170	170	115	75	40	48	58	C40 x STA2	STA2 - UT32 - 115	2.00

Standard Accessory: • NUT

Collet	Nut	Spanner
P.W-6~9	P.W-41	P.W-62~67



# STRAIGHT SHANK STA SYNCHRONIZED TAPPING HOLDER



直柄 STA 同步補償攻牙刀桿

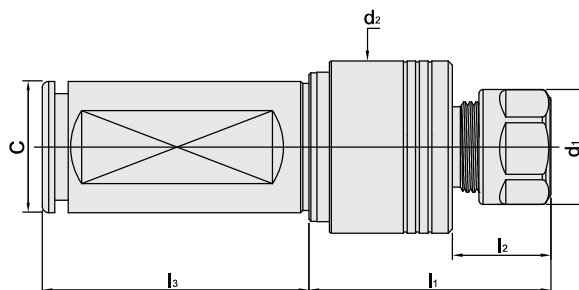

MODEL NO.	TYPE	l <sub>1</sub>	l <sub>2</sub>	l <sub>3</sub>	C	d <sub>1</sub>	d <sub>2</sub>	COMBINATION		WEIGHT (KGS)
								BODY	TAP ADAPTER	
C20.795.11E.115	C20 x STA11E - 115	115	70	55	20	19	42	C20 x STA1	STA1 - ER11A - 70	0.74
C20.795.16E.070	C20 x STA16E - 70	70	25	55	20	28	42	C20 x STA1	STA1 - ER16A - 25	0.48
C20.795.16E.115	C20 x STA16E - 115	115	70	55	20	28	42	C20 x STA1	STA1 - ER16A - 70	0.68
C20.795.16E.195	C20 x STA16E - 195	195	150	55	20	28	42	C20 x STA1	STA1 - ER16A - 150	1.01
C20.795.20E.079	C20 x STA20E - 079	79	34	55	20	34	42	C20 x STA1	STA1 - ER20A - 34	0.52
C20.795.20E.115	C20 x STA20E - 115	115	70	55	20	34	42	C20 x STA1	STA1 - ER20A - 70	0.68
C25.795.11E.110	C25 x STA11E - 110	110	70	60	25	19	42	C25 x STA1	STA1 - ER11A - 70	0.78
C25.795.16E.065	C25 x STA16E - 65	65	25	60	25	28	42	C25 x STA1	STA1 - ER16A - 25	0.52
C25.795.16E.110	C25 x STA16E - 110	110	70	60	25	28	42	C25 x STA1	STA1 - ER16A - 70	0.72
C25.795.16E.190	C25 x STA16E - 190	190	150	60	25	28	42	C25 x STA1	STA1 - ER16A - 150	1.05
C25.795.20E.079	C25 x STA20E - 79	79	34	60	25	34	42	C25 x STA1	STA1 - ER20A - 34	0.52
C25.795.20E.110	C25 x STA20E - 110	110	70	60	25	34	42	C25 x STA1	STA1 - ER20A - 70	0.72
C32.795.11E.105	C32 x STA11E - 105	105	70	65	32	19	42	C32 x STA1	STA1 - ER11A - 70	0.89
C32.795.16E.060	C32 x STA16E - 60	60	25	65	32	28	42	C32 x STA1	STA1 - ER16A - 25	0.63
C32.795.16E.105	C32 x STA16E - 105	105	70	65	32	28	42	C32 x STA1	STA1 - ER16A - 70	0.83
C32.795.16E.185	C32 x STA16E - 185	185	150	65	32	28	42	C32 x STA1	STA1 - ER16A - 150	1.16
C32.795.20E.069	C32 x STA20E - 69	69	34	65	32	34	42	C32 x STA1	STA1 - ER20A - 34	0.67
C32.795.20E.105	C32 x STA20E - 105	105	70	65	32	34	42	C32 x STA1	STA1 - ER20A - 70	0.83
C32.795.32E.100	C32 x STA32E - 100	100	40	65	32	50	58	C32 x STA2	STA2 - ER32 - 40	1.34
C32.795.32E.130	C32 x STA32E - 130	130	70	65	32	50	58	C32 x STA2	STA2 - ER32 - 70	1.57
C40.795.11E.105	C40 x STA11E - 105	105	70	75	40	19	42	C40 x STA1	STA1 - ER11A - 70	1.21
C40.795.16E.060	C40 x STA16E - 60	60	25	75	40	28	42	C40 x STA1	STA1 - ER16A - 25	0.95
C40.795.16E.105	C40 x STA16E - 105	105	70	75	40	28	42	C40 x STA1	STA1 - ER16A - 70	1.15
C40.795.16E.185	C40 x STA16E - 185	185	150	75	40	28	42	C40 x STA1	STA1 - ER16A - 150	1.48
C40.795.20E.069	C40 x STA20E - 69	69	34	75	40	34	42	C40 x STA1	STA1 - ER20A - 34	0.99
C40.795.20E.105	C40 x STA20E - 105	105	70	75	40	34	42	C40 x STA1	STA1 - ER20A - 70	1.15
C40.795.32E.095	C40 x STA32E - 95	95	40	75	40	50	58	C40 x STA2	STA2 - ER32 - 40	1.64
C40.795.32E.125	C40 x STA32E - 125	125	70	75	40	50	58	C40 x STA2	STA2 - ER32 - 70	1.87

Standard Accessory: • NUT



Collet	Nut	Spanner
P.W-6~24	P.W-42	P.W-62~65

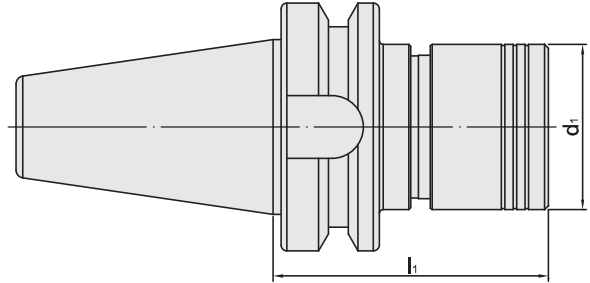

# STA SYNCHRONIZED TAPPING HOLDER BODY

STA 同步補償攻牙刀桿本體

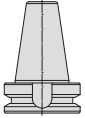

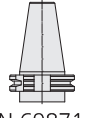
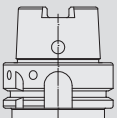
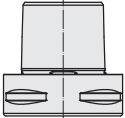

SHANK	MODEL NO.	TYPE	$l_1$	$d_1$	STA NO.	WEIGHT (KGS)
 MAS 403	10.795.01	BT30 x STA1	60	42	1	0.56
	11.795.01	BT40 x STA1	70	42	1	1.18
	11.795.02	BT40 x STA2	85	58	2	1.48
	12.795.01	BT50 x STA1	60	42	1	3.68
	12.795.02	BT50 x STA2	95	58	2	3.98
 ANSI B5.50	31.795.01	CAT40 x STA1	70	42	1	1.12
	31.795.02	CAT40 x STA2	90	58	2	1.45
	32.795.01	CAT50 x STA1	70	42	1	3.12
	32.795.02	CAT50 x STA2	95	58	2	3.53
 DIN 69871-A	51.795.01	DAT40 x STA1	60	42	1	1.01
	51.795.02	DAT40 x STA2	90	58	2	1.50
	52.795.01	DAT50 x STA1	60	42	1	2.73
	52.795.02	DAT50 x STA2	80	58	2	3.11
 DIN 69893 A	71.795.01	HSK40A x STA1	70	42	1	1.10
	72.795.01	HSK50A x STA1	70	42	1	1.31
	73.795.01	HSK63A x STA1	80	42	1	1.60
	74.795.01	HSK80A x STA1	80	42	1	1.98
	74.795.02	HSK80A x STA2	95	58	2	2.80
	75.795.01	HSK100A x STA1	80	42	1	2.78
 ISO 26623-1	75.795.02	HSK100A x STA2	95	58	2	3.60
	142.795.01	PSC50 x STA1	80	42	1	1.43
	143.795.01	PSC63 x STA1	60	42	1	1.55
	143.795.02	PSC63 x STA2	80	58	2	2.21
	144.795.01	PSC80 x STA1	65	42	1	2.97
	144.795.02	PSC80 x STA2	85	58	2	3.11

# STA SYNCHRONIZED TAPPING HOLDER BODY

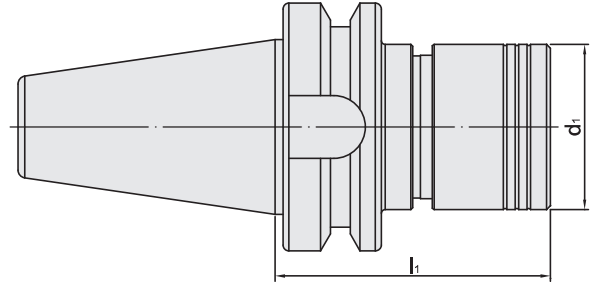
## STA 同步補償攻牙刀桿本體

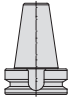

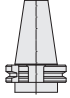
SHANK	MODEL NO.	TYPE	$l_1$	$d_1$	STA NO.	WEIGHT (KGS)
 DualDRIVE+	25.795.01	SBT30 x STA1	60	42	1	0.56
	26.795.01	SBT40 x STA1	70	42	1	1.18
	26.795.02	SBT40 x STA2	85	58	2	1.48
	27.795.01	SBT50 x STA1	80	42	1	3.68
	27.795.02	SBT50 x STA2	95	58	2	3.98
 DualDRIVE+	43.795.01	SCAT40 x STA1	70	42	1	1.12
	43.795.02	SCAT40 x STA2	90	58	2	1.45
	44.795.01	SCAT50 x STA1	70	42	1	3.12
	44.795.02	SCAT50 x STA2	95	58	2	3.53
 DualDRIVE+	66.795.01	SDAT40 x STA1	60	42	1	1.01
	66.795.02	SDAT40 x STA2	90	58	2	1.50
	67.795.01	SDAT50 x STA1	60	42	1	2.73
	67.795.02	SDAT50 x STA2	80	58	2	3.11

STRAIGHT SHANK

## STA SYNCHRONIZED TAPPING HOLDER BODY

直柄 STA 同步補償攻牙刀桿本體

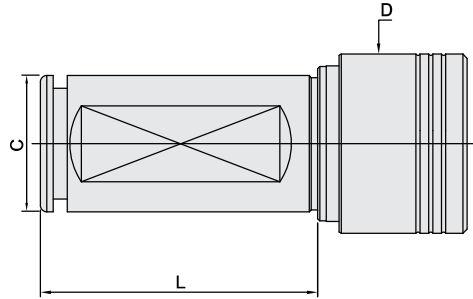

MODEL NO.	TYPE	L	C	D	STA NO.	WEIGHT (KGS)
C20.795.055.01	C20 x STA1	55	20	42	1	0.38
C25.795.060.01	C25 x STA1	60	25	42	1	0.42
C32.795.065.01	C32 x STA1	65	32	42	1	0.52
C32.795.065.02	C32 x STA2	65	32	58	2	0.90
C40.795.075.01	C40 x STA1	75	40	42	1	0.82
C40.795.075.02	C40 x STA2	75	40	58	2	1.13

# TAP ADAPTER FOR STA



STA 同步補償攻牙刀桿心軸

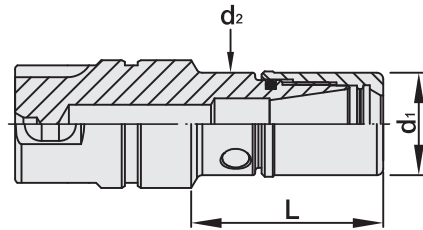

MODEL NO.	TYPE	L	d <sub>1</sub>	d <sub>2</sub>	CAPACITY	WEIGHT (KGS)
795.528.08.030	STA1 - PTER8 -30	30	12	12	M3 ~ M5	0.12
795.528.08.070	STA1 - PTER8 - 70	70	12	12	M3 ~ M5	0.18
795.528.08.100	STA1 - PTER8 - 100	100	12	12	M3 ~ M5	0.23
795.528.11.030	STA1 - PTER11 - 30	30	16	16	M3 ~ M6	0.57
795.528.11.070	STA1 - PTER11 - 70	70	16	16	M3 ~ M6	0.63
795.528.11.100	STA1 - PTER11 - 100	100	16	16	M3 ~ M6	0.67
795.528.16.030	STA1 - PTER16 - 30	30	22	22	M3 ~ M12	0.58
795.528.16.070	STA1 - PTER16 - 70	70	22	22	M3 ~ M12	0.64
795.528.16.100	STA1 - PTER16 - 100	100	22	22	M3 ~ M12	0.68
795.528.20.030	STA1 - PTER20 - 30	30	28	28	M3 ~ M16	0.55
795.528.20.070	STA1 - PTER20 - 70	70	28	28	M3 ~ M16	0.82
795.528.20.100	STA1 - PTER20 - 100	100	28	28	M3 ~ M16	0.98
795.528.25.030	STA2 - PTER25 - 30	30	35	35	M6 ~ M18	0.55
795.528.25.070	STA2 - PTER25 - 70	70	35	35	M6 ~ M18	0.82
795.528.25.100	STA2 - PTER25 - 100	100	35	35	M6 ~ M18	0.98

**Standard Accessory: • NUT**

Collet	Nut	Spanner
		
P.W-4	P.W-41	P.W-62~67



# TAP ADAPTER FOR STA



STA 同步補償攻牙刀桿心軸

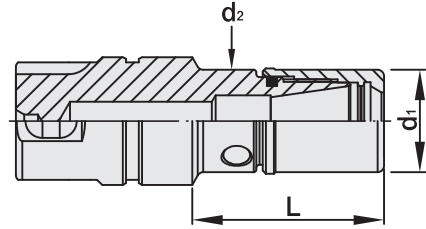

MODEL NO.	TYPE	L	d <sub>1</sub>	d <sub>2</sub>	CAPACITY	WEIGHT (KGS)
795.753.16.030	STA1 - UT16 - 30	30	30	30	M3 ~ M12	0.15
795.753.16.070	STA1 - UT16 - 70	70	30	30	M3 ~ M12	0.30
795.753.16.100	STA1 - UT16 - 100	100	30	30	M3 ~ M12	0.50
795.753.20.030	STA2 - UT20 - 30	30	36	-	M3 ~ M16	0.30
795.753.20.070	STA2 - UT20 - 70	70	36	36	M3 ~ M16	0.50
795.753.20.100	STA2 - UT20 - 100	100	36	36	M3 ~ M16	0.63
795.753.25.035	STA2 - UT25 - 35	35	42	42	M6 ~ M18	0.30
795.753.25.085	STA2 - UT25 - 85	85	42	42	M6 ~ M18	0.65
795.753.25.115	STA2 - UT25 - 115	115	42	42	M6 ~ M18	0.90
795.753.32.050	STA2 - UT32 - 50	50	48	48	M10 ~ M24	0.35
795.753.32.085	STA2 - UT32 - 85	85	48	48	M10 ~ M24	0.60
795.753.32.115	STA2 - UT32 - 115	115	48	48	M10 ~ M24	0.80

**Standard Accessory: • NUT**

Collet	Nut	Spanner
		
P.W-6~9	P.W-41	P.W-62~67

# TAP ADAPTER FOR STA



STA 同步補償攻牙刀桿心軸

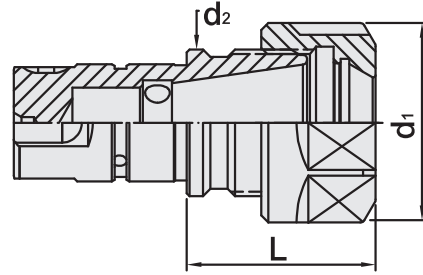

MODEL NO.	TYPE	L	d <sub>1</sub>	d <sub>2</sub>	CAPACITY	WEIGHT (KGS)
686.122.11.070	STA1 - ER11A - 70	70	19	19	M3 ~ M6	0.36
686.122.16.025	STA1 - ER16A - 25	25	28	20	M3 ~ M12	0.10
686.122.16.070	STA1 - ER16A - 70	70	28	22	M3 ~ M12	0.30
686.122.16.150	STA1 - ER16A - 150	150	28	28	M3 ~ M12	0.63
686.122.20.034	STA1 - ER20A - 34	34	34	25	M3 ~ M16	0.14
686.122.20.070	STA1 - ER20A - 70	70	34	25	M3 ~ M16	0.30
686.122.32.040	STA2 - ER32 - 40	40	50	40	M10 ~ M24	0.44
686.122.32.070	STA2 - ER32 - 70	70	50	40	M10 ~ M24	0.67

**Standard Accessory: • NUT**

Collet	Nut	Spanner
P.W-6~24	P.W-42	P.W-62~65

