

SAF CATEGORY

BT / SAF RUNOUT ADJUSTABLE HOLDER	R-2~5
CAT / SAF RUNOUT ADJUSTABLE HOLDER	R-6~9
DAT / SAF RUNOUT ADJUSTABLE HOLDER	R-10~13
SBT / SAF RUNOUT ADJUSTABLE HOLDER	R-14~17
SCAT / SAF RUNOUT ADJUSTABLE HOLDER	R-18~21
SDAT / SAF RUNOUT ADJUSTABLE HOLDER	R-22~25
HSK / SAF RUNOUT ADJUSTABLE HOLDER	R-26~30
PSC / SAF RUNOUT ADJUSTABLE HOLDER	R-31~34
SAF RUNOUT ADJUSTABLE HOLDER BODY	R-35~36
SHRINK FIT CHUCK FLANGE FOR SAF	R-37
SK3 COLLET CHUCK FLANGE FOR SAF	R-38
PNER COLLET CHUCK FLANGE FOR SAF	R-39
UT COLLET CHUCK FLANGE FOR SAF	R-40

BT / SAF RUNOUT ADJUSTABLE HOLDER

4.5°

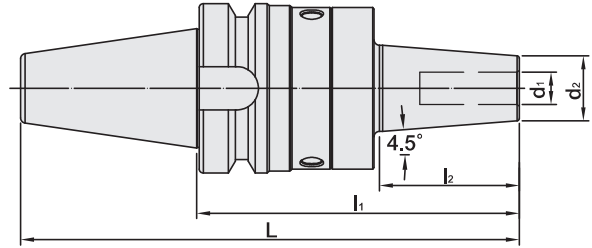

BT / SAF 可調式刀桿



MODEL NO.	TYPE	L	l ₁	l ₂	d ₁	d ₂	COMBINATION		WEIGHT (KGS)
							BODY	FLANGE ADAPTER	
19832	BT30 x SAFC6 - 110	158.4	110	52	6	21	BT30 x SAFC25	SFC6 - 70	1.13
19834	BT30 x SAFC8 - 110	158.4	110	52	8	21	BT30 x SAFC25	SFC8 - 70	1.12
19836	BT30 x SAFC10 - 110	158.4	110	52	10	24	BT30 x SAFC25	SFC10 - 70	1.17
19838	BT30 x SAFC12 - 110	158.4	110	52	12	24	BT30 x SAFC25	SFC12 - 70	1.15
19840	BT30 x SAFC16 - 115	163.4	115	57	16	27	BT30 x SAFC25	SFC16 - 75	1.20
19842	BT40 x SAFC6 - 120	185.4	120	52	6	21	BT40 x SAFC25	SFC6 - 70	1.86
19844	BT40 x SAFC8 - 120	185.4	120	52	8	21	BT40 x SAFC25	SFC8 - 70	1.85
19846	BT40 x SAFC10 - 120	185.4	120	52	10	24	BT40 x SAFC25	SFC10 - 70	1.90
19848	BT40 x SAFC12 - 120	185.4	120	52	12	24	BT40 x SAFC25	SFC12 - 70	1.88
19850	BT40 x SAFC16 - 125	190.4	125	57	16	27	BT40 x SAFC25	SFC16 - 75	1.93
19852	BT40 x SAFC20 - 130	195.4	130	60	20	33	BT40 x SAFC40	SFC20 - 80	2.67
19854	BT40 x SAFC25 - 150	215.4	150	81	25	44	BT40 x SAFC40	SFC25 - 100	3.20
19856	BT40 x SAFC32 - 150	215.4	150	81	32	44	BT40 x SAFC40	SFC32 - 100	3.06
19858	BT50 x SAFC6 - 130	231.8	130	52	6	21	BT50 x SAFC25	SFC6 - 70	4.34
19860	BT50 x SAFC8 - 130	231.8	130	52	8	21	BT50 x SAFC25	SFC8 - 70	4.33
19862	BT50 x SAFC10 - 130	231.8	130	52	10	24	BT50 x SAFC25	SFC10 - 70	4.38
19864	BT50 x SAFC12 - 130	231.8	130	52	12	24	BT50 x SAFC25	SFC12 - 70	4.36
19866	BT50 x SAFC16 - 135	236.8	135	57	16	27	BT50 x SAFC25	SFC16 - 75	4.41
19868	BT50 x SAFC20 - 140	241.8	140	60	20	33	BT50 x SAFC40	SFC20 - 80	5.26
19870	BT50 x SAFC25 - 160	261.8	160	81	25	44	BT50 x SAFC40	SFC25 - 100	5.79
19872	BT50 x SAFC32 - 160	261.8	160	81	32	44	BT50 x SAFC40	SFC32 - 100	5.65

Features:

- ▶ Flange adapter: SFC.
- ▶ Drive axial and radial set screws for precision adjustment and the runout accuracy of the tool edge can be adjusted within 5 μm.

Pull Stud	Preset Screw
	
P.W-54~55	P.W-82

BT / SAF RUNOUT ADJUSTABLE HOLDER

BT / SAF 可調式刀桿

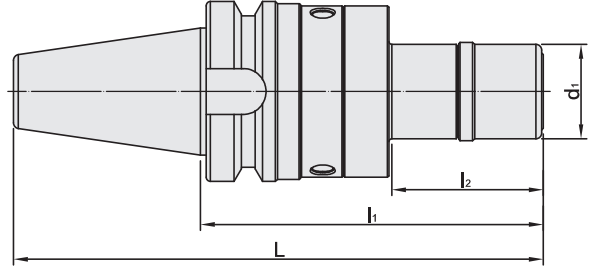

MODEL NO.	TYPE	L	l ₁	l ₂	d ₁	COMBINATION		COLLET	WEIGHT (KGS)
						BODY	FLANGE ADAPTER		
19602	BT30 x SAFK6 - 90	138.4	90	29	19.5	BT30 x SAF25	SK306 - 50	SKS6	1.00
19604	BT30 x SAFK10 - 90	138.4	90	32.5	27.5	BT30 x SAF25	SK310 - 50	SKS10	1.03
19606	BT30 x SAFK13 - 110	158.4	110	53	33	BT30 x SAF25	SK313 - 70	SKS13	1.16
19610	BT40 x SAFK6 - 100	165.4	100	29	19.5	BT40 x SAF25	SK306 - 50	SKS6	1.73
19612	BT40 x SAFK6 - 150	215.4	150	79	19.5	BT40 x SAF25	SK306 - 100	SKS6	1.82
19614	BT40 x SAFK10 - 100	165.4	100	32.5	27.5	BT40 x SAF25	SK310 - 50	SKS10	1.76
19616	BT40 x SAFK10 - 150	215.4	150	82.5	27.5	BT40 x SAF25	SK310 - 100	SKS10	1.95
19618	BT40 x SAFK13 - 120	185.4	120	53	33	BT40 x SAF25	SK313 - 70	SKS13	1.89
19620	BT40 x SAFK13 - 150	215.4	150	83	33	BT40 x SAF25	SK313 - 100	SKS13	2.07
19622	BT40 x SAFK16 - 120	185.4	120	49.9	40	BT40 x SAF40	SK316 - 70	SKS16	2.56
19624	BT40 x SAFK16 - 150	215.4	150	79.9	40	BT40 x SAF40	SK316 - 100	SKS16	2.82
19630	BT50 x SAFK6 - 110	211.8	110	29	19.5	BT50 x SAF25	SK306 - 50	SKS6	4.21
19632	BT50 x SAFK6 - 160	261.8	160	79	19.5	BT50 x SAF25	SK306 - 100	SKS6	4.30
19634	BT50 x SAFK10 - 110	211.8	110	32.5	27.5	BT50 x SAF25	SK310 - 50	SKS10	4.24
19636	BT50 x SAFK10 - 160	261.8	160	82.5	27.5	BT50 x SAF25	SK310 - 100	SKS10	4.43
19638	BT50 x SAFK13 - 130	231.8	130	53	33	BT50 x SAF25	SK313 - 70	SKS13	4.37
19640	BT50 x SAFK13 - 160	261.8	160	83	33	BT50 x SAF25	SK313 - 100	SKS13	4.55
19642	BT50 x SAFK16 - 130	231.8	130	49.9	40	BT50 x SAF40	SK316 - 70	SKS16	5.15
19644	BT50 x SAFK16 - 160	261.8	160	79.9	40	BT50 x SAF40	SK316 - 100	SKS16	5.41

Features:

- ▶ Flange adapter: SK3.
- ▶ Drive axial and radial set screws for precision adjustment and the runout accuracy of the tool edge can be adjusted within 5 μm.

Standard Accessory: • NUT

Collet	Nut	Pull Stud	Preset Screw	Spanner
P.W-25~28	P.W-46	P.W-54~55	P.W-82	P.W-62~67



BT / SAF RUNOUT ADJUSTABLE HOLDER



BT / SAF 可調式刀桿



T W PAT NO. M298033
 T W PAT NO. M311791
 T W PAT NO. M501316
 J P PAT NO. 3128766
 J P PAT NO. 3200356
 K R PAT NO. 20-0433603
 C N PAT NO. ZL200620132661.0
 C H PAT NO. 696550
 T R PAT NO. TR 2007 02942 Y
 I T PAT NO. N.0000266731
 D E PAT NO. Nr.202015005621

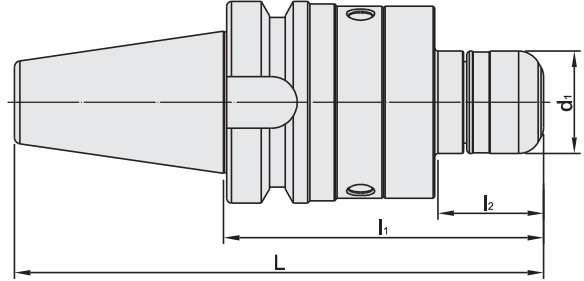

MODEL NO.	TYPE	L	l ₁	l ₂	d ₁	COMBINATION		COLLET	WEIGHT (KGS)
						BODY	FLANGE ADAPTER		
19652	BT30 x SAFP16 - 90	138.4	90	32	30	BT30 x SAF25	PNER16 - 50	PNER16	1.03
19654	BT30 x SAFP20 - 90	138.4	90	33	32	BT30 x SAF25	PNER20 - 50	PNER20	1.04
19660	BT40 x SAFP16 - 100	165.4	100	32	30	BT40 x SAF25	PNER16 - 50	PNER16	1.76
19662	BT40 x SAFP16 - 150	215.4	150	82	30	BT40 x SAF25	PNER16 - 100	PNER16	2.00
19664	BT40 x SAFP20 - 100	165.4	100	33	32	BT40 x SAF25	PNER20 - 50	PNER20	1.77
19668	BT40 x SAFP20 - 150	215.4	150	83	32	BT40 x SAF25	PNER20 - 100	PNER20	2.03
19670	BT40 x SAFP25 - 100	165.4	100	28.9	40	BT40 x SAF40	PNER25 - 50	PNER25	2.41
19672	BT40 x SAFP25 - 150	215.4	150	78.9	40	BT40 x SAF40	PNER25 - 100	PNER25	2.83
19674	BT40 x SAFP32 - 110	175.4	110	40.9	50	BT40 x SAF40	PNER32 - 60	PNER32	2.56
19676	BT40 x SAFP32 - 150	215.4	150	80.9	50	BT40 x SAF40	PNER32 - 100	PNER32	3.11
19680	BT50 x SAFP16 - 110	211.8	110	32	30	BT50 x SAF25	PNER16 - 50	PNER16	4.24
19682	BT50 x SAFP16 - 160	261.8	160	82	30	BT50 x SAF25	PNER16 - 100	PNER16	4.48
19684	BT50 x SAFP20 - 110	211.8	110	33	32	BT50 x SAF25	PNER20 - 50	PNER20	4.25
19686	BT50 x SAFP20 - 160	261.8	160	83	32	BT50 x SAF25	PNER20 - 100	PNER20	4.51
19688	BT50 x SAFP25 - 110	211.8	110	28.9	40	BT50 x SAF40	PNER25 - 50	PNER25	5.00
19690	BT50 x SAFP25 - 160	261.8	160	78.9	40	BT50 x SAF40	PNER25 - 100	PNER25	5.42
19692	BT50 x SAFP32 - 120	221.8	120	40.9	50	BT50 x SAF40	PNER32 - 60	PNER32	5.15
19694	BT50 x SAFP32 - 160	261.8	160	80.9	50	BT50 x SAF40	PNER32 - 100	PNER32	5.70

Features:

- ▶ Flange adapter: PNER.
- ▶ Drive axial and radial set screws for precision adjustment and the runout accuracy of the tool edge can be adjusted within 5 μm.

Standard Accessory: • NUT

Collet	Nut	Pull Stud	Preset Screw	Spanner
P.W-4	P.W-39	P.W-54~55	P.W-82	P.W-62~67



BT / SAF RUNOUT ADJUSTABLE HOLDER



BT / SAF 可調式刀桿



T W PAT NO. M298033
 T W PAT NO. M311791
 J P PAT NO. 3128766
 J P PAT NO. 3200356
 K R PAT NO. 20-0433603
 C N PAT NO. ZL200620132661.0
 C H PAT NO. 696550
 T R PAT NO. TR 2007 02942 Y
 I T PAT NO. N.0000266731

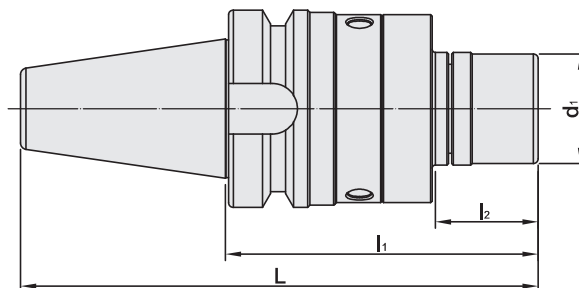

MODEL NO.	TYPE	L	l ₁	l ₂	d ₁	COMBINATION		COLLET	WEIGHT (KGS)
						BODY	FLANGE ADAPTER		
19802	BT30 x SAFU16 - 90	138.4	90	29	18	BT30 x SAF25	UT16 - 50	ER16	1.08
19804	BT30 x SAFU20 - 90	138.4	90	32.5	27	BT30 x SAF25	UT20 - 50	ER20	1.10
19806	BT40 x SAFU16 - 100	158.4	110	53	34	BT40 x SAF25	UT16 - 50	ER16	1.81
19808	BT40 x SAFU20 - 100	165.4	100	29	18	BT40 x SAF25	UT20 - 50	ER20	1.83
19810	BT40 x SAFU25 - 110	215.4	150	79	18	BT40 x SAF40	UT25 - 60	ER25	2.57
19812	BT40 x SAFU32 - 110	165.4	100	32.5	27	BT40 x SAF40	UT32 - 60	ER32	2.60
19814	BT50 x SAFU16 - 110	215.4	150	82.5	27	BT40 x SAF25	UT16 - 50	ER16	4.29
19816	BT50 x SAFU20 - 110	185.4	120	53	34	BT40 x SAF25	UT20 - 50	ER20	4.31
19818	BT50 x SAFU25 - 120	215.4	150	83	34	BT40 x SAF40	UT25 - 60	ER25	5.16
19820	BT50 x SAFU32 - 120	185.4	120	49.9	40	BT40 x SAF40	UT32 - 60	ER32	5.19

Features:

- ▶ Flange adapter: UT.
- ▶ Drive axial and radial set screws for precision adjustment and the runout accuracy of the tool edge can be adjusted within 5 μm.

Standard Accessory: • NUT

Collet	Nut	Pull Stud	Preset Screw	Spanner
P.W-6~9	P.W-41	P.W-54~55	P.W-82	P.W-62~67



CAT / SAF RUNOUT ADJUSTABLE HOLDER

4.5°

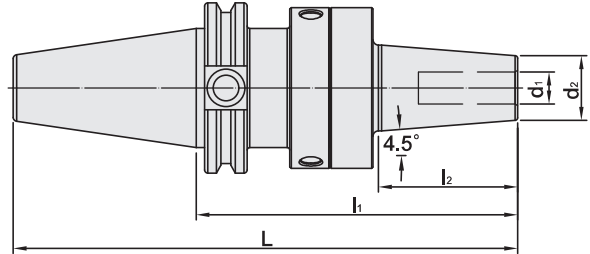

CAT / SAF 可調式刀桿



MODEL NO.	TYPE	L	l ₁	l ₂	d ₁	d ₂	COMBINATION		WEIGHT (KGS)
							BODY	FLANGE ADAPTER	
29582	CAT40 x SAFC6 - 120	188.249	120	52	6	21	CAT40 x SAF25	SFC6 - 70	1.71
29584	CAT40 x SAFC8 - 120	188.249	120	52	8	21	CAT40 x SAF25	SFC8 - 70	1.70
29586	CAT40 x SAFC10 - 120	188.249	120	52	10	24	CAT40 x SAF25	SFC10 - 70	1.75
29588	CAT40 x SAFC12 - 120	188.249	120	52	12	24	CAT40 x SAF25	SFC12 - 70	1.73
29590	CAT40 x SAFC16 - 125	193.249	125	57	16	27	CAT40 x SAF25	SFC16 - 75	1.78
29592	CAT40 x SAFC20 - 140	208.249	140	60	20	33	CAT40 x SAF40	SFC20 - 80	2.90
29594	CAT40 x SAFC25 - 160	228.249	160	81	25	44	CAT40 x SAF40	SFC25 - 100	3.43
29596	CAT40 x SAFC32 - 160	228.249	160	81	32	44	CAT40 x SAF40	SFC32 - 100	3.29
29598	CAT50 x SAFC6 - 130	231.6	130	52	6	21	CAT50 x SAF25	SFC6 - 70	3.98
29600	CAT50 x SAFC8 - 130	231.6	130	52	8	21	CAT50 x SAF25	SFC8 - 70	3.97
29602	CAT50 x SAFC10 - 130	231.6	130	52	10	24	CAT50 x SAF25	SFC10 - 70	4.02
29604	CAT50 x SAFC12 - 130	231.6	130	52	12	24	CAT50 x SAF25	SFC12 - 70	4.00
29606	CAT50 x SAFC16 - 135	236.6	135	57	16	27	CAT50 x SAF25	SFC16 - 75	4.05
29608	CAT50 x SAFC20 - 140	241.6	140	60	20	33	CAT50 x SAF40	SFC20 - 80	4.96
29610	CAT50 x SAFC25 - 160	261.6	160	81	25	44	CAT50 x SAF40	SFC25 - 100	5.49
29612	CAT50 x SAFC32 - 160	261.6	160	81	32	44	CAT50 x SAF40	SFC32 - 100	5.35

Features:

- ▶ Flange adapter: SFC.
- ▶ Drive axial and radial set screws for precision adjustment and the runout accuracy of the tool edge can be adjusted within 5 μm.

Pull Stud	Preset Screw
	
P.W-56	P.W-82

CAT / SAF RUNOUT ADJUSTABLE HOLDER

CAT / SAF 可調式刀桿

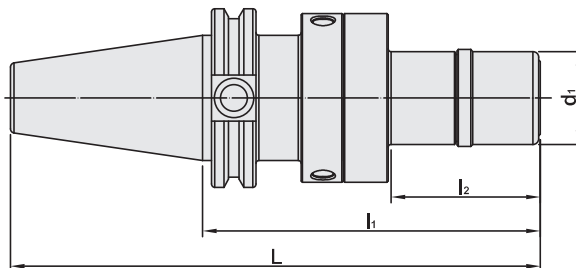

MODEL NO.	TYPE	L	l ₁	l ₂	d ₁	COMBINATION		COLLET	WEIGHT (KGS)
						BODY	FLANGE ADAPTER		
29502	CAT40 x SAFK6 - 100	168.249	100	29	19.5	CAT40 x SAF25	SK306 - 50	SKS6	1.58
29504	CAT40 x SAFK6 - 150	218.249	150	79	19.5	CAT40 x SAF25	SK306 - 100	SKS6	1.67
29506	CAT40 x SAFK10 - 100	168.249	100	32.5	27.5	CAT40 x SAF25	SK310 - 50	SKS10	1.61
29508	CAT40 x SAFK10 - 150	218.249	150	82.5	27.5	CAT40 x SAF25	SK310 - 100	SKS10	1.80
29510	CAT40 x SAFK13 - 120	188.249	120	53	33	CAT40 x SAF25	SK313 - 70	SKS13	1.74
29512	CAT40 x SAFK13 - 150	218.249	150	83	33	CAT40 x SAF25	SK313 - 100	SKS13	1.92
29514	CAT40 x SAFK16 - 130	198.249	130	49.9	40	CAT40 x SAF40	SK316 - 70	SKS16	2.79
29516	CAT40 x SAFK16 - 160	228.249	160	79.9	40	CAT40 x SAF40	SK316 - 100	SKS16	3.05
29518	CAT50 x SAFK6 - 110	211.6	110	29	19.5	CAT50 x SAF25	SK306 - 50	SKS6	3.85
29520	CAT50 x SAFK6 - 160	261.6	160	79	19.5	CAT50 x SAF25	SK306 - 100	SKS6	3.94
29522	CAT50 x SAFK10 - 110	211.6	110	32.5	27.5	CAT50 x SAF25	SK310 - 50	SKS10	3.88
29524	CAT50 x SAFK10 - 160	261.6	160	82.5	27.5	CAT50 x SAF25	SK310 - 100	SKS10	4.07
29526	CAT50 x SAFK13 - 130	231.6	130	53	33	CAT50 x SAF25	SK313 - 70	SKS13	4.01
29528	CAT50 x SAFK13 - 160	261.6	160	83	33	CAT50 x SAF25	SK313 - 100	SKS13	4.19
29530	CAT50 x SAFK16 - 130	231.6	130	49.9	40	CAT50 x SAF40	SK316 - 70	SKS16	4.85
29532	CAT50 x SAFK16 - 160	261.6	160	79.9	40	CAT50 x SAF40	SK316 - 100	SKS16	5.11

Features:

- ▶ Flange adapter: SK3.
- ▶ Drive axial and radial set screws for precision adjustment and the runout accuracy of the tool edge can be adjusted within 5 μm.

Standard Accessory: • NUT

Collet	Nut	Pull Stud	Preset Screw	Spanner
P.W-25~28	P.W-46	P.W-56	P.W-82	P.W-62~67



CAT / SAF RUNOUT ADJUSTABLE HOLDER



CAT / SAF 可調式刀桿



T W PAT NO. M298033
 T W PAT NO. M311791
 T W PAT NO. M501316
 J P PAT NO. 3128766
 J P PAT NO. 3200356
 K R PAT NO. 20-0433603
 C N PAT NO. ZL200620132661.0
 C H PAT NO. 696550
 T R PAT NO. TR 2007 02942 Y
 I T PAT NO. N.0000266731
 D E PAT NO. Nr.202015005621

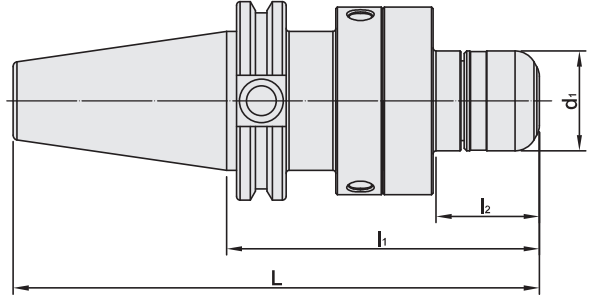

MODEL NO.	TYPE	L	l ₁	l ₂	d ₁	COMBINATION		COLLET	WEIGHT (KGS)
						BODY	FLANGE ADAPTER		
29542	CAT40 x SAFP16 - 100	168.249	100	32	30	CAT40 x SAF25	PNER16 - 50	PNER16	1.61
29542 - 150	CAT40 x SAFP16 - 150	218.249	150	82	30	CAT40 x SAF25	PNER16 - 100	PNER16	1.85
29544	CAT40 x SAFP20 - 100	168.249	100	33	32	CAT40 x SAF25	PNER20 - 50	PNER20	1.62
29544 - 150	CAT40 x SAFP20 - 150	218.249	150	83	32	CAT40 x SAF25	PNER20 - 100	PNER20	1.88
29546	CAT40 x SAFP25 - 110	178.249	110	28.9	40	CAT40 x SAF40	PNER25 - 50	PNER25	2.64
29546 - 160	CAT40 x SAFP25 - 160	228.249	160	78.9	40	CAT40 x SAF40	PNER25 - 100	PNER25	3.06
29548	CAT40 x SAFP32 - 120	188.249	120	40.9	50	CAT40 x SAF40	PNER32 - 60	PNER32	2.79
29548 - 160	CAT40 x SAFP32 - 160	228.249	160	80.9	50	CAT40 x SAF40	PNER32 - 100	PNER32	3.34
29550	CAT50 x SAFP16 - 110	211.6	110	32	30	CAT50 x SAF25	PNER16 - 50	PNER16	3.88
29550 - 160	CAT50 x SAFP16 - 160	261.6	160	82	30	CAT50 x SAF25	PNER16 - 100	PNER16	4.12
29552	CAT50 x SAFP20 - 110	211.6	110	33	32	CAT50 x SAF25	PNER20 - 50	PNER20	3.89
29552 - 160	CAT50 x SAFP20 - 160	261.6	160	83	32	CAT50 x SAF25	PNER20 - 100	PNER20	4.15
29554	CAT50 x SAFP25 - 110	211.6	110	28.9	40	CAT50 x SAF40	PNER25 - 50	PNER25	4.70
29554 - 160	CAT50 x SAFP25 - 160	261.6	160	78.9	40	CAT50 x SAF40	PNER25 - 100	PNER25	5.12
29556	CAT50 x SAFP32 - 120	221.6	120	40.9	50	CAT50 x SAF40	PNER32 - 60	PNER32	4.85
29556 - 160	CAT50 x SAFP32 - 160	261.6	160	80.9	50	CAT50 x SAF40	PNER32 - 100	PNER32	5.40

Features:

- ▶ Flange adapter: PNER.
- ▶ Drive axial and radial set screws for precision adjustment and the runout accuracy of the tool edge can be adjusted within 5 μm.

Standard Accessory: • NUT

Collet	Nut	Pull Stud	Preset Screw	Spanner
P.W-4	P.W-39	P.W-56	P.W-82	P.W-62~67

CAT / SAF RUNOUT ADJUSTABLE HOLDER



CAT / SAF 可調式刀桿



T W PAT NO. M298033
 T W PAT NO. M311791
 J P PAT NO. 3128766
 J P PAT NO. 3200356
 K R PAT NO. 20-0433603
 C N PAT NO. ZL200620132661.0
 C H PAT NO. 696550
 T R PAT NO. TR 2007 02942 Y
 I T PAT NO. N.0000266731

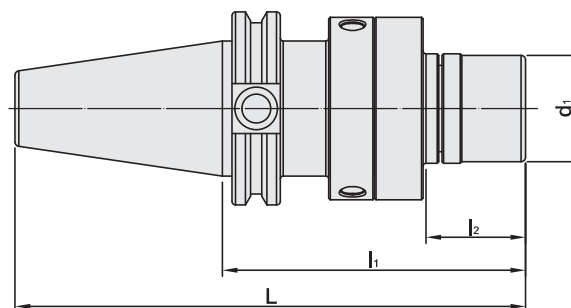

MODEL NO.	TYPE	L	l ₁	l ₂	d ₁	COMBINATION		COLLET	WEIGHT (KGS)
						BODY	FLANGE ADAPTER		
29562	CAT40 x SAFU16 - 100	168.249	100	32	30	CAT40 x SAF25	UT16 - 50	ER16	1.66
29564	CAT40 x SAFU20 - 100	168.249	100	33	35	CAT40 x SAF25	UT20 - 50	ER20	1.68
29566	CAT40 x SAFU25 - 120	188.249	120	38.9	42	CAT40 x SAF40	UT25 - 60	ER25	2.80
29568	CAT40 x SAFU32 - 120	188.249	120	40.9	48	CAT40 x SAF40	UT32 - 60	ER32	2.83
29570	CAT50 x SAFU16 - 110	211.6	110	32	30	CAT50 x SAF25	UT16 - 50	ER16	3.93
29572	CAT50 x SAFU20 - 110	211.6	110	33	35	CAT50 x SAF25	UT20 - 50	ER20	3.95
29574	CAT50 x SAFU25 - 120	221.6	120	38.9	42	CAT50 x SAF40	UT25 - 60	ER25	4.86
29576	CAT50 x SAFU32 - 120	221.6	120	40.9	48	CAT50 x SAF40	UT32 - 60	ER32	4.89

Features:

- ▶ Flange adapter: UT.
- ▶ Drive axial and radial set screws for precision adjustment and the runout accuracy of the tool edge can be adjusted within 5 μm.

Standard Accessory: • NUT

Collet	Nut	Pull Stud	Preset Screw	Spanner
P.W-6~9	P.W-41	P.W-56	P.W-82	P.W-62~67



DAT / SAF RUNOUT ADJUSTABLE HOLDER

4.5°



DAT / SAF 可調式刀桿

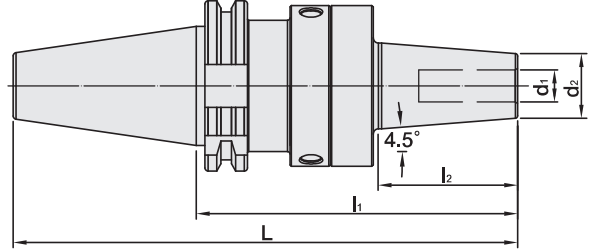

MODEL NO.	TYPE	L	l ₁	l ₂	d ₁	d ₂	COMBINATION		WEIGHT (KGS)
							BODY	FLANGE ADAPTER	
49380	DAT40 x SAFC6 - 120	188.4	120	52	6	21	DAT40 x SAF25	SFC6 - 70	1.74
49382	DAT40 x SAFC8 - 120	188.4	120	52	8	21	DAT40 x SAF25	SFC8 - 70	1.73
49384	DAT40 x SAFC10 - 120	188.4	120	52	10	24	DAT40 x SAF25	SFC10 - 70	1.78
49386	DAT40 x SAFC12 - 120	188.4	120	52	12	24	DAT40 x SAF25	SFC12 - 70	1.76
49388	DAT40 x SAFC16 - 125	193.4	125	57	16	27	DAT40 x SAF25	SFC16 - 75	1.81
49390	DAT40 x SAFC20 - 140	208.4	140	60	20	33	DAT40 x SAF40	SFC20 - 80	2.92
49392	DAT40 x SAFC25 - 160	228.4	160	81	25	44	DAT40 x SAF40	SFC25 - 100	3.45
49394	DAT40 x SAFC32 - 160	228.4	160	81	32	44	DAT40 x SAF40	SFC32 - 100	3.31
49396	DAT50 x SAFC6 - 130	231.75	130	52	6	21	DAT50 x SAF25	SFC6 - 70	3.88
49398	DAT50 x SAFC8 - 130	231.75	130	52	8	21	DAT50 x SAF25	SFC8 - 70	3.87
49400	DAT50 x SAFC10 - 130	231.75	130	52	10	24	DAT50 x SAF25	SFC10 - 70	3.92
49402	DAT50 x SAFC12 - 130	231.75	130	52	12	24	DAT50 x SAF25	SFC12 - 70	3.90
49404	DAT50 x SAFC16 - 135	236.75	135	57	16	27	DAT50 x SAF25	SFC16 - 75	3.95
49406	DAT50 x SAFC20 - 140	241.75	140	60	20	33	DAT50 x SAF40	SFC20 - 80	5.11
49408	DAT50 x SAFC25 - 160	261.75	160	81	25	44	DAT50 x SAF40	SFC25 - 100	5.64
49410	DAT50 x SAFC32 - 160	261.75	160	81	32	44	DAT50 x SAF40	SFC32 - 100	5.50

Features:

- ▶ Flange adapter: SFC.
- ▶ Drive axial and radial set screws for precision adjustment and the runout accuracy of the tool edge can be adjusted within 5 μm.

Pull Stud



P.W-57

Preset Screw



P.W-82

DAT / SAF RUNOUT ADJUSTABLE HOLDER

DAT / SAF 可調式刀桿

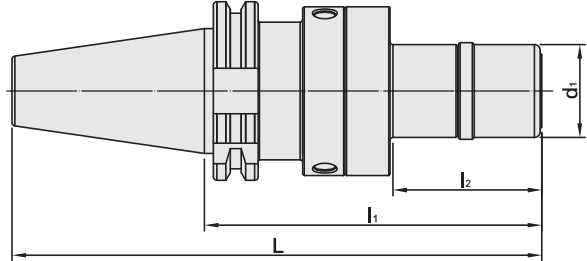

MODEL NO.	TYPE	L	l ₁	l ₂	d ₁	COMBINATION		COLLET	WEIGHT (KGS)
						BODY	FLANGE ADAPTER		
49302	DAT40 x SAFK6 - 100	168.4	100	29	19.5	DAT40 x SAF25	SK306 - 50	SKS6	1.61
49304	DAT40 x SAFK6 - 150	218.4	150	79	19.5	DAT40 x SAF25	SK306 - 100	SKS6	1.70
49306	DAT40 x SAFK10 - 100	168.4	100	32.5	27.5	DAT40 x SAF25	SK310 - 50	SKS10	1.64
49308	DAT40 x SAFK10 - 150	218.4	150	82.5	27.5	DAT40 x SAF25	SK310 - 100	SKS10	1.83
49310	DAT40 x SAFK13 - 120	188.4	120	53	33	DAT40 x SAF25	SK313 - 70	SKS13	1.77
49312	DAT40 x SAFK13 - 150	218.4	150	83	33	DAT40 x SAF25	SK313 - 100	SKS13	1.95
49314	DAT40 x SAFK16 - 130	198.4	130	49.9	40	DAT40 x SAF40	SK316 - 70	SKS16	2.81
49316	DAT40 x SAFK16 - 160	228.4	160	79.9	40	DAT40 x SAF40	SK316 - 100	SKS16	3.07
49318	DAT50 x SAFK6 - 110	211.75	110	29	19.5	DAT50 x SAF25	SK306 - 50	SKS6	3.75
49320	DAT50 x SAFK6 - 160	261.75	160	79	19.5	DAT50 x SAF25	SK306 - 100	SKS6	3.84
49322	DAT50 x SAFK10 - 110	211.75	110	32.5	27.5	DAT50 x SAF25	SK310 - 50	SKS10	3.78
49324	DAT50 x SAFK10 - 160	261.75	160	82.5	27.5	DAT50 x SAF25	SK310 - 100	SKS10	3.97
49326	DAT50 x SAFK13 - 130	231.75	130	53	33	DAT50 x SAF25	SK313 - 70	SKS13	3.91
49328	DAT50 x SAFK13 - 160	261.75	160	83	33	DAT50 x SAF25	SK313 - 100	SKS13	4.09
49330	DAT50 x SAFK16 - 130	231.75	130	49.9	40	DAT50 x SAF40	SK316 - 70	SKS16	5.00
49332	DAT50 x SAFK16 - 160	261.75	160	79.9	40	DAT50 x SAF40	SK316 - 100	SKS16	5.26

Features:

- ▶ Flange adapter: SK3.
- ▶ Drive axial and radial set screws for precision adjustment and the runout accuracy of the tool edge can be adjusted within 5 μm.

Standard Accessory: • NUT

Collet	Nut	Pull Stud	Preset Screw	Spanner
P.W-25~28	P.W-46	P.W-57	P.W-82	P.W-62~67



DAT / SAF RUNOUT ADJUSTABLE HOLDER



DAT / SAF 可調式刀桿



T W PAT NO. M298033
 T W PAT NO. M311791
 T W PAT NO. M501316
 J P PAT NO. 3128766
 J P PAT NO. 3200356
 K R PAT NO. 20-0433603
 C N PAT NO. ZL200620132661.0
 C H PAT NO. 696550
 T R PAT NO. TR 2007 02942 Y
 I T PAT NO. N.0000266731
 D E PAT NO. Nr.202015005621

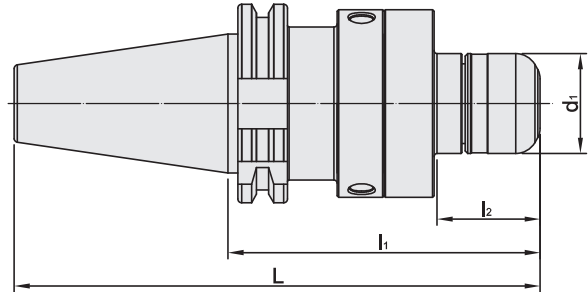

MODEL NO.	TYPE	L	l ₁	l ₂	d ₁	COMBINATION		COLLET	WEIGHT (KGS)
						BODY	FLANGE ADAPTER		
49342	DAT40 x SAFP16 - 100	168.4	100	32	30	DAT40 x SAF25	PNER16 - 50	PNER16	1.64
49342 - 150	DAT40 x SAFP16 - 150	218.4	150	82	30	DAT40 x SAF25	PNER16 - 100	PNER16	1.88
49344	DAT40 x SAFP20 - 100	168.4	100	33	32	DAT40 x SAF25	PNER20 - 50	PNER20	1.65
49344 - 150	DAT40 x SAFP20 - 150	218.4	150	83	32	DAT40 x SAF25	PNER20 - 100	PNER20	1.91
49346	DAT40 x SAFP25 - 110	178.4	110	28.9	40	DAT40 x SAF40	PNER25 - 50	PNER25	2.66
49346 - 160	DAT40 x SAFP25 - 160	228.4	160	78.9	40	DAT40 x SAF40	PNER25 - 100	PNER25	3.08
49348	DAT40 x SAFP32 - 120	188.4	120	40.9	50	DAT40 x SAF40	PNER32 - 60	PNER32	2.81
49348 - 160	DAT40 x SAFP32 - 160	228.4	160	80.9	50	DAT40 x SAF40	PNER32 - 100	PNER32	3.36
49350	DAT50 x SAFP16 - 110	211.75	110	32	30	DAT50 x SAF25	PNER16 - 50	PNER16	3.78
49350 - 160	DAT50 x SAFP16 - 160	261.75	160	82	30	DAT50 x SAF25	PNER16 - 100	PNER16	4.02
49352	DAT50 x SAFP20 - 110	211.75	110	33	32	DAT50 x SAF25	PNER20 - 50	PNER20	3.79
49352 - 160	DAT50 x SAFP20 - 160	261.75	160	83	32	DAT50 x SAF25	PNER20 - 100	PNER20	4.05
49354	DAT50 x SAFP25 - 110	211.75	110	28.9	40	DAT40 x SAF40	PNER25 - 50	PNER25	4.85
49354 - 160	DAT50 x SAFP25 - 160	261.75	160	78.9	40	DAT40 x SAF40	PNER25 - 100	PNER25	5.27
49356	DAT50 x SAFP32 - 120	221.75	120	40.9	50	DAT50 x SAF40	PNER32 - 60	PNER32	5.00
49356 - 160	DAT50 x SAFP32 - 160	261.75	160	80.9	50	DAT40 x SAF40	PNER32 - 100	PNER32	5.55

Features:

- ▶ Flange adapter: PNER.
- ▶ Drive axial and radial set screws for precision adjustment and the runout accuracy of the tool edge can be adjusted within 5 μm.

Standard Accessory: • NUT

Collet	Nut	Pull Stud	Preset Screw	Spanner
P.W-4	P.W-39	P.W-57	P.W-82	P.W-62~67

DAT / SAF RUNOUT ADJUSTABLE HOLDER



DAT / SAF 可調式刀桿



T W PAT NO. M298033
 T W PAT NO. M311791
 J P PAT NO. 3128766
 J P PAT NO. 3200356
 K R PAT NO. 20-0433603
 C N PAT NO. ZL200620132661.0
 C H PAT NO. 696550
 T R PAT NO. TR 2007 02942 Y
 I T PAT NO. N.0000266731

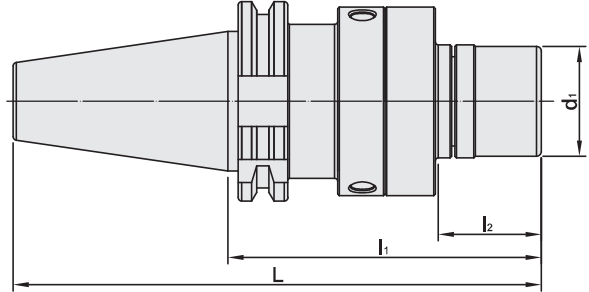

MODEL NO.	TYPE	L	l ₁	l ₂	d ₁	COMBINATION		COLLET	WEIGHT (KGS)
						BODY	FLANGE ADAPTER		
49362	DAT40 x SAFU16 - 100	168.4	100	32	30	DAT40 x SAF25	UT16 - 50	ER16	1.69
49364	DAT40 x SAFU20 - 100	168.4	100	33	35	DAT40 x SAF25	UT20 - 50	ER20	1.71
49366	DAT40 x SAFU25 - 120	188.4	120	38.9	42	DAT40 x SAF40	UT25 - 60	ER25	2.82
49368	DAT40 x SAFU32 - 120	188.4	120	40.9	48	DAT40 x SAF40	UT32 - 60	ER32	2.85
49370	DAT50 x SAFU16 - 110	211.75	110	32	30	DAT50 x SAF25	UT16 - 50	ER16	3.83
49372	DAT50 x SAFU20 - 110	211.75	110	33	35	DAT50 x SAF25	UT20 - 50	ER20	3.85
49374	DAT50 x SAFU25 - 120	221.75	120	38.9	42	DAT50 x SAF40	UT25 - 60	ER25	5.01
49376	DAT50 x SAFU32 - 120	221.75	120	40.9	48	DAT50 x SAF40	UT32 - 60	ER32	5.04

Features:

- ▶ Flange adapter: UT.
- ▶ Drive axial and radial set screws for precision adjustment and the runout accuracy of the tool edge can be adjusted within 5 μm.

Standard Accessory: • NUT

Collet	Nut	Pull Stud	Preset Screw	Spanner
P.W-6~9	P.W-41	P.W-57	P.W-82	P.W-62~67



SBT / SAF RUNOUT ADJUSTABLE HOLDER

Dual
DRIVE+

4.5°

SBT / SAF 法蘭加厚型可調式刀桿

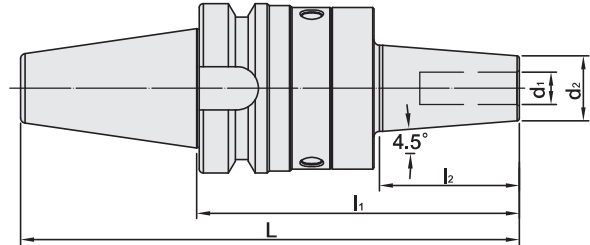

MODEL NO.	TYPE	L	l ₁	l ₂	d ₁	d ₂	COMBINATION		WEIGHT (KGS)
							BODY	FLANGE ADAPTER	
25.783.06C.110	SBT30 x SAF C6 - 110	158.4	110	52	6	21	SBT30 x SAF25	SFC6 - 70	1.13
25.783.08C.110	SBT30 x SAF C8 - 110	158.4	110	52	8	21	SBT30 x SAF25	SFC8 - 70	1.12
25.783.10C.110	SBT30 x SAF C10 - 110	158.4	110	52	10	24	SBT30 x SAF25	SFC10 - 70	1.17
25.783.12C.110	SBT30 x SAF C12 - 110	158.4	110	52	12	24	SBT30 x SAF25	SFC12 - 70	1.15
25.783.16C.115	SBT30 x SAF C16 - 115	163.4	115	57	16	27	SBT30 x SAF25	SFC16 - 75	1.20
26.783.06C.120	SBT40 x SAF C6 - 120	185.4	120	52	6	21	SBT40 x SAF25	SFC6 - 70	1.87
26.783.08C.120	SBT40 x SAF C8 - 120	185.4	120	52	8	21	SBT40 x SAF25	SFC8 - 70	1.86
26.783.10C.120	SBT40 x SAF C10 - 120	185.4	120	52	10	24	SBT40 x SAF25	SFC10 - 70	1.91
26.783.12C.120	SBT40 x SAF C12 - 120	185.4	120	52	12	24	SBT40 x SAF25	SFC12 - 70	1.89
26.783.16C.125	SBT40 x SAF C16 - 125	190.4	125	57	16	27	SBT40 x SAF25	SFC16 - 75	1.94
26.783.20C.130	SBT40 x SAF C20 - 130	195.4	130	60	20	33	SBT40 x SAF40	SFC20 - 80	2.68
26.783.25C.150	SBT40 x SAF C25 - 150	215.4	150	81	25	44	SBT40 x SAF40	SFC25 - 100	3.21
26.783.32C.150	SBT40 x SAF C32 - 150	215.4	150	81	32	44	SBT40 x SAF40	SFC32 - 100	3.07
27.783.06C.130	SBT50 x SAF C6 - 130	231.8	130	52	6	21	SBT50 x SAF25	SFC6 - 70	4.38
27.783.08C.130	SBT50 x SAF C8 - 130	231.8	130	52	8	21	SBT50 x SAF25	SFC8 - 70	4.37
27.783.10C.130	SBT50 x SAF C10 - 130	231.8	130	52	10	24	SBT50 x SAF25	SFC10 - 70	4.42
27.783.12C.130	SBT50 x SAF C12 - 130	231.8	130	52	12	24	SBT50 x SAF25	SFC12 - 70	4.40
27.783.16C.135	SBT50 x SAF C16 - 135	236.8	135	57	16	27	SBT50 x SAF25	SFC16 - 75	4.45
27.783.20C.140	SBT50 x SAF C20 - 140	241.8	140	60	20	33	SBT50 x SAF40	SFC20 - 80	5.30
27.783.25C.160	SBT50 x SAF C25 - 160	261.8	160	81	25	44	SBT50 x SAF40	SFC25 - 100	5.83
27.783.32C.160	SBT50 x SAF C32 - 160	261.8	160	81	32	44	SBT50 x SAF40	SFC32 - 100	5.69

Features:

- ▶ Flange adapter: SFC.
- ▶ Drive axial and radial set screws for precision adjustment and the runout accuracy of the tool edge can be adjusted within 5 μm.

Pull Stud

Preset Screw



P.W-54~55

P.W-82

SBT / SAF RUNOUT ADJUSTABLE HOLDER



SBT / SAF 法蘭加厚型可調式刀桿

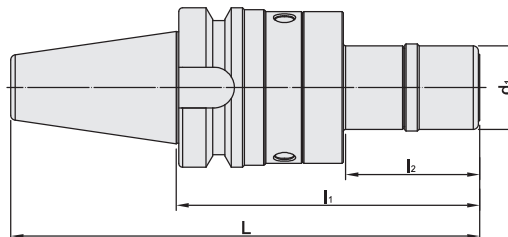

MODEL NO.	TYPE	L	l ₁	l ₂	d ₁	COMBINATION		COLLET	WEIGHT (KGS)
						BODY	FLANGE ADAPTER		
25.783.06K.090	SBT30 x SAFK6 - 90	138.4	90	29	19.5	SBT30 x SAF25	SK306 - 50	SKS6	1.00
25.783.10K.090	SBT30 x SAFK10 - 90	138.4	90	32.5	27.5	SBT30 x SAF25	SK310 - 50	SKS10	1.03
25.783.13K.110	SBT30 x SAFK13 - 110	158.4	110	53	33	SBT30 x SAF25	SK313 - 70	SKS13	1.16
26.783.06K.100	SBT40 x SAFK6 - 100	165.4	100	29	19.5	SBT40 x SAF25	SK306 - 50	SKS6	1.74
26.783.06K.150	SBT40 x SAFK6 - 150	215.4	150	79	19.5	SBT40 x SAF25	SK306 - 100	SKS6	1.83
26.783.10K.100	SBT40 x SAFK10 - 100	165.4	100	32.5	27.5	SBT40 x SAF25	SK310 - 50	SKS10	1.77
26.783.10K.150	SBT40 x SAFK10 - 150	215.4	150	82.5	27.5	SBT40 x SAF25	SK310 - 100	SKS10	1.96
26.783.13K.120	SBT40 x SAFK13 - 120	185.4	120	53	33	SBT40 x SAF25	SK313 - 70	SKS13	1.90
26.783.13K.150	SBT40 x SAFK13 - 150	215.4	150	83	33	SBT40 x SAF25	SK313 - 100	SKS13	2.08
26.783.16K.120	SBT40 x SAFK16 - 120	185.4	120	49.9	40	SBT40 x SAF40	SK316 - 70	SKS16	2.57
26.783.16K.150	SBT40 x SAFK16 - 150	215.4	150	79.9	40	SBT40 x SAF40	SK316 - 100	SKS16	2.83
27.783.06K.110	SBT50 x SAFK6 - 110	211.8	110	29	19.5	SBT50 x SAF25	SK306 - 50	SKS6	4.25
27.783.06K.160	SBT50 x SAFK6 - 160	261.8	160	79	19.5	SBT50 x SAF25	SK306 - 100	SKS6	4.34
27.783.10K.110	SBT50 x SAFK10 - 110	211.8	110	32.5	27.5	SBT50 x SAF25	SK310 - 50	SKS10	4.28
27.783.10K.160	SBT50 x SAFK10 - 160	261.8	160	82.5	27.5	SBT50 x SAF25	SK310 - 100	SKS10	4.47
27.783.13K.130	SBT50 x SAFK13 - 130	231.8	130	53	33	SBT50 x SAF25	SK313 - 70	SKS13	4.41
27.783.13K.160	SBT50 x SAFK13 - 160	261.8	160	83	33	SBT50 x SAF25	SK313 - 100	SKS13	4.59
27.783.16K.130	SBT50 x SAFK16 - 130	231.8	130	49.9	40	SBT50 x SAF40	SK316 - 70	SKS16	5.19
27.783.16K.160	SBT50 x SAFK16 - 160	261.8	160	79.9	40	SBT50 x SAF40	SK316 - 100	SKS16	5.45

Features:

- ▶ Flange adapter: SK3.
- ▶ Drive axial and radial set screws for precision adjustment and the runout accuracy of the tool edge can be adjusted within 5 μm.

Standard Accessory: • NUT

Collet	Nut	Pull Stud	Preset Screw	Spanner
P.W-25~28	P.W-46	P.W-54~55	P.W-82	P.W-62~67



SBT / SAF RUNOUT ADJUSTABLE HOLDER



SBT / SAF 法蘭加厚型可調式刀桿



T W PAT NO. M298033
 T W PAT NO. M311791
 T W PAT NO. M501316
 J P PAT NO. 3128766
 J P PAT NO. 3200356
 K R PAT NO. 20-0433603
 C N PAT NO. ZL200620132661.0
 C H PAT NO. 696550
 T R PAT NO. TR 2007 02942 Y
 I T PAT NO. N.0000266731
 D E PAT NO. Nr.202015005621

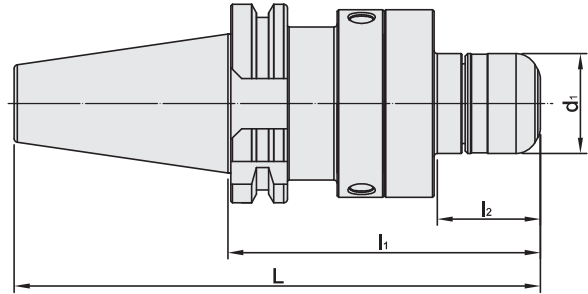

MODEL NO.	TYPE	L	l ₁	l ₂	d ₁	COMBINATION		COLLET	WEIGHT (KGS)
						BODY	FLANGE ADAPTER		
25.783.16P.090	SBT30 x SAFP16 - 90	138.4	90	32	30	SBT30 x SAF25	PNER16 - 50	PNER16	1.03
25.783.20P.090	SBT30 x SAFP20 - 90	138.4	90	33	32	SBT30 x SAF25	PNER20 - 50	PNER20	1.04
26.783.16P.100	SBT40 x SAFP16 - 100	165.4	100	32	30	SBT40 x SAF25	PNER16 - 50	PNER16	1.77
26.783.16P.150	SBT40 x SAFP16 - 150	215.4	150	82	30	SBT40 x SAF25	PNER16 - 100	PNER16	2.01
26.783.20P.100	SBT40 x SAFP20 - 100	165.4	100	33	32	SBT40 x SAF25	PNER20 - 50	PNER20	1.78
26.783.20P.150	SBT40 x SAFP20 - 150	215.4	150	83	32	SBT40 x SAF25	PNER20 - 100	PNER20	2.04
26.783.25P.100	SBT40 x SAFP25 - 100	165.4	100	28.9	40	SBT40 x SAF40	PNER25 - 50	PNER25	2.42
26.783.25P.150	SBT40 x SAFP25 - 150	215.4	150	78.9	40	SBT40 x SAF40	PNER25 - 100	PNER25	2.84
26.783.32P.110	SBT40 x SAFP32 - 110	175.4	110	40.9	50	SBT40 x SAF40	PNER32 - 60	PNER32	2.57
26.783.32P.150	SBT40 x SAFP32 - 150	215.4	150	80.9	50	SBT40 x SAF40	PNER32 - 100	PNER32	3.12
27.783.16P.110	SBT50 x SAFP16 - 110	211.8	110	32	30	SBT50 x SAF25	PNER16 - 50	PNER16	4.28
27.783.16P.160	SBT50 x SAFP16 - 160	261.8	160	82	30	SBT50 x SAF25	PNER16 - 100	PNER16	4.52
27.783.20P.110	SBT50 x SAFP20 - 110	211.8	110	33	32	SBT50 x SAF25	PNER20 - 50	PNER20	4.29
27.783.20P.160	SBT50 x SAFP20 - 160	261.8	160	83	32	SBT50 x SAF25	PNER20 - 100	PNER20	4.55
27.783.25P.110	SBT50 x SAFP25 - 110	211.8	110	28.9	40	SBT50 x SAF40	PNER25 - 50	PNER25	5.04
27.783.25P.160	SBT50 x SAFP25 - 160	261.8	160	78.9	40	SBT50 x SAF40	PNER25 - 100	PNER25	5.46
27.783.32P.120	SBT50 x SAFP32 - 120	221.8	120	40.9	50	SBT50 x SAF40	PNER32 - 60	PNER32	5.19
27.783.32P.160	SBT50 x SAFP32 - 160	261.8	160	80.9	50	SBT50 x SAF40	PNER32 - 100	PNER32	5.74

Features:

- ▶ Flange adapter: PNER.
- ▶ Drive axial and radial set screws for precision adjustment and the runout accuracy of the tool edge can be adjusted within 5 μm.

Standard Accessory: • NUT

Collet	Nut	Pull Stud	Preset Screw	Spanner
P.W-4	P.W-39	P.W-54~55	P.W-82	P.W-62~67

SBT / SAF RUNOUT ADJUSTABLE HOLDER



SBT / SAF 法蘭加厚型可調式刀桿



T W PAT NO. M298033
 T W PAT NO. M311791
 J P PAT NO. 3128766
 J P PAT NO. 3200356
 K R PAT NO. 20-0433603
 C N PAT NO. ZL200620132661.0
 C H PAT NO. 696550
 T R PAT NO. TR 2007 02942 Y
 I T PAT NO. N.0000266731

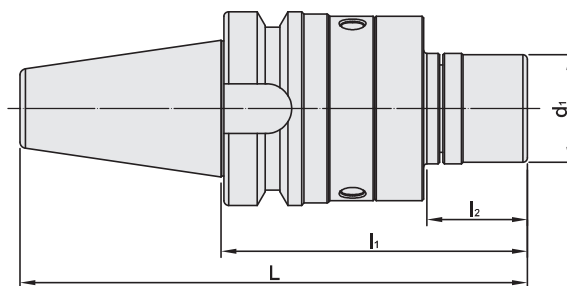

MODEL NO.	TYPE	L	l ₁	l ₂	d ₁	COMBINATION		COLLET	WEIGHT (KGS)
						BODY	FLANGE ADAPTER		
25.783.16U.090	SBT30 x SAFU16 - 90	138.4	90	32	30	SBT30 x SAF25	UT16 - 50	ER16	1.08
25.783.20U.090	SBT30 x SAFU20 - 90	138.4	90	33	35	SBT30 x SAF25	UT20 - 50	ER20	1.10
26.783.16U.100	SBT40 x SAFU16 - 100	165.4	100	32	30	SBT30 x SAF25	UT16 - 50	ER16	1.82
26.783.20U.100	SBT40 x SAFU20 - 100	165.4	100	33	35	SBT40 x SAF25	UT20 - 50	ER20	1.84
26.783.25U.110	SBT40 x SAFU25 - 110	175.4	110	38.9	42	SBT40 x SAF40	UT25 - 60	ER25	2.58
26.783.32U.110	SBT40 x SAFU32 - 110	175.4	110	40.9	48	SBT40 x SAF40	UT32 - 60	ER32	2.61
27.783.16U.110	SBT50 x SAFU16 - 110	211.8	110	32	30	SBT50 x SAF25	UT16 - 50	ER16	4.33
27.783.20U.110	SBT50 x SAFU20 - 110	211.8	110	33	35	SBT50 x SAF25	UT20 - 50	ER20	4.35
27.783.25U.120	SBT50 x SAFU25 - 120	221.8	120	38.9	42	SBT50 x SAF40	UT25 - 60	ER25	5.20
27.783.32U.120	SBT50 x SAFU32 - 120	221.8	120	40.9	48	SBT50 x SAF40	UT32 - 60	ER32	5.23

Features:

- ▶ Flange adapter: UT.
- ▶ Drive axial and radial set screws for precision adjustment and the runout accuracy of the tool edge can be adjusted within 5 μm.

Standard Accessory: • NUT

Collet	Nut	Pull Stud	Preset Screw	Spanner
P.W-6~9	P.W-41	P.W-54~55	P.W-82	P.W-62~67



SCAT / SAF RUNOUT ADJUSTABLE HOLDER

Dual
DRIVE+

4.5°

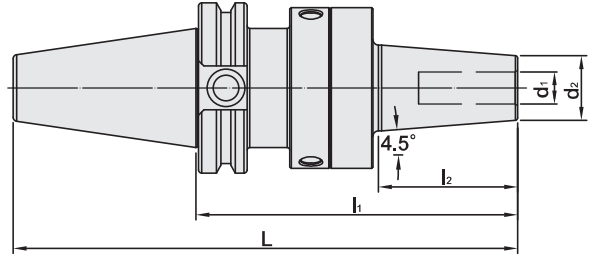

SCAT / SAF 法蘭加厚型可調式刀桿



MODEL NO.	TYPE	L	l ₁	l ₂	d ₁	d ₂	COMBINATION		WEIGHT (KGS)
							BODY	FLANGE ADAPTER	
43.783.06C.120	SCAT40 x SAF C6 - 120	188.249	120	52	6	21	SCAT40 x SAF25	SFC6 - 70	1.74
43.783.08C.120	SCAT40 x SAF C8 - 120	188.249	120	52	8	21	SCAT40 x SAF25	SFC8 - 70	1.73
43.783.10C.120	SCAT40 x SAF C10 - 120	188.249	120	52	10	24	SCAT40 x SAF25	SFC10 - 70	1.78
43.783.12C.120	SCAT40 x SAF C12 - 120	188.249	120	52	12	24	SCAT40 x SAF25	SFC12 - 70	1.76
43.783.16C.125	SCAT40 x SAF C16 - 125	193.249	125	57	16	27	SCAT40 x SAF25	SFC16 - 75	1.81
43.783.20C.140	SCAT40 x SAF C20 - 140	208.249	140	60	20	33	SCAT40 x SAF40	SFC20 - 80	2.92
43.783.25C.160	SCAT40 x SAF C25 - 160	228.249	160	81	25	44	SCAT40 x SAF40	SFC25 - 100	3.45
43.783.32C.160	SCAT40 x SAF C32 - 160	228.249	160	81	32	44	SCAT40 x SAF40	SFC32 - 100	3.31
44.783.06C.130	SCAT50 x SAF C6 - 130	231.6	130	52	6	21	SCAT50 x SAF25	SFC6 - 70	4.02
44.783.08C.130	SCAT50 x SAF C8 - 130	231.6	130	52	8	21	SCAT50 x SAF25	SFC8 - 70	4.01
44.783.10C.130	SCAT50 x SAF C10 - 130	231.6	130	52	10	24	SCAT50 x SAF25	SFC10 - 70	4.06
44.783.12C.130	SCAT50 x SAF C12 - 130	231.6	130	52	12	24	SCAT50 x SAF25	SFC12 - 70	4.04
44.783.16C.135	SCAT50 x SAF C16 - 135	236.6	135	57	16	27	SCAT50 x SAF25	SFC16 - 75	4.09
44.783.20C.140	SCAT50 x SAF C20 - 140	241.6	140	60	20	33	SCAT50 x SAF40	SFC20 - 80	5.00
44.783.25C.160	SCAT50 x SAF C25 - 160	261.6	160	81	25	44	SCAT50 x SAF40	SFC25 - 100	5.53
44.783.32C.160	SCAT50 x SAF C32 - 160	261.6	160	81	32	44	SCAT50 x SAF40	SFC32 - 100	5.39

Features:

- ▶ Flange adapter: SFC.
- ▶ Drive axial and radial set screws for precision adjustment and the runout accuracy of the tool edge can be adjusted within 5 μm.

Pull Stud	Preset Screw
	
P.W-56	P.W-82

SCAT / SAF RUNOUT ADJUSTABLE HOLDER



SCAT / SAF 法蘭加厚型可調式刀桿

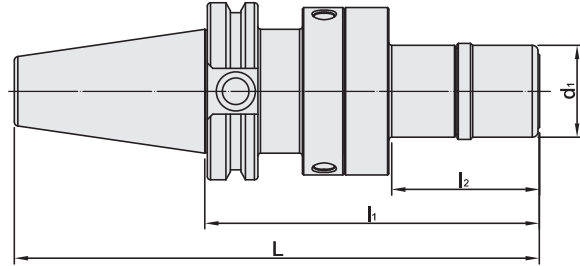

MODEL NO.	TYPE	L	l ₁	l ₂	d ₁	COMBINATION		COLLET	WEIGHT (KGS)
						BODY	FLANGE ADAPTER		
43.783.06K.100	SCAT40 x SAFK6 - 100	168.249	100	29	19.5	SCAT40 x SAF25	SK306 - 50	SKS6	1.61
43.783.06K.150	SCAT40 x SAFK6 - 150	218.249	150	79	19.5	SCAT40 x SAF25	SK306 - 100	SKS6	1.70
43.783.10K.100	SCAT40 x SAFK10 - 100	168.249	100	32.5	27.5	SCAT40 x SAF25	SK310 - 50	SKS10	1.64
43.783.10K.150	SCAT40 x SAFK10 - 150	218.249	150	82.5	27.5	SCAT40 x SAF25	SK310 - 100	SKS10	1.83
43.783.13K.120	SCAT40 x SAFK13 - 120	188.249	120	53	33	SCAT40 x SAF25	SK313 - 70	SKS13	1.77
43.783.13K.150	SCAT40 x SAFK13 - 150	218.249	150	83	33	SCAT40 x SAF25	SK313 - 100	SKS13	1.95
43.783.16K.130	SCAT40 x SAFK16 - 130	198.249	130	49.9	40	SCAT40 x SAF40	SK316 - 70	SKS16	2.81
43.783.16K.160	SCAT40 x SAFK16 - 160	228.249	160	79.9	40	SCAT40 x SAF40	SK316 - 100	SKS16	3.07
44.783.06K.110	SCAT50 x SAFK6 - 110	211.6	110	29	19.5	SCAT50 x SAF25	SK306 - 50	SKS6	3.89
44.783.06K.160	SCAT50 x SAFK6 - 160	261.6	160	79	19.5	SCAT50 x SAF25	SK306 - 100	SKS6	3.98
44.783.10K.110	SCAT50 x SAFK10 - 110	211.6	110	32.5	27.5	SCAT50 x SAF25	SK310 - 50	SKS10	3.92
44.783.10K.160	SCAT50 x SAFK10 - 160	261.6	160	82.5	27.5	SCAT50 x SAF25	SK310 - 100	SKS10	4.11
44.783.13K.130	SCAT50 x SAFK13 - 130	231.6	130	53	33	SCAT50 x SAF25	SK313 - 70	SKS13	4.05
44.783.13K.160	SCAT50 x SAFK13 - 160	261.6	160	83	33	SCAT50 x SAF25	SK313 - 100	SKS13	4.23
44.783.16K.130	SCAT50 x SAFK16 - 130	231.6	130	49.9	40	SCAT50 x SAF40	SK316 - 70	SKS16	4.89
44.783.16K.160	SCAT50 x SAFK16 - 160	261.6	160	79.9	40	SCAT50 x SAF40	SK316 - 100	SKS16	5.15

Features:

- ▶ Flange adapter: SK3.
- ▶ Drive axial and radial set screws for precision adjustment and the runout accuracy of the tool edge can be adjusted within 5 µm.

Standard Accessory: • NUT

Collet	Nut	Pull Stud	Preset Screw	Spanner
P.W-25~28	P.W-46	P.W-56	P.W-82	P.W-62~67



SCAT / SAF RUNOUT ADJUSTABLE HOLDER



SCAT / SAF 法蘭加厚型可調式刀桿



T W PAT NO. M298033
 T W PAT NO. M311791
 T W PAT NO. M501316
 J P PAT NO. 3128766
 J P PAT NO. 3200356
 K R PAT NO. 20-0433603
 C N PAT NO. ZL200620132661.0
 C H PAT NO. 696550
 T R PAT NO. TR 2007 02942 Y
 I T PAT NO. N.0000266731
 D E PAT NO. Nr.202015005621

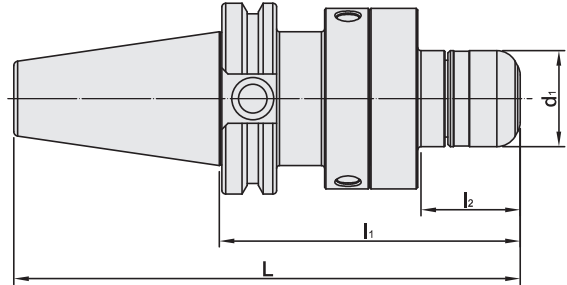

MODEL NO.	TYPE	L	l ₁	l ₂	d ₁	COMBINATION		COLLET	WEIGHT (KGS)
						BODY	FLANGE ADAPTER		
43.783.16P.100	SCAT40 x SAFF16 - 100	168.249	100	32	30	SCAT40 x SAF25	PNER16 - 50	PNER16	1.64
43.783.16P.150	SCAT40 x SAFF16 - 150	218.249	150	82	30	SCAT40 x SAF25	PNER16 - 100	PNER16	1.88
43.783.20P.100	SCAT40 x SAFF20 - 100	168.249	100	33	32	SCAT40 x SAF25	PNER20 - 50	PNER20	1.65
43.783.20P.150	SCAT40 x SAFF20 - 150	218.249	150	83	32	SCAT40 x SAF25	PNER20 - 100	PNER20	1.91
43.783.25P.110	SCAT40 x SAFF25 - 110	178.249	100	28.9	40	SCAT40 x SAF40	PNER25 - 50	PNER25	2.66
43.783.25P.160	SCAT40 x SAFF25 - 160	228.249	160	78.9	40	SCAT40 x SAF40	PNER25 - 100	PNER25	3.08
43.783.32P.120	SCAT40 x SAFF32 - 120	188.249	120	40.9	50	SCAT40 x SAF40	PNER32 - 60	PNER32	2.81
43.783.32P.160	SCAT40 x SAFF32 - 160	228.249	160	80.9	50	SCAT40 x SAF40	PNER32 - 100	PNER32	3.36
44.783.16P.110	SCAT50 x SAFF16 - 110	211.6	110	32	30	SCAT50 x SAF25	PNER16 - 50	PNER16	3.92
44.783.16P.160	SCAT50 x SAFF16 - 160	261.6	160	82	30	SCAT50 x SAF25	PNER16 - 100	PNER16	4.16
44.783.20P.110	SCAT50 x SAFF20 - 110	211.6	110	33	32	SCAT50 x SAF25	PNER20 - 50	PNER20	3.93
44.783.20P.160	SCAT50 x SAFF20 - 160	261.6	160	83	32	SCAT50 x SAF25	PNER20 - 100	PNER20	4.19
44.783.25P.110	SCAT50 x SAFF25 - 110	211.6	110	28.9	40	SCAT50 x SAF40	PNER25 - 50	PNER25	4.74
44.783.25P.160	SCAT50 x SAFF25 - 160	261.6	160	78.9	40	SCAT50 x SAF40	PNER25 - 100	PNER25	5.16
44.783.32P.120	SCAT50 x SAFF32 - 120	221.6	120	40.9	50	SCAT50 x SAF40	PNER32 - 60	PNER32	4.89
44.783.32P.160	SCAT50 x SAFF32 - 160	261.6	160	80.9	50	SCAT50 x SAF40	PNER32 - 100	PNER32	5.44

Features:

- ▶ Flange adapter: PNER.
- ▶ Drive axial and radial set screws for precision adjustment and the runout accuracy of the tool edge can be adjusted within 5 μm.

Standard Accessory: • NUT

Collet	Nut	Pull Stud	Preset Screw	Spanner
P.W-4	P.W-39	P.W-56	P.W-82	P.W-62~67

SCAT / SAF RUNOUT ADJUSTABLE HOLDER



SCAT / SAF 法蘭加厚型可調式刀桿



T W PAT NO. M298033
 T W PAT NO. M311791
 J P PAT NO. 3128766
 J P PAT NO. 3200356
 K R PAT NO. 20-0433603
 C N PAT NO. ZL200620132661.0
 C H PAT NO. 696550
 T R PAT NO. TR 2007 02942 Y
 I T PAT NO. N.0000266731

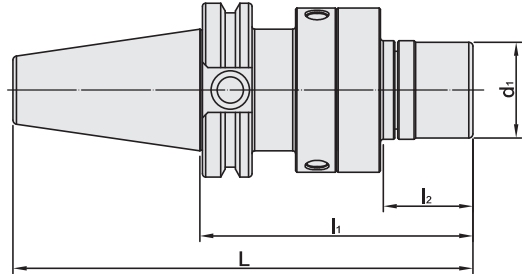

MODEL NO.	TYPE	L	l ₁	l ₂	d ₁	COMBINATION		COLLET	WEIGHT (KGS)
						BODY	FLANGE ADAPTER		
43.783.16U.100	SCAT40 x SAFU16 - 100	168.249	100	32	30	SCAT30 x SAF25	UT16 - 50	ER16	1.69
43.783.20U.100	SCAT40 x SAFU20 - 100	168.249	100	33	35	SCAT40 x SAF25	UT20 - 50	ER20	1.71
43.783.25U.120	SCAT40 x SAFU25 - 120	188.249	120	38.9	42	SCAT40 x SAF40	UT25 - 60	ER25	2.82
43.783.32U.120	SCAT40 x SAFU32 - 120	188.249	120	40.9	48	SCAT40 x SAF40	UT32 - 60	ER32	2.85
44.783.16U.110	SCAT50 x SAFU16 - 110	211.6	110	32	30	SCAT50 x SAF25	UT16 - 50	ER16	3.97
44.783.20U.110	SCAT50 x SAFU20 - 110	211.6	110	33	35	SCAT50 x SAF25	UT20 - 50	ER20	3.99
44.783.25U.120	SCAT50 x SAFU25 - 120	221.6	120	38.9	42	SCAT50 x SAF40	UT25 - 60	ER25	4.90
44.783.32U.120	SCAT50 x SAFU32 - 120	221.6	120	40.9	48	SCAT50 x SAF40	UT32 - 60	ER32	4.93

Features:

- ▶ Flange adapter: UT.
- ▶ Drive axial and radial set screws for precision adjustment and the runout accuracy of the tool edge can be adjusted within 5 µm.

Standard Accessory: • NUT

Collet	Nut	Pull Stud	Preset Screw	Spanner
P.W-6~9	P.W-41	P.W-56	P.W-82	P.W-62~67



SDAT / SAF RUNOUT ADJUSTABLE HOLDER

Dual
DRIVE+

4.5°

SDAT / SAF 法蘭加厚型可調式刀桿

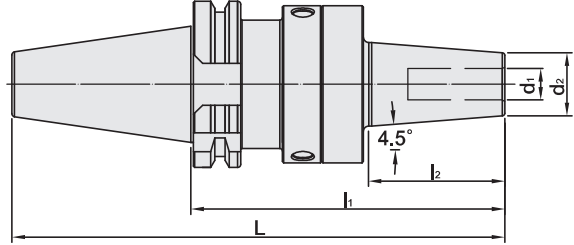

MODEL NO.	TYPE	L	l ₁	l ₂	d ₁	d ₂	COMBINATION		WEIGHT (KGS)
							BODY	FLANGE ADAPTER	
66.783.06C.120	SDAT40 x SAFC6 - 120	188.4	120	52	6	21	SDAT40 x SAF25	SFC6 - 70	1.76
66.783.08C.120	SDAT40 x SAFC8 - 120	188.4	120	52	8	21	SDAT40 x SAF25	SFC8 - 70	1.75
66.783.10C.120	SDAT40 x SAFC10 - 120	188.4	120	52	10	24	SDAT40 x SAF25	SFC10 - 70	1.80
66.783.12C.120	SDAT40 x SAFC12 - 120	188.4	120	52	12	24	SDAT40 x SAF25	SFC12 - 70	1.78
66.783.16C.125	SDAT40 x SAFC16 - 125	193.4	125	57	16	27	SDAT40 x SAF25	SFC16 - 75	1.83
66.783.20C.140	SDAT40 x SAFC20 - 140	208.4	140	60	20	33	SDAT40 x SAF40	SFC20 - 80	2.94
66.783.25C.160	SDAT40 x SAFC25 - 160	228.4	160	81	25	44	SDAT40 x SAF40	SFC25 - 100	3.47
66.783.32C.160	SDAT40 x SAFC32 - 160	228.4	160	81	32	44	SDAT40 x SAF40	SFC32 - 100	3.33
67.783.06C.130	SDAT50 x SAFC6 - 130	231.75	130	52	6	21	SDAT50 x SAF25	SFC6 - 70	3.92
67.783.08C.130	SDAT50 x SAFC8 - 130	231.75	130	52	8	21	SDAT50 x SAF25	SFC8 - 70	3.91
67.783.10C.130	SDAT50 x SAFC10 - 130	231.75	130	52	10	24	SDAT50 x SAF25	SFC10 - 70	3.96
67.783.12C.130	SDAT50 x SAFC12 - 130	231.75	130	52	12	24	SDAT50 x SAF25	SFC12 - 70	3.94
67.783.16C.135	SDAT50 x SAFC16 - 135	236.75	135	57	16	27	SDAT50 x SAF25	SFC16 - 75	3.99
67.783.20C.140	SDAT50 x SAFC20 - 140	241.75	140	60	20	33	SDAT50 x SAF40	SFC20 - 80	5.15
67.783.25C.160	SDAT50 x SAFC25 - 160	261.75	160	81	25	44	SDAT50 x SAF40	SFC25 - 100	5.68
67.783.32C.160	SDAT50 x SAFC32 - 160	261.75	160	81	32	44	SDAT50 x SAF40	SFC32 - 100	5.54

Features:

- ▶ Flange adapter: SFC.
- ▶ Drive axial and radial set screws for precision adjustment and the runout accuracy of the tool edge can be adjusted within 5 μm.

Pull Stud

Preset Screw



P.W-57



P.W-82

SDAT / SAF RUNOUT ADJUSTABLE HOLDER

Dual
DRIVE+

SDAT / SAF 法蘭加厚型可調式刀桿

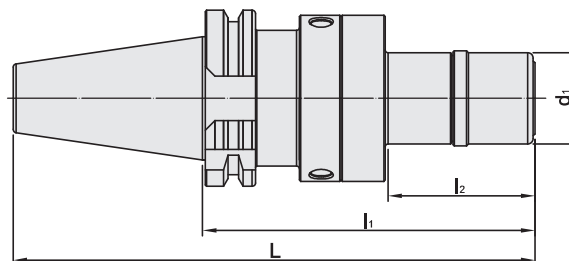

MODEL NO.	TYPE	L	l ₁	l ₂	d ₁	COMBINATION		COLLET	WEIGHT (KGS)
						BODY	FLANGE ADAPTER		
66.783.06K.100	SDAT40 x SAFK6 - 100	168.4	100	29	19.5	SDAT40 x SAF25	SK306 - 50	SKS6	1.63
66.783.06K.150	SDAT40 x SAFK6 - 150	218.4	150	79	19.5	SDAT40 x SAF25	SK306 - 100	SKS6	1.72
66.783.10K.100	SDAT40 x SAFK10 - 100	168.4	100	32.5	27.5	SDAT40 x SAF25	SK310 - 50	SKS10	1.66
66.783.10K.150	SDAT40 x SAFK10 - 150	218.4	150	82.5	27.5	SDAT40 x SAF25	SK310 - 100	SKS10	1.85
66.783.13K.120	SDAT40 x SAFK13 - 120	188.4	120	53	33	SDAT40 x SAF25	SK313 - 70	SKS13	1.79
66.783.13K.150	SDAT40 x SAFK13 - 150	218.4	150	83	33	SDAT40 x SAF25	SK313 - 100	SKS13	1.97
66.783.16K.130	SDAT40 x SAFK16 - 130	198.4	130	49.9	40	SDAT40 x SAF40	SK316 - 70	SKS16	2.83
66.783.16K.160	SDAT40 x SAFK16 - 160	228.4	160	79.9	40	SDAT40 x SAF40	SK316 - 100	SKS16	3.09
67.783.06K.110	SDAT50 x SAFK6 - 110	211.75	110	29	19.5	SDAT50 x SAF25	SK306 - 50	SKS6	3.79
67.783.06K.160	SDAT50 x SAFK6 - 160	261.75	160	79	19.5	SDAT50 x SAF25	SK306 - 100	SKS6	3.88
67.783.10K.110	SDAT50 x SAFK10 - 110	211.75	110	32.5	27.5	SDAT50 x SAF25	SK310 - 50	SKS10	3.82
67.783.10K.160	SDAT50 x SAFK10 - 160	261.75	160	82.5	27.5	SDAT50 x SAF25	SK310 - 100	SKS10	4.01
67.783.13K.130	SDAT50 x SAFK13 - 130	231.75	130	53	33	SDAT50 x SAF25	SK313 - 70	SKS13	3.95
67.783.13K.160	SDAT50 x SAFK13 - 160	261.75	160	83	33	SDAT50 x SAF25	SK313 - 100	SKS13	4.13
67.783.16K.130	SDAT50 x SAFK16 - 130	231.75	130	49.9	40	SDAT50 x SAF40	SK316 - 70	SKS16	5.04
67.783.16K.160	SDAT50 x SAFK16 - 160	261.75	160	79.9	40	SDAT50 x SAF40	SK316 - 100	SKS16	5.30

Features:

- ▶ Flange adapter: SK3.
- ▶ Drive axial and radial set screws for precision adjustment and the runout accuracy of the tool edge can be adjusted within 5 µm.

Standard Accessory: • NUT

Collet	Nut	Pull Stud	Preset Screw	Spanner
P.W-25~28	P.W-46	P.W-57	P.W-82	P.W-62~67



SDAT / SAF RUNOUT ADJUSTABLE HOLDER



SDAT / SAFP 法蘭加厚型可調式刀桿



T W PAT NO. M298033
 T W PAT NO. M311791
 T W PAT NO. M501316
 J P PAT NO. 3128766
 J P PAT NO. 3200356
 K R PAT NO. 20-0433603
 C N PAT NO. ZL200620132661.0
 C H PAT NO. 696550
 T R PAT NO. TR 2007 02942 Y
 I T PAT NO. N.0000266731
 D E PAT NO. Nr.202015005621

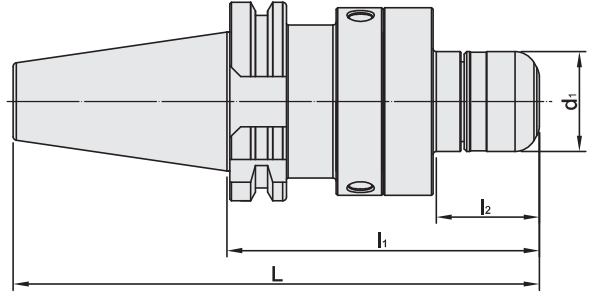

MODEL NO.	TYPE	L	l ₁	l ₂	d ₁	COMBINATION		COLLET	WEIGHT (KGS)
						BODY	FLANGE ADAPTER		
66.783.16P.100	SDAT40 x SAFP16 - 100	168.4	100	32	30	SDAT40 x SAF25	PNER16 - 50	PNER16	1.66
66.783.16P.150	SDAT40 x SAFP16 - 150	218.4	150	82	30	SDAT40 x SAF25	PNER16 - 100	PNER16	1.90
66.783.20P.100	SDAT40 x SAFP20 - 100	168.4	100	33	32	SDAT40 x SAF25	PNER20 - 50	PNER20	1.67
66.783.20P.150	SDAT40 x SAFP20 - 150	218.4	150	83	32	SDAT40 x SAF25	PNER20 - 100	PNER20	1.93
66.783.25P.110	SDAT40 x SAFP25 - 110	178.4	110	28.9	40	SDAT40 x SAF40	PNER25 - 50	PNER25	2.68
66.783.25P.160	SDAT40 x SAFP25 - 160	228.4	160	78.9	40	SDAT40 x SAF40	PNER25 - 100	PNER25	3.10
66.783.32P.120	SDAT40 x SAFP32 - 120	188.4	120	40.9	50	SDAT40 x SAF40	PNER32 - 60	PNER32	2.83
66.783.32P.160	SDAT40 x SAFP32 - 160	228.4	160	80.9	50	SDAT40 x SAF40	PNER32 - 100	PNER32	3.38
67.783.16P.110	SDAT50 x SAFP16 - 110	211.75	110	32	30	SDAT50 x SAF25	PNER16 - 50	PNER16	3.82
67.783.16P.160	SDAT50 x SAFP16 - 160	261.75	160	82	30	SDAT50 x SAF25	PNER16 - 100	PNER16	4.06
67.783.20P.110	SDAT50 x SAFP20 - 110	211.75	110	33	32	SDAT50 x SAF25	PNER20 - 50	PNER20	3.83
67.783.20P.160	SDAT50 x SAFP20 - 160	261.75	160	83	32	SDAT50 x SAF25	PNER20 - 100	PNER20	4.09
67.783.25P.110	SDAT50 x SAFP25 - 110	211.75	110	28.9	40	SDAT50 x SAF40	PNER25 - 50	PNER25	4.89
67.783.25P.160	SDAT50 x SAFP25 - 160	261.75	160	78.9	40	SDAT50 x SAF40	PNER25 - 100	PNER25	5.31
67.783.32P.120	SDAT50 x SAFP32 - 120	221.75	120	40.9	50	SDAT50 x SAF40	PNER32 - 60	PNER32	5.04
67.783.32P.160	SDAT50 x SAFP32 - 160	261.75	160	80.9	50	SDAT50 x SAF40	PNER32 - 100	PNER32	5.59

Features:

- ▶ Flange adapter: PNER.
- ▶ Drive axial and radial set screws for precision adjustment and the runout accuracy of the tool edge can be adjusted within 5 μm.

Standard Accessory: • NUT

Collet	Nut	Pull Stud	Preset Screw	Spanner
P.W-4	P.W-39	P.W-57	P.W-82	P.W-62~67

SDAT / SAF RUNOUT ADJUSTABLE HOLDER



SDAT / SAF 法蘭加厚型可調式刀桿



T W PAT NO. M298033
 T W PAT NO. M311791
 J P PAT NO. 3128766
 J P PAT NO. 3200356
 K R PAT NO. 20-0433603
 C N PAT NO. ZL200620132661.0
 C H PAT NO. 696550
 T R PAT NO. TR 2007 02942 Y
 I T PAT NO. N.0000266731

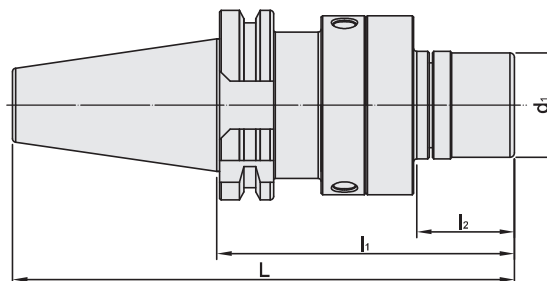

MODEL NO.	TYPE	L	l ₁	l ₂	d ₁	COMBINATION		COLLET	WEIGHT (KGS)
						BODY	FLANGE ADAPTER		
66.783.16U.100	SDAT40 x SAFU16 - 100	168.4	100	32	30	SDAT40 x SAF25	UT16 - 50	ER16	1.71
66.783.20U.100	SDAT40 x SAFU20 - 100	168.4	100	33	35	SDAT40 x SAF25	UT20 - 50	ER20	1.73
66.783.25U.120	SDAT40 x SAFU25 - 120	188.4	120	38.9	42	SDAT40 x SAF40	UT25 - 60	ER25	2.84
66.783.32U.120	SDAT40 x SAFU32 - 120	188.4	120	40.9	48	SDAT40 x SAF40	UT32 - 60	ER32	2.87
67.783.16U.110	SDAT50 x SAFU16 - 110	211.75	110	32	30	SDAT50 x SAF25	UT16 - 50	ER16	3.87
67.783.20U.110	SDAT50 x SAFU20 - 110	211.75	110	33	35	SDAT50 x SAF25	UT20 - 50	ER20	3.89
67.783.25U.120	SDAT50 x SAFU25 - 120	221.75	120	38.9	42	SDAT50 x SAF40	UT25 - 60	ER25	5.05
67.783.32U.120	SDAT50 x SAFU32 - 120	221.75	120	40.9	48	SDAT50 x SAF40	UT32 - 60	ER32	5.08

Features:

- ▶ Flange adapter: UT.
- ▶ Drive axial and radial set screws for precision adjustment and the runout accuracy of the tool edge can be adjusted within 5 μm.

Standard Accessory: • NUT

Collet	Nut	Pull Stud	Preset Screw	Spanner
P.W-6~9	P.W-41	P.W-57	P.W-82	P.W-62~67



HSK / SAF RUNOUT ADJUSTABLE HOLDER

4.5°

HSK / SAF 可調式刀桿

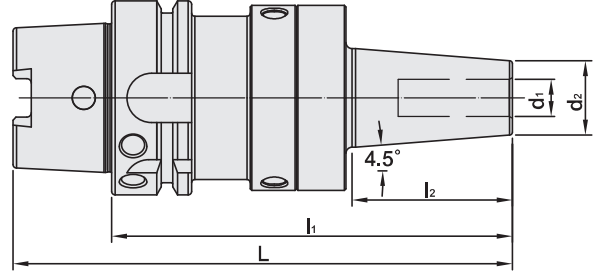

MODEL NO.	TYPE	L	l ₁	l ₂	d ₁	d ₂	COMBINATION		WEIGHT (KGS)
							BODY	FLANGE ADAPTER	
39512	HSK40A x SAF C6 - 130	150	130	52	6	21	HSK40A x SAF25	SFC6 - 70	1.22
39514	HSK40A x SAF C8 - 130	150	130	52	8	21	HSK40A x SAF25	SFC8 - 70	1.21
39516	HSK40A x SAF C10 - 130	150	130	52	10	24	HSK40A x SAF25	SFC10 - 70	1.26
39518	HSK40A x SAF C12 - 130	150	130	52	12	24	HSK40A x SAF25	SFC12 - 70	1.24
39520	HSK40A x SAF C16 - 135	155	135	57	16	27	HSK40A x SAF25	SFC16 - 75	1.29
39522	HSK50A x SAF C6 - 130	155	130	52	6	21	HSK50A x SAF25	SFC6 - 70	1.34
39524	HSK50A x SAF C8 - 130	155	130	52	8	21	HSK50A x SAF25	SFC8 - 70	1.33
39526	HSK50A x SAF C10 - 130	155	130	52	10	24	HSK50A x SAF25	SFC10 - 70	1.38
39528	HSK50A x SAF C12 - 130	155	130	52	12	24	HSK50A x SAF25	SFC12 - 70	1.36
39530	HSK50A x SAF C16 - 135	160	135	57	16	27	HSK50A x SAF25	SFC16 - 75	1.41
39532	HSK63A x SAF C6 - 130	162	130	52	6	21	HSK63A x SAF25	SFC6 - 70	1.68
39534	HSK63A x SAF C8 - 130	162	130	52	8	21	HSK63A x SAF25	SFC8 - 70	1.67
39536	HSK63A x SAF C10 - 130	162	130	52	10	24	HSK63A x SAF25	SFC10 - 70	1.72
39538	HSK63A x SAF C12 - 130	162	130	52	12	24	HSK63A x SAF25	SFC12 - 70	1.70
39540	HSK63A x SAF C16 - 135	167	135	57	16	27	HSK63A x SAF25	SFC16 - 75	1.75
39542	HSK63A x SAF C20 - 140	172	140	60	20	33	HSK63A x SAF40	SFC20 - 80	2.55
39544	HSK63A x SAF C25 - 160	192	160	81	25	44	HSK63A x SAF40	SFC25 - 100	3.08
39546	HSK63A x SAF C32 - 160	192	160	81	32	44	HSK63A x SAF40	SFC32 - 100	2.94
39548	HSK80A x SAF C6 - 120	160	120	52	6	21	HSK80A x SAF25	SFC6 - 70	1.99
39550	HSK80A x SAF C8 - 120	160	120	52	8	21	HSK80A x SAF25	SFC8 - 70	1.98
39552	HSK80A x SAF C10 - 120	160	120	52	10	24	HSK80A x SAF25	SFC10 - 70	2.03
39554	HSK80A x SAF C12 - 120	160	120	52	12	24	HSK80A x SAF25	SFC12 - 70	2.01
39556	HSK80A x SAF C16 - 125	165	125	57	16	27	HSK80A x SAF25	SFC16 - 75	2.06
39558	HSK80A x SAF C20 - 140	180	140	60	20	33	HSK80A x SAF40	SFC20 - 80	3.14
39560	HSK80A x SAF C25 - 160	200	160	81	25	44	HSK80A x SAF40	SFC25 - 100	3.67
39562	HSK80A x SAF C32 - 160	200	160	81	32	44	HSK80A x SAF40	SFC32 - 100	3.53
39564	HSK100A x SAF C6 - 125	175	125	52	6	21	HSK100A x SAF25	SFC6 - 70	2.93
39566	HSK100A x SAF C8 - 125	175	125	52	8	21	HSK100A x SAF25	SFC8 - 70	2.92
39568	HSK100A x SAF C10 - 125	175	125	52	10	24	HSK100A x SAF25	SFC10 - 70	2.97
39570	HSK100A x SAF C12 - 125	175	125	52	12	24	HSK100A x SAF25	SFC12 - 70	2.95
39572	HSK100A x SAF C16 - 130	180	130	57	16	27	HSK100A x SAF25	SFC16 - 75	3.00
39574	HSK100A x SAF C20 - 135	185	135	60	20	33	HSK100A x SAF40	SFC20 - 80	3.92
39576	HSK100A x SAF C25 - 155	205	155	81	25	44	HSK100A x SAF40	SFC25 - 100	4.45
39578	HSK100A x SAF C32 - 155	205	155	81	32	44	HSK100A x SAF40	SFC32 - 100	4.31

Features:

- ▶ Flange adapter: SFC.
- ▶ Drive axial and radial set screws for precision adjustment and the runout accuracy of the tool edge can be adjusted within 5 μm.

Preset Screw



P.W-82

HSK / SAF RUNOUT ADJUSTABLE HOLDER

HSK / SAF 可調式刀桿

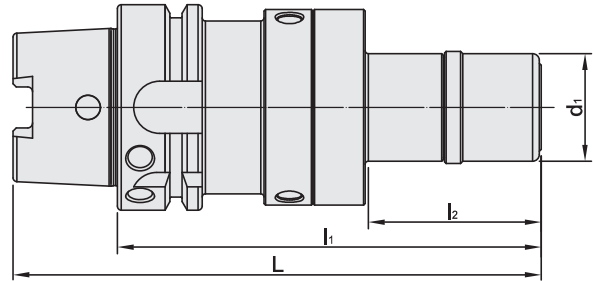

MODEL NO.	TYPE	L	l ₁	l ₂	d ₁	COMBINATION		COLLET	WEIGHT (KGS)
						BODY	FLANGE ADAPTER		
39352	HSK40A x SAFK6 - 110	130	110	29	19.5	HSK40A x SAF25	SK306 - 50	SKS6	1.09
39354	HSK40A x SAFK6 - 160	180	160	79	19.5	HSK40A x SAF25	SK306 - 100	SKS6	1.18
39356	HSK40A x SAFK10 - 110	130	110	32.5	27.5	HSK40A x SAF25	SK310 - 50	SKS10	1.12
39358	HSK40A x SAFK10 - 160	180	160	82.5	27.5	HSK40A x SAF25	SK310 - 100	SKS10	1.31
39360	HSK40A x SAFK13 - 130	150	130	53	33	HSK40A x SAF25	SK313 - 70	SKS13	1.25
39362	HSK40A x SAFK13 - 160	180	160	83	33	HSK40A x SAF25	SK313 - 100	SKS13	1.43
39364	HSK50A x SAFK6 - 110	135	110	29	19.5	HSK50A x SAF25	SK306 - 50	SKS6	1.21
39366	HSK50A x SAFK6 - 160	185	160	79	19.5	HSK50A x SAF25	SK306 - 100	SKS6	1.30
39368	HSK50A x SAFK10 - 110	135	110	32.5	27.5	HSK50A x SAF25	SK310 - 50	SKS10	1.24
39370	HSK50A x SAFK10 - 160	185	160	82.5	27.5	HSK50A x SAF25	SK310 - 100	SKS10	1.43
39372	HSK50A x SAFK13 - 130	155	130	53	33	HSK50A x SAF25	SK313 - 70	SKS13	1.37
39374	HSK50A x SAFK13 - 160	185	160	83	33	HSK50A x SAF25	SK313 - 100	SKS13	1.55
39376	HSK63A x SAFK6 - 110	142	110	29	19.5	HSK63A x SAF25	SK306 - 50	SKS6	1.55
39378	HSK63A x SAFK6 - 160	192	160	79	19.5	HSK63A x SAF25	SK306 - 100	SKS6	1.64
39380	HSK63A x SAFK10 - 110	142	110	32.5	27.5	HSK63A x SAF25	SK310 - 50	SKS10	1.58
39382	HSK63A x SAFK10 - 160	192	160	82.5	27.5	HSK63A x SAF25	SK310 - 100	SKS10	1.77
39384	HSK63A x SAFK13 - 130	162	130	53	33	HSK63A x SAF25	SK313 - 70	SKS13	1.71
39386	HSK63A x SAFK13 - 160	192	160	83	33	HSK63A x SAF25	SK313 - 100	SKS13	1.89
39388	HSK63A x SAFK16 - 130	162	130	49.9	40	HSK63A x SAF40	SK316 - 70	SKS16	2.44
39390	HSK63A x SAFK16 - 160	192	160	79.9	40	HSK63A x SAF40	SK316 - 100	SKS16	2.70

Features:

- ▶ Flange adapter: SK3.
- ▶ Drive axial and radial set screws for precision adjustment and the runout accuracy of the tool edge can be adjusted within 5 μm.

Standard Accessory: • NUT

Collet	Nut	Preset Screw	Spanner
P.W-25~28	P.W-46	P.W-82	P.W-62~67



HSK / SAF RUNOUT ADJUSTABLE HOLDER

HSK / SAF 可調式刀桿

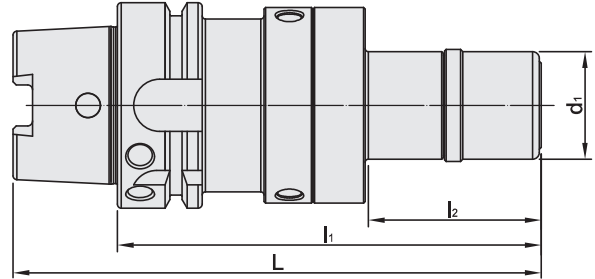





MODEL NO.	TYPE	L	l ₁	l ₂	d ₁	COMBINATION		COLLET	WEIGHT (KGS)
						BODY	FLANGE ADAPTER		
39392	HSK80A x SAFK6 - 100	140	100	29	19.5	HSK80A x SAF25	SK306 - 50	SKS6	1.86
39394	HSK80A x SAFK6 - 150	190	150	79	19.5	HSK80A x SAF25	SK306 - 100	SKS6	1.95
39396	HSK80A x SAFK10 - 100	140	100	32.5	27.5	HSK80A x SAF25	SK310 - 50	SKS10	1.89
39398	HSK80A x SAFK10 - 150	190	150	82.5	27.5	HSK80A x SAF25	SK310 - 100	SKS10	2.08
39400	HSK80A x SAFK13 - 120	160	120	53	33	HSK80A x SAF25	SK313 - 70	SKS13	2.02
39402	HSK80A x SAFK13 - 150	190	150	83	33	HSK80A x SAF25	SK313 - 100	SKS13	2.20
39404	HSK80A x SAFK16 - 130	170	130	49.9	40	HSK80A x SAF40	SK316 - 70	SKS16	3.03
39406	HSK80A x SAFK16 - 160	200	160	79.9	40	HSK80A x SAF40	SK316 - 100	SKS16	3.29
39408	HSK100A x SAFK6 - 105	155	105	29	19.5	HSK100A x SAF25	SK306 - 50	SKS6	2.80
39410	HSK100A x SAFK6 - 155	205	155	79	19.5	HSK100A x SAF25	SK306 - 100	SKS6	2.89
39412	HSK100A x SAFK10 - 105	155	105	32.5	27.5	HSK100A x SAF25	SK310 - 50	SKS10	2.83
39414	HSK100A x SAFK10 - 155	205	155	82.5	27.5	HSK100A x SAF25	SK310 - 100	SKS10	3.02
39416	HSK100A x SAFK13 - 125	175	125	53	33	HSK100A x SAF25	SK313 - 70	SKS13	2.96
39418	HSK100A x SAFK13 - 155	205	155	83	33	HSK100A x SAF25	SK313 - 100	SKS13	3.14
39420	HSK100A x SAFK16 - 125	175	125	49.9	40	HSK100A x SAF40	SK316 - 70	SKS16	3.81
39422	HSK100A x SAFK16 - 155	205	155	79.9	40	HSK100A x SAF40	SK316 - 100	SKS16	4.07

Features:

- ▶ Flange adapter: SK3.
- ▶ Drive axial and radial set screws for precision adjustment and the runout accuracy of the tool edge can be adjusted within 5 μm.

Standard Accessory: • NUT

Collet	Nut	Preset Screw	Spanner
			
P.W-25~28	P.W-46	P.W-82	P.W-62~67

HSK / SAF RUNOUT ADJUSTABLE HOLDER



HSK / SAF 可調式刀桿



T W PAT NO. M298033
 T W PAT NO. M311791
 T W PAT NO. M501316
 J P PAT NO. 3128766
 J P PAT NO. 3200356
 K R PAT NO. 20-0433603
 C N PAT NO. ZL200620132661.0
 C H PAT NO. 696550
 T R PAT NO. TR 2007 02942 Y
 I T PAT NO. N.0000266731
 D E PAT NO. Nr.202015005621

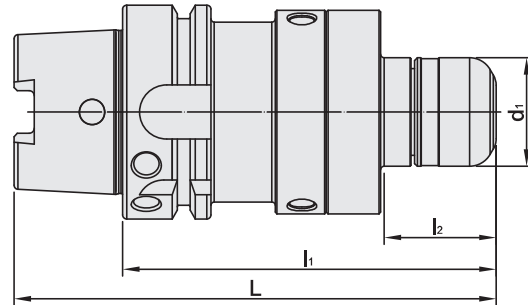

MODEL NO.	TYPE	L	l ₁	l ₂	d ₁	COMBINATION		COLLET	WEIGHT (KGS)
						BODY	FLANGE ADAPTER		
39432	HSK40A x SAFP16 - 110	130	110	32	30	HSK63A x SAF25	PNER16 - 50	PNER16	1.12
39432 - 160	HSK40A x SAFP16 - 160	180	160	82	30	HSK63A x SAF25	PNER16 - 100	PNER16	1.36
39434	HSK40A x SAFP20 - 110	130	110	33	32	HSK63A x SAF25	PNER20 - 50	PNER20	1.13
39434 - 160	HSK40A x SAFP20 - 160	180	160	83	32	HSK63A x SAF25	PNER20 - 100	PNER20	1.39
39436	HSK50A x SAFP16 - 110	135	110	32	30	HSK63A x SAF25	PNER25 - 50	PNER25	1.24
39436 - 160	HSK50A x SAFP16 - 160	185	160	82	30	HSK63A x SAF25	PNER25 - 100	PNER25	1.48
39438	HSK50A x SAFP20 - 110	135	110	33	32	HSK63A x SAF25	PNER32 - 60	PNER32	1.25
39438 - 160	HSK50A x SAFP20 - 160	185	160	83	32	HSK63A x SAF25	PNER32 - 100	PNER32	1.51
39440	HSK63A x SAFP16 - 110	142	110	32	30	HSK63A x SAF25	PNER16 - 50	PNER16	1.58
39440 - 160	HSK63A x SAFP16 - 160	192	160	82	30	HSK63A x SAF25	PNER16 - 100	PNER16	1.82
39442	HSK63A x SAFP20 - 110	142	110	33	32	HSK63A x SAF25	PNER20 - 50	PNER20	1.59
39442 - 160	HSK63A x SAFP20 - 160	192	160	83	32	HSK63A x SAF25	PNER20 - 100	PNER20	1.85
39444	HSK63A x SAFP25 - 110	142	110	28.9	40	HSK63A x SAF40	PNER25 - 50	PNER25	2.29
39444 - 160	HSK63A x SAFP25 - 160	192	160	78.9	40	HSK63A x SAF40	PNER25 - 100	PNER25	2.71
39446	HSK63A x SAFP32 - 120	152	120	40.9	50	HSK63A x SAF40	PNER32 - 60	PNER32	2.44
39446 - 160	HSK63A x SAFP32 - 160	192	160	80.9	50	HSK63A x SAF40	PNER32 - 100	PNER32	2.99
39448	HSK80A x SAFP16 - 100	140	100	32	30	HSK80A x SAF25	PNER16 - 50	PNER16	1.89
39448 - 150	HSK80A x SAFP16 - 150	190	150	82	30	HSK80A x SAF25	PNER16 - 100	PNER16	2.13
39450	HSK80A x SAFP20 - 100	140	100	33	32	HSK80A x SAF25	PNER20 - 50	PNER20	1.90
39450 - 150	HSK80A x SAFP20 - 150	190	150	83	32	HSK80A x SAF25	PNER20 - 100	PNER20	2.16
39452	HSK80A x SAFP25 - 110	150	110	28.9	40	HSK80A x SAF40	PNER25 - 50	PNER25	2.88
39452 - 160	HSK80A x SAFP25 - 160	200	160	78.9	40	HSK80A x SAF40	PNER25 - 100	PNER25	3.30
39454	HSK80A x SAFP32 - 120	160	120	40.9	50	HSK80A x SAF40	PNER32 - 60	PNER32	3.03
39454 - 160	HSK80A x SAFP32 - 160	200	160	80.9	50	HSK80A x SAF40	PNER32 - 100	PNER32	3.58
39456	HSK100A x SAFP16 - 105	155	105	32	30	HSK100A x SAF25	PNER16 - 50	PNER16	2.83
39456 - 155	HSK100A x SAFP16 - 155	205	155	82	30	HSK100A x SAF25	PNER16 - 100	PNER16	3.07
39458	HSK100A x SAFP20 - 105	155	105	33	32	HSK100A x SAF25	PNER20 - 50	PNER20	2.84
39458 - 155	HSK100A x SAFP20 - 155	205	155	83	32	HSK100A x SAF25	PNER20 - 100	PNER20	3.10
39460	HSK100A x SAFP25 - 105	155	105	28.9	40	HSK100A x SAF40	PNER25 - 50	PNER25	3.66
39460 - 155	HSK100A x SAFP25 - 155	205	155	78.9	40	HSK100A x SAF40	PNER25 - 100	PNER25	4.08
39462	HSK100A x SAFP32 - 115	165	115	40.9	50	HSK100A x SAF40	PNER32 - 60	PNER32	3.81
39462 - 155	HSK100A x SAFP32 - 155	205	155	80.9	50	HSK100A x SAF40	PNER32 - 100	PNER32	4.36

Features:

- ▶ Flange adapter: PNER.
- ▶ Drive axial and radial set screws for precision adjustment and the runout accuracy of the tool edge can be adjusted within 5 μm.

Standard Accessory: • NUT

Collet	Nut	Preset Screw	Spanner
P.W-4	P.W-39	P.W-82	P.W-62~67



HSK / SAF RUNOUT ADJUSTABLE HOLDER



HSK / SAF 可調式刀桿



T W PAT NO. M298033
 T W PAT NO. M311791
 J P PAT NO. 3128766
 J P PAT NO. 3200356
 K R PAT NO. 20-0433603
 C N PAT NO. ZL200620132661.0
 C H PAT NO. 696550
 T R PAT NO. TR 2007 02942 Y
 I T PAT NO. N.0000266731

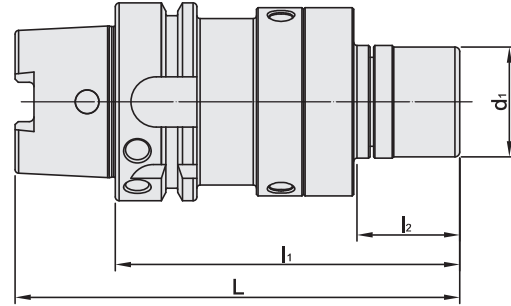

MODEL NO.	TYPE	L	l ₁	l ₂	d ₁	COMBINATION		COLLET	WEIGHT (KGS)
						BODY	FLANGE ADAPTER		
39472	HSK40A x SAFU16 - 110	130	110	32	30	HSK40A x SAF25	UT16 - 50	ER16	1.17
39474	HSK40A x SAFU20 - 110	130	110	33	35	HSK40A x SAF25	UT20 - 50	ER20	1.19
39476	HSK50A x SAFU16 - 110	135	110	32	30	HSK50A x SAF25	UT16 - 50	ER16	1.29
39478	HSK50A x SAFU20 - 110	135	110	33	35	HSK50A x SAF25	UT20 - 50	ER20	1.31
39480	HSK63A x SAFU16 - 110	142	110	32	30	HSK63A x SAF25	UT16 - 50	ER16	1.63
39482	HSK63A x SAFU20 - 110	142	110	33	35	HSK63A x SAF25	UT20 - 50	ER20	1.65
39484	HSK63A x SAFU25 - 120	152	120	38.9	42	HSK63A x SAF40	UT25 - 60	ER25	2.45
39486	HSK63A x SAFU32 - 120	152	120	40.9	48	HSK63A x SAF40	UT32 - 60	ER32	2.48
39488	HSK80A x SAFU16 - 100	140	100	32	30	HSK80A x SAF25	UT16 - 50	ER16	1.94
39490	HSK80A x SAFU20 - 100	140	100	33	35	HSK80A x SAF25	UT20 - 50	ER20	1.96
39492	HSK80A x SAFU25 - 120	160	120	38.9	42	HSK80A x SAF25	UT25 - 60	ER25	3.04
39494	HSK80A x SAFU32 - 120	160	120	40.9	48	HSK80A x SAF25	UT32 - 60	ER32	3.07
39496	HSK100A x SAFU16 - 105	155	105	32	30	HSK100A x SAF25	UT16 - 50	ER16	2.88
39498	HSK100A x SAFU20 - 105	155	105	33	35	HSK100A x SAF25	UT20 - 50	ER20	2.90
39500	HSK100A x SAFU25 - 115	165	115	38.9	42	HSK100A x SAF40	UT25 - 60	ER25	3.82
39502	HSK100A x SAFU32 - 115	165	115	40.9	48	HSK100A x SAF40	UT32 - 60	ER32	3.85

Features:

- ▶ Flange adapter: UT.
- ▶ Drive axial and radial set screws for precision adjustment and the runout accuracy of the tool edge can be adjusted within 5 μm.

Standard Accessory: • NUT

Collet	Nut	Preset Screw	Spanner
P.W-6~9	P.W-41	P.W-82	P.W-62~67

PSC / SAF RUNOUT ADJUSTABLE HOLDER

4.5°

PSC / SAF 可調式刀桿

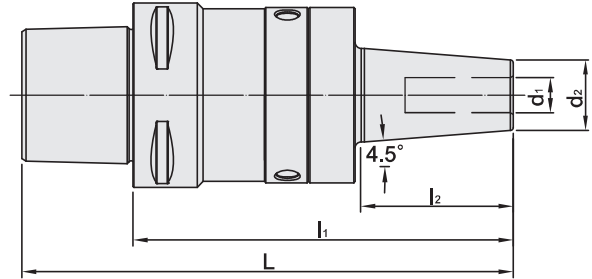

MODEL NO.	TYPE	L	l ₁	l ₂	d ₁	d ₂	COMBINATION		WEIGHT (KGS)
							BODY	FLANGE ADAPTER	
141.783.06C.125	PSC40 x SAFC6 - 125	149	125	52	6	21	PSC40 x SAF25	SFC6 - 70	1.28
141.783.08C.125	PSC40 x SAFC8 - 125	149	125	52	8	21	PSC40 x SAF25	SFC8 - 70	1.27
141.783.10C.125	PSC40 x SAFC10 - 125	149	125	52	10	24	PSC40 x SAF25	SFC10 - 70	1.32
141.783.12C.125	PSC40 x SAFC12 - 125	149	125	52	12	24	PSC40 x SAF25	SFC12 - 70	1.30
141.783.16C.130	PSC40 x SAFC16 - 130	154	130	57	16	27	PSC40 x SAF25	SFC16 - 75	1.35
142.783.06C.130	PSC50 x SAFC6 - 130	160	130	52	6	21	PSC50 x SAF25	SFC6 - 70	1.62
142.783.08C.130	PSC50 x SAFC8 - 130	160	130	52	8	21	PSC50 x SAF25	SFC8 - 70	1.61
142.783.10C.130	PSC50 x SAFC10 - 130	160	130	52	10	24	PSC50 x SAF25	SFC10 - 70	1.66
142.783.12C.130	PSC50 x SAFC12 - 130	160	130	52	12	24	PSC50 x SAF25	SFC12 - 70	1.64
142.783.16C.135	PSC50 x SAFC16 - 135	165	135	57	16	27	PSC50 x SAF25	SFC16 - 75	1.69
143.783.06C.130	PSC63 x SAFC6 - 130	168	130	52	6	21	PSC63 x SAF25	SFC6 - 70	1.97
143.783.08C.130	PSC63 x SAFC8 - 130	168	130	52	8	21	PSC63 x SAF25	SFC8 - 70	1.96
143.783.10C.130	PSC63 x SAFC10 - 130	168	130	52	10	24	PSC63 x SAF25	SFC10 - 70	2.01
143.783.12C.130	PSC63 x SAFC12 - 130	168	130	52	12	24	PSC63 x SAF25	SFC12 - 70	1.99
143.783.16C.135	PSC63 x SAFC16 - 135	173	135	57	16	27	PSC63 x SAF25	SFC16 - 75	2.04
143.783.20C.140	PSC63 x SAFC20 - 140	178	140	60	20	33	PSC63 x SAF40	SFC20 - 80	3.01
143.783.25C.160	PSC63 x SAFC25 - 160	198	160	81	25	44	PSC63 x SAF40	SFC25 - 100	3.54
143.783.32C.160	PSC63 x SAFC32 - 160	198	160	81	32	44	PSC63 x SAF40	SFC32 - 100	3.40
144.783.06C.120	PSC80 x SAFC6 - 120	168	120	52	6	21	PSC80 x SAF25	SFC6 - 70	2.55
144.783.08C.120	PSC80 x SAFC8 - 120	168	120	52	8	21	PSC80 x SAF25	SFC8 - 70	2.54
144.783.10C.120	PSC80 x SAFC10 - 120	168	120	52	10	24	PSC80 x SAF25	SFC10 - 70	2.59
144.783.12C.120	PSC80 x SAFC12 - 120	168	120	52	12	24	PSC80 x SAF25	SFC12 - 70	2.57
144.783.16C.125	PSC80 x SAFC16 - 125	173	125	57	16	27	PSC80 x SAF25	SFC16 - 75	2.62
144.783.20C.140	PSC80 x SAFC20 - 140	188	140	60	20	33	PSC80 x SAF40	SFC20 - 80	3.81
144.783.25C.160	PSC80 x SAFC25 - 160	208	160	81	25	44	PSC80 x SAF40	SFC25 - 100	4.34
144.783.32C.160	PSC80 x SAFC32 - 160	208	160	81	32	44	PSC80 x SAF40	SFC32 - 100	4.20

Features:

- ▶ Flange adapter: SFC.
- ▶ Drive axial and radial set screws for precision adjustment and the runout accuracy of the tool edge can be adjusted within 5 μm.

Preset Screw



P.W-82



PSC / SAF RUNOUT ADJUSTABLE HOLDER

PSC / SAF 可調式刀桿

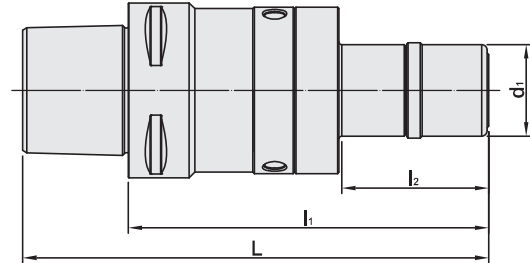

MODEL NO.	TYPE	L	l ₁	l ₂	d ₁	COMBINATION		COLLET	WEIGHT (KGS)
						BODY	FLANGE ADAPTER		
141.783.06K.105	PSC40 x SAFK6 - 105	129	105	29	19.5	PSC40 x SAF25	SK306 - 50	SKS6	1.15
141.783.06K.155	PSC40 x SAFK6 - 155	179	155	79	19.5	PSC40 x SAF25	SK306 - 100	SKS6	1.24
141.783.10K.105	PSC40 x SAFK10 - 105	129	105	32.5	27.5	PSC40 x SAF25	SK310 - 50	SKS10	1.18
141.783.10K.155	PSC40 x SAFK10 - 155	179	155	82.5	27.5	PSC40 x SAF25	SK310 - 100	SKS10	1.37
141.783.13K.125	PSC40 x SAFK13 - 125	149	125	53	33	PSC40 x SAF25	SK313 - 70	SKS13	1.31
141.783.13K.155	PSC40 x SAFK13 - 155	179	155	83	33	PSC40 x SAF25	SK313 - 100	SKS13	1.49
142.783.06K.110	PSC50 x SAFK6 - 110	140	110	29	19.5	PSC50 x SAF25	SK306 - 50	SKS6	1.49
142.783.06K.160	PSC50 x SAFK6 - 160	190	160	79	19.5	PSC50 x SAF25	SK306 - 100	SKS6	1.58
142.783.10K.110	PSC50 x SAFK10 - 110	140	110	32.5	27.5	PSC50 x SAF25	SK310 - 50	SKS10	1.52
142.783.10K.160	PSC50 x SAFK10 - 160	190	160	82.5	27.5	PSC50 x SAF25	SK310 - 100	SKS10	1.71
142.783.13K.130	PSC50 x SAFK13 - 130	160	130	53	33	PSC50 x SAF25	SK313 - 70	SKS13	1.65
142.783.13K.160	PSC50 x SAFK13 - 160	190	160	83	33	PSC50 x SAF25	SK313 - 100	SKS13	1.83
143.783.06K.110	PSC63 x SAFK6 - 110	148	110	29	19.5	PSC63 x SAF25	SK306 - 50	SKS6	1.84
143.783.06K.160	PSC63 x SAFK6 - 160	198	160	79	19.5	PSC63 x SAF25	SK306 - 100	SKS6	1.93
143.783.10K.110	PSC63 x SAFK10 - 110	148	110	32.5	27.5	PSC63 x SAF25	SK310 - 50	SKS10	1.87
143.783.10K.160	PSC63 x SAFK10 - 160	198	160	82.5	27.5	PSC63 x SAF25	SK310 - 100	SKS10	2.06
143.783.13K.130	PSC63 x SAFK13 - 130	168	130	53	33	PSC63 x SAF25	SK313 - 70	SKS13	2.00
143.783.13K.160	PSC63 x SAFK13 - 160	198	160	83	33	PSC63 x SAF25	SK313 - 100	SKS13	2.18
143.783.16K.130	PSC63 x SAFK16 - 130	168	130	49.9	40	PSC63 x SAF40	SK316 - 70	SKS16	2.90
143.783.16K.160	PSC63 x SAFK16 - 160	198	160	79.9	40	PSC63 x SAF40	SK316 - 100	SKS16	3.16
144.783.06K.100	PSC80 x SAFK6 - 100	148	100	29	19.5	PSC80 x SAF25	SK306 - 50	SKS6	2.42
144.783.06K.150	PSC80 x SAFK6 - 150	198	150	79	19.5	PSC80 x SAF25	SK306 - 100	SKS6	2.51
144.783.10K.100	PSC80 x SAFK10 - 100	148	100	32.5	27.5	PSC80 x SAF25	SK310 - 50	SKS10	2.45
144.783.10K.150	PSC80 x SAFK10 - 150	198	150	82.5	27.5	PSC80 x SAF25	SK310 - 100	SKS10	2.64
144.783.13K.120	PSC80 x SAFK13 - 120	168	120	53	33	PSC80 x SAF25	SK313 - 70	SKS13	2.58
144.783.13K.150	PSC80 x SAFK13 - 150	198	150	83	33	PSC80 x SAF25	SK313 - 100	SKS13	2.76
144.783.16K.130	PSC80 x SAFK16 - 130	178	130	49.9	40	PSC80 x SAF40	SK316 - 70	SKS16	3.70
144.783.16K.160	PSC80 x SAFK16 - 160	208	160	79.9	40	PSC80 x SAF40	SK316 - 100	SKS16	3.96

Features:

- ▶ Flange adapter: SK3.
- ▶ Drive axial and radial set screws for precision adjustment and the runout accuracy of the tool edge can be adjusted within 5 μm.

Standard Accessory: • NUT

Collet	Nut	Preset Screw	Spanner
P.W-25~28	P.W-46	P.W-82	P.W-62~67

PSC / SAF RUNOUT ADJUSTABLE HOLDER



PSC / SAF 可調式刀桿



T W PAT NO. M298033
 T W PAT NO. M311791
 T W PAT NO. M501316
 J P PAT NO. 3128766
 J P PAT NO. 3200356
 K R PAT NO. 20-0433603
 C N PAT NO. ZL200620132661.0
 C H PAT NO. 696550
 T R PAT NO. TR 2007 02942 Y
 I T PAT NO. N.0000266731
 D E PAT NO. Nr.202015005621

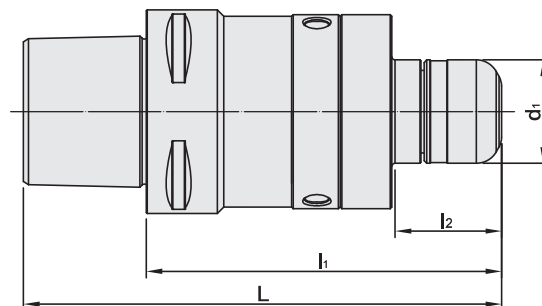

MODEL NO.	TYPE	L	l ₁	l ₂	d ₁	COMBINATION		COLLET	WEIGHT (KGS)
						BODY	FLANGE ADAPTER		
141.783.16P.105	PSC40 x SAFP16 - 105	129	105	32	30	PSC40 x SAF25	PNER16 - 50	PNER16	1.18
141.783.16P.155	PSC40 x SAFP16 - 155	179	155	82	30	PSC40 x SAF25	PNER16 - 100	PNER16	1.42
141.783.20P.105	PSC40 x SAFP20 - 105	129	105	33	32	PSC40 x SAF25	PNER20 - 50	PNER20	1.19
141.783.20P.155	PSC40 x SAFP20 - 155	179	155	83	32	PSC40 x SAF25	PNER20 - 100	PNER20	1.45
142.783.16P.110	PSC50 x SAFP16 - 110	140	110	32	30	PSC50 x SAF25	PNER16 - 50	PNER16	1.52
142.783.16P.160	PSC50 x SAFP16 - 160	190	160	82	30	PSC50 x SAF25	PNER16 - 100	PNER16	1.76
142.783.20P.110	PSC50 x SAFP20 - 110	140	110	33	32	PSC50 x SAF25	PNER20 - 50	PNER20	1.53
142.783.20P.160	PSC50 x SAFP20 - 160	190	160	83	32	PSC50 x SAF25	PNER20 - 100	PNER20	1.79
143.783.16P.110	PSC63 x SAFP16 - 110	148	110	32	30	PSC63 x SAF25	PNER16 - 50	PNER16	1.87
143.783.16P.160	PSC63 x SAFP16 - 160	198	160	82	30	PSC63 x SAF25	PNER16 - 100	PNER16	2.11
143.783.20P.110	PSC63 x SAFP20 - 110	148	110	33	32	PSC63 x SAF25	PNER20 - 50	PNER20	1.88
143.783.20P.160	PSC63 x SAFP20 - 160	198	160	83	32	PSC63 x SAF25	PNER20 - 100	PNER20	2.14
143.783.25P.110	PSC63 x SAFP25 - 110	148	110	28.9	40	PSC63 x SAF40	PNER25 - 50	PNER25	2.75
143.783.25P.160	PSC63 x SAFP25 - 160	198	160	78.9	40	PSC63 x SAF40	PNER25 - 100	PNER25	3.17
143.783.32P.120	PSC63 x SAFP32 - 120	158	120	40.9	50	PSC63 x SAF40	PNER32 - 60	PNER32	2.90
143.783.32P.160	PSC63 x SAFP32 - 160	198	160	80.9	50	PSC63 x SAF40	PNER32 - 100	PNER32	3.45
144.783.16P.100	PSC80 x SAFP16 - 100	148	100	32	30	PSC80 x SAF25	PNER16 - 50	PNER16	2.45
144.783.16P.150	PSC80 x SAFP16 - 150	198	150	82	30	PSC80 x SAF25	PNER16 - 100	PNER16	2.69
144.783.20P.100	PSC80 x SAFP20 - 100	148	100	33	32	PSC80 x SAF25	PNER20 - 50	PNER20	2.46
144.783.20P.150	PSC80 x SAFP20 - 150	198	150	83	32	PSC80 x SAF25	PNER20 - 100	PNER20	2.72
144.783.25P.110	PSC80 x SAFP25 - 110	158	110	28.9	40	PSC80 x SAF40	PNER25 - 50	PNER25	3.55
144.783.25P.160	PSC80 x SAFP25 - 160	208	160	78.9	40	PSC80 x SAF40	PNER25 - 100	PNER25	3.97
144.783.32P.120	PSC80 x SAFP32 - 120	168	120	40.9	50	PSC80 x SAF40	PNER32 - 60	PNER32	3.70
144.783.32P.160	PSC80 x SAFP32 - 160	208	160	80.9	50	PSC80 x SAF40	PNER32 - 100	PNER32	4.25

Features:

- ▶ Flange adapter: PNER.
- ▶ Drive axial and radial set screws for precision adjustment and the runout accuracy of the tool edge can be adjusted within 5 μm.

Standard Accessory: • NUT

Collet	Nut	Preset Screw	Spanner
P.W-4	P.W-39	P.W-82	P.W-62~67



PSC / SAF RUNOUT ADJUSTABLE HOLDER



PSC / SAF 可調式刀桿



T W PAT NO. M298033
 T W PAT NO. M311791
 J P PAT NO. 3128766
 J P PAT NO. 3200356
 K R PAT NO. 20-0433603
 C N PAT NO. ZL200620132661.0
 C H PAT NO. 696550
 T R PAT NO. TR.2007.02942 Y
 I T PAT NO. N.0000266731

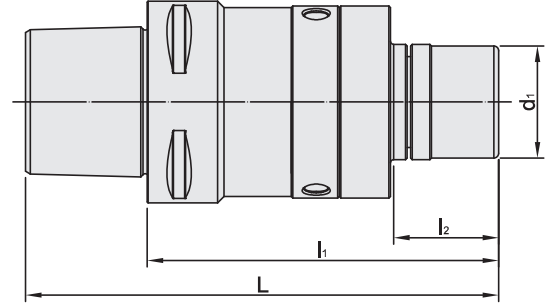

MODEL NO.	TYPE	L	l ₁	l ₂	d ₁	COMBINATION		COLLET	WEIGHT (KGS)
						BODY	FLANGE ADAPTER		
141.783.16U.105	PSC40 x SAFU16 - 105	129	105	32	30	PSC40 x SAF25	UT16 - 50	ER16	1.23
141.783.20U.105	PSC40 x SAFU20 - 105	129	105	33	35	PSC40 x SAF25	UT20 - 50	ER20	1.25
142.783.16U.110	PSC50 x SAFU16 - 110	140	110	32	30	PSC50 x SAF25	UT16 - 50	ER16	1.57
142.783.20U.110	PSC50 x SAFU20 - 110	140	110	33	35	PSC50 x SAF25	UT20 - 50	ER20	1.59
143.783.16U.110	PSC63 x SAFU16 - 110	148	110	32	30	PSC63 x SAF25	UT16 - 50	ER16	1.92
143.783.20U.110	PSC63 x SAFU20 - 110	148	110	33	35	PSC63 x SAF25	UT20 - 50	ER20	1.94
143.783.25U.120	PSC63 x SAFU25 - 120	158	120	38.9	42	PSC63 x SAF40	UT25 - 60	ER25	2.91
143.783.32U.120	PSC63 x SAFU32 - 120	158	120	40.9	48	PSC63 x SAF40	UT32 - 60	ER32	2.94
144.783.16U.100	PSC80 x SAFU16 - 100	148	100	32	30	PSC80 x SAF25	UT16 - 50	ER16	2.50
144.783.20U.100	PSC80 x SAFU20 - 100	148	100	33	35	PSC80 x SAF25	UT20 - 50	ER20	2.52
144.783.25U.120	PSC80 x SAFU25 - 120	168	120	38.9	42	PSC80 x SAF40	UT25 - 60	ER25	3.71
144.783.32U.120	PSC80 x SAFU32 - 120	168	120	40.9	48	PSC80 x SAF40	UT32 - 60	ER32	3.74

Features:

- ▶ Flange adapter: UT.
- ▶ Drive axial and radial set screws for precision adjustment and the runout accuracy of the tool edge can be adjusted within 5 μm.



Standard Accessory: • NUT

Collet	Nut	Preset Screw	Spanner
P.W-6~9	P.W-41	P.W-82	P.W-62~67

SAF RUNOUT ADJUSTABLE HOLDER BODY

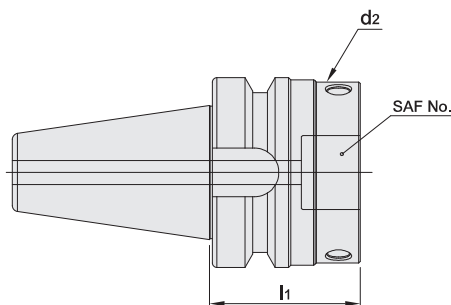
SAF 可調式刀桿本體

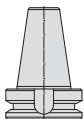

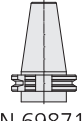
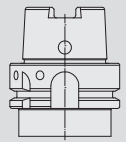
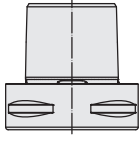
SHANK	MODEL NO.	TYPE	l ₁	d ₂	SAF NO.	WEIGHT (KGS)
 MAS 403	10.783.25	BT30 x SAF25	40	60	1	0.61
	11.783.25	BT40 x SAF25	50	60	1	1.34
	11.783.40	BT40 x SAF40	50	80	2	1.48
	12.783.25	BT50 x SAF25	60	60	1	3.82
	12.783.40	BT50 x SAF40	60	80	2	4.07
 ANSI B5.50	31.783.25	CAT40 x SAF25	50	60	1	1.19
	31.783.40	CAT40 x SAF40	60	80	2	1.71
	32.783.25	CAT50 x SAF25	60	60	1	3.46
	32.783.40	CAT50 x SAF40	60	80	2	3.77
 DIN 69871-A	51.783.25	DAT40 x SAF25	50	60	1	1.22
	51.783.40	DAT40 x SAF40	60	80	2	1.73
	52.783.25	DAT50 x SAF25	60	60	1	3.36
	52.783.40	DAT50 x SAF40	60	80	2	3.92
 DIN 69893 A	71.783.25	HSK40A x SAF25	60	60	1	0.70
	72.783.25	HSK50A x SAF25	60	60	1	0.82
	73.783.25	HSK63A x SAF25	60	60	1	1.16
	73.783.40	HSK63A x SAF40	60	80	2	1.36
	74.783.25	HSK80A x SAF25	50	60	1	1.47
	74.783.40	HSK80A x SAF40	60	80	2	1.95
	75.783.25	HSK100A x SAF25	55	60	1	2.41
	75.783.40	HSK100A x SAF40	55	80	2	2.73
 ISO 26623-1	141.783.25	PSC40 x SAF25	55	60	1	0.76
	142.783.25	PSC50 x SAF25	60	60	1	1.10
	143.783.25	PSC63 x SAF25	60	60	1	1.45
	143.783.40	PSC63 x SAF40	60	80	2	1.82
	144.783.25	PSC80 x SAF25	50	60	1	2.03
	144.783.40	PSC80 x SAF40	60	80	2	2.62

SAF RUNOUT ADJUSTABLE HOLDER BODY

SAF 可調式刀桿本體

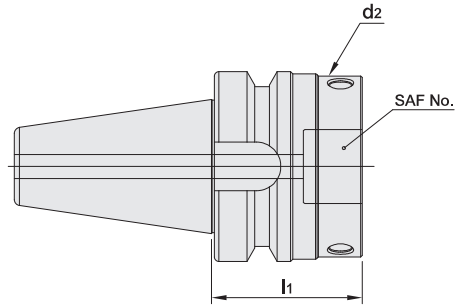

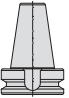
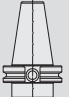
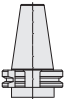
SHANK	MODEL NO.	TYPE	l_1	d_2	SAF NO.	WEIGHT (KGS)
 DualDRIVE+	25.783.25	SBT30 x SAF25	40	60	1	0.61
	26.783.25	SBT40 x SAF25	50	60	1	1.35
	26.783.40	SBT40 x SAF40	50	80	2	1.49
	27.783.25	SBT50 x SAF25	60	60	1	3.86
	27.783.40	SBT50 x SAF40	60	80	2	4.11
 DualDRIVE+	43.783.25	SCAT40 x SAF25	50	60	1	1.22
	43.783.40	SCAT40 x SAF40	60	80	2	1.73
	44.783.25	SCAT50 x SAF25	60	60	1	3.50
	44.783.40	SCAT50 x SAF40	60	80	2	3.81
 DualDRIVE+	66.783.25	SDAT40 x SAF25	50	60	1	1.24
	66.783.40	SDAT40 x SAF40	60	80	2	1.75
	67.783.25	SDAT50 x SAF25	60	60	1	3.40
	67.783.40	SDAT50 x SAF40	60	80	2	3.96

SHRINK FIT CHUCK FLANGE FOR SAF

SAF 可調式刀桿法蘭盤 - SFC

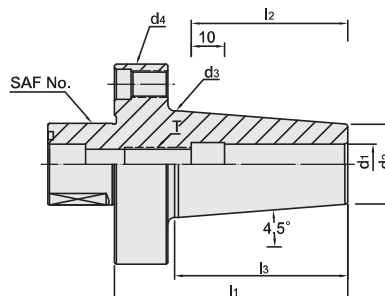

MODEL NO.	TYPE	l_1	l_2	l_3	d_1	d_2	d_3	d_4	T	SAF NO.	WEIGHT (KGS)
783.651.06.070	SFC6 - 70	70	36	52	6	21	27	60	M5 x 0.8P	1	0.52
783.651.08.070	SFC8 - 70	70	36	52	8	21	27	60	M6 x 1.0P	1	0.51
783.651.10.070	SFC10 - 70	70	42	52	10	24	32	60	M8 x 1.25P	1	0.56
783.651.12.070	SFC12 - 70	70	47	52	12	24	32	60	M10 x 1.5P	1	0.54
783.651.16.075	SFC16 - 75	75	50	57	16	27	34	60	M12 x 1.75P	1	0.59
783.651.20.080	SFC20 - 80	80	52	60	20	33	42	80	M16 x 2.0P	2	1.19
783.651.25.100	SFC25 - 100	100	58	81	25	44	52	80	M20 x 2.0P	2	1.72
783.651.32.100	SFC32 - 100	100	58	81	32	44	52	80	M20 x 2.0P	2	1.58

SK3 COLLET CHUCK FLANGE FOR SAF

SAF 可調式刀桿法蘭盤 - SK3

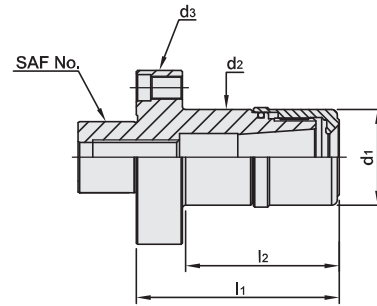

MODEL NO.	TYPE	l_1	l_2	d_1	d_2	d_3	SAF NO.	WEIGHT (KGS)
783.763.06.050	SK306 - 50	50	29	19.5	19.5	60	1	0.39
783.763.06.100	SK306 - 100	100	79	19.5	19.5	60	1	0.48
783.763.10.050	SK310 - 50	50	32.5	27.5	27.5	60	1	0.42
783.763.10.100	SK310 - 100	100	82.5	27.5	27.5	60	1	0.61
783.763.13.070	SK313 - 70	70	53	33	33	60	1	0.55
783.763.13.100	SK313 - 100	100	83	33	33	60	1	0.73
783.763.16.070	SK316 - 70	70	49.9	40	40	80	2	1.08
783.763.16.100	SK316 - 100	100	79.9	40	40	80	2	1.34

Standard Accessory: • NUT

Collet	Nut	Spanner
		
P.W-25~28	P.W-46	P.W-62~67

PNER COLLET CHUCK FLANGE FOR SAF

SAF 可調式刀桿法蘭盤 - PNER



T W PAT NO. M298033
 T W PAT NO. M311791
 T W PAT NO. M501316
 J P PAT NO. 3128766
 J P PAT NO. 3200356
 K R PAT NO. 20-0433603
 C N PAT NO. ZL200620132661.0
 C H PAT NO. 696550
 T R PAT NO. TR 2007 02942 Y
 I T PAT NO. N.0000266731
 D E PAT NO. Nr.202015005621

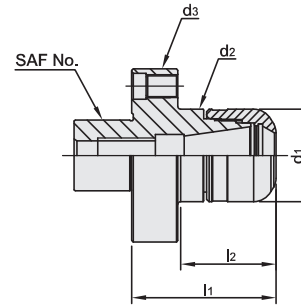

MODEL NO.	TYPE	l_1	l_2	d_1	d_2	d_3	SAF NO.	WEIGHT (KGS)
783.273.16.050	PNER16 - 50	50	32	30	30	60	1	0.42
783.273.16.100	PNER16 - 100	100	82	30	30	60	1	0.66
783.273.20.050	PNER20 - 50	50	33	32	32	60	1	0.43
783.273.20.100	PNER20 - 100	100	83	32	32	60	1	0.69
783.273.25.050	PNER25 - 50	50	28.94	40	40	80	2	0.93
783.273.25.100	PNER25 - 100	100	78.9	40	40	80	2	1.35
783.273.32.060	PNER32 - 60	60	40.94	50	50	80	2	1.08
783.273.32.100	PNER32 - 100	100	80.94	50	50	80	2	1.63

Standard Accessory: • NUT

Collet	Nut	Spanner
		
P.W-4	P.W-39	P.W-62~67



UT COLLET CHUCK FLANGE FOR SAF

SAF 可調式刀桿法蘭盤 - UT



T W PAT NO. M298033
 T W PAT NO. M311791
 J P PAT NO. 3128766
 J P PAT NO. 3200356
 K R PAT NO. 20-0433603
 C N PAT NO. ZL200620132661.0
 C H PAT NO. 696550
 T R PAT NO. TR 2007 02942 Y
 I T PAT NO. N.0000266731

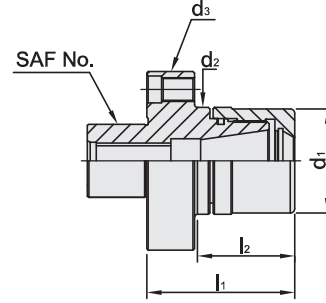

MODEL NO.	TYPE	l_1	l_2	d_1	d_2	d_3	SAF NO.	WEIGHT (KGS)
783.753.16.050	UT16 - 50	50	32	30	30	60	1	0.47
783.753.20.050	UT20 - 50	50	33	35	36	60	1	0.49
783.753.25.060	UT25 - 60	60	38.9	42	42	80	2	1.09
783.753.32.060	UT32 - 60	60	40.9	48	48	80	2	1.12

Standard Accessory: • NUT

Collet	Nut	Spanner
		
P.W-6~9	P.W-41	P.W-62~67